



*Jergens*  
**BALL LOCK<sup>®</sup>**  
MOUNTING SYSTEM

**PRE-ENGINEERED BALL LOCK<sup>®</sup> MOUNTING SYSTEMS  
FOR MAZAK MACHINES**



**Mazak**

VCN-410A  
VCN-410B  
VCN-510C  
FJV200  
FJV-250

**METRIC**

*Jergens*<sup>®</sup>



# Table of Contents

<b>Ball Lock® Selection Guide How TO</b> .....	3
<b>Ball Lock® Mounting Systems Components</b> .....	4
<b>Fixture Plates</b> .....	5 - 6
<b>Ball Lock® Base Vises</b> .....	7
<b>Mazak Models</b> .....	8 - 60
Nexus 410A.....	8 - 13
Nexus 410B.....	14 - 24
Nexus 510C.....	25 - 40
FJV - 200.....	41 - 46
FJV - 250.....	47 - 58
<b>Subplate &amp; Mounting Hardware Order Form</b> .....	59 - 60



## Ball-Lock® Selection Guide

### How to Use This Guide

1. Review the “How the Ball-Lock Mounting System works” section for an overview of the system and components.
2. Select a specific Machine tool model and subplate.
  - a. The opening machine model page includes the machine table specifications used for that machine.
  - b. The following page/pages contain specific subplates designed for that machine model and table specifications.
  - c. Each subplate page lists the color coded fixture plate that will fit the subplate. Each machine may have one or more subplate/fixture plate combinations.
  - d. Use the “fixture plate examples” contained in the guide to help select a fixture plate for typical applications. Fixture plates are color coded to assist in using the example when selecting it for a specific machine.
3. Use the “Subplate and Quote Form” to assist in selecting the required subplate mounting components.
  - a. This form lists the required mounting hardware for each subplate you select.
  - b. You can fill in the number of subplates into the form for reference.
  - c. The mounting hardware listed is for one subplate. When requesting a quote or ordering more than one subplate, the total components required must be increased accordingly.
4. Use the “Fixture Plate and Vise Quote Form” to assist in selecting the required fixture plates and Ball lock shanks required for mounting.
  - a. This form lists the ball lock shanks, part number and quantity required for each fixture plate selected.

As always, please do not hesitate to contact Jergens Workholding Solutions for engineering assistance.



Multi-Axis Catalog



Ball Lock® Brochure



Workholding Solutions  
Catalog



## How the BALL-LOCK® Mounting System works.

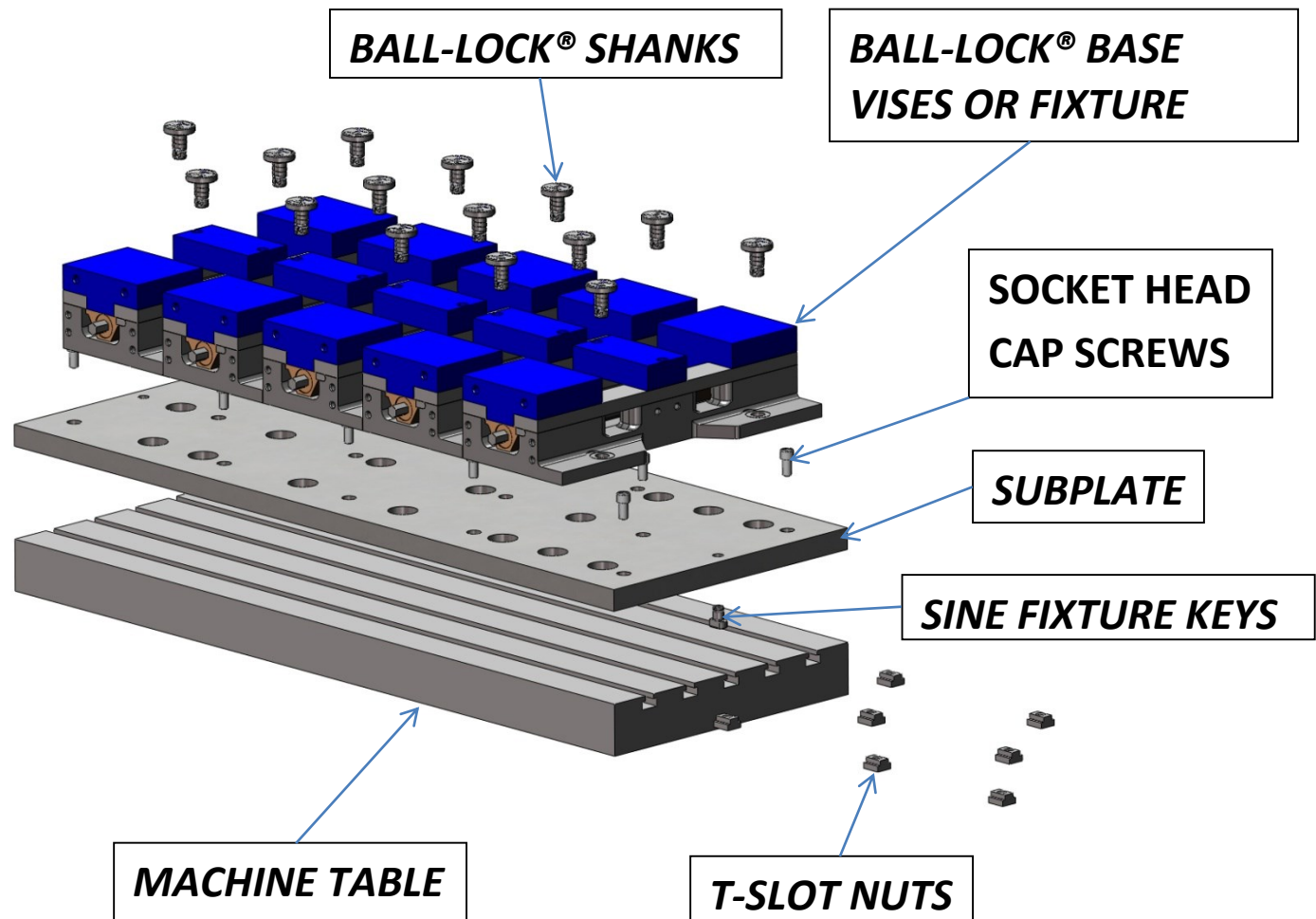

**MACHINE TABLES** - come in various sizes, t-slot sizes, number of t-slots and also drilled & tapped configurations.

**SUBPLATES** - can be made to suit your needs in addressing your manufacturing quick-change requirements.

**SINE FIXTURE KEYS** - are used to align the subplate to a t-slotted table during the installation of the subplate to your machine table.

**T-SLOT NUTS** - are used in the fastening of the subplate to the machine table.

**SOCKET HEAD SCREW'S** - are installed thru the subplate and into the t-slot nuts to lock down the subplate to the machine table.

**BALL-LOCK® BASE VISES OR FIXTURE PLATES** - allow you to change out your vises or fixture in minutes within +/- 0.3 repeatability versus hours of set-up and indicating in the vise or fixture.

**BALL-LOCK® SHANKS** - are used to locate and lock the vises or fixtures to the receiver bushings installed in the subplate with 2-1/2 turns to lock or release with low torque and high clamping forces.



## FIXTURE PLATES

Shown below are color coded Fixture Plates to assist in determining the various subplate options to best suit your manufacturing quick change requirements.

<p>58711(ALUM) / Steel Available upon request</p>			
<p>58713(ALUM)/ 58813(STEEL)</p>			
<p>58715(ALUM)/ 58815(STEEL)</p>			
<p>58801(STEEL)</p>			
<p>58719(ALUM) / Steel Available upon request</p>			



## FIXTURE PLATES

Shown below are color coded to assist in determining the various sub-plate options to best suit your manufacturing quick change requirements.

<p>58727(ALUM) / 58827(STEEL)</p>			
<p>Aluminum Available upon request / 58845(STEEL)</p>			
<p>58706(ALUM)/ 58806(STEEL)</p>			



**BALL-LOCK® BASE VISES** - shown below are color coded Vises to assist in determining the various subplate options to best suit your manufacturing quick change requirements.

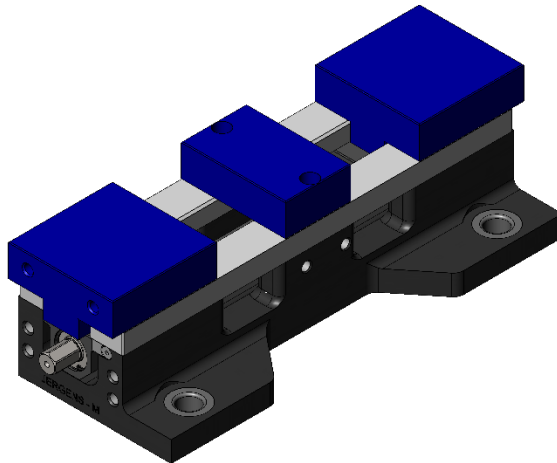

69405 (100MM VISE BALL-LOCK® BASE)

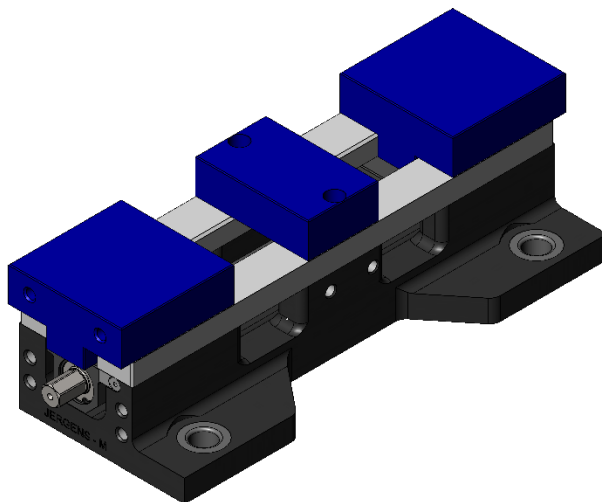

69406 (152MM VISE BALL-LOCK® BASE)



# NEXUS 410A

Mazak NEXUS 410A



## Table Specifications

- Table Travel (X, Y, Z): 560 x 410 x 510mm
- Table Dimensions (L x W): 900 X 430mm
- Maximum Weight on Table: 500 Kgf
- T-Slot Width: .709" (18 mm)
- T-Slot Center Distance: 4.921" (125mm)

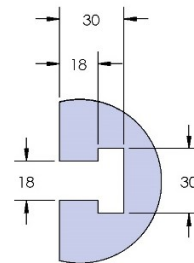
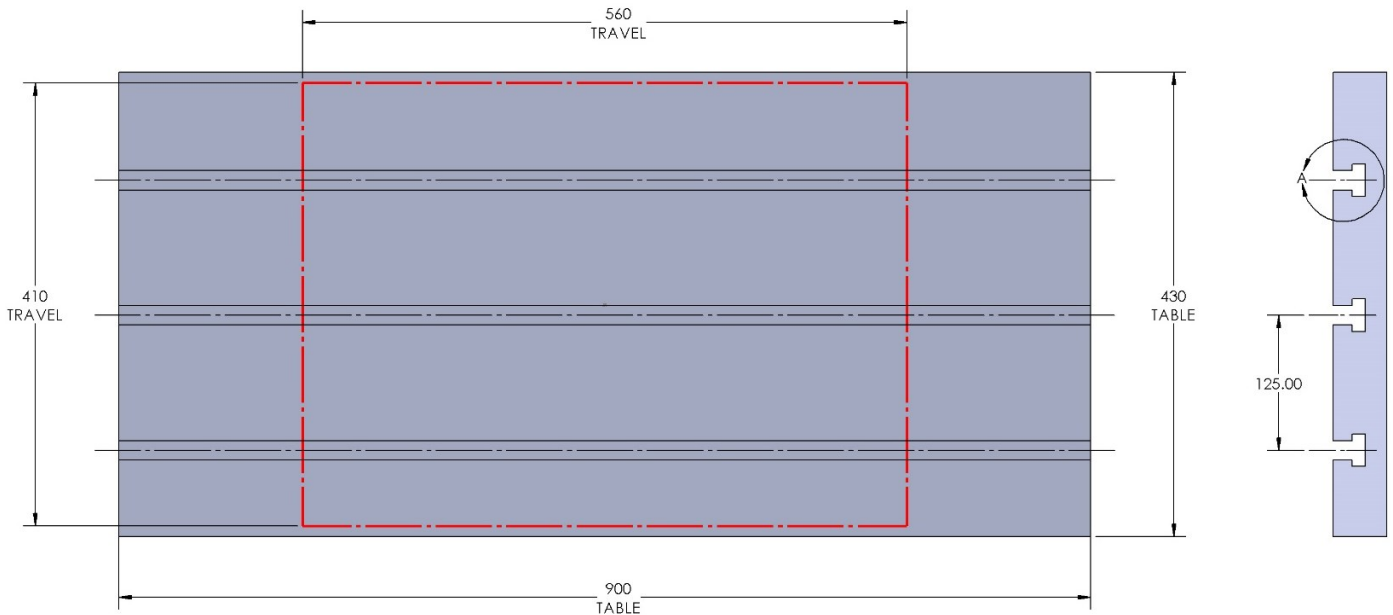

T-SLOT  
DETAIL  
A



# VCN410A-001M

Mazak NEXUS 410A

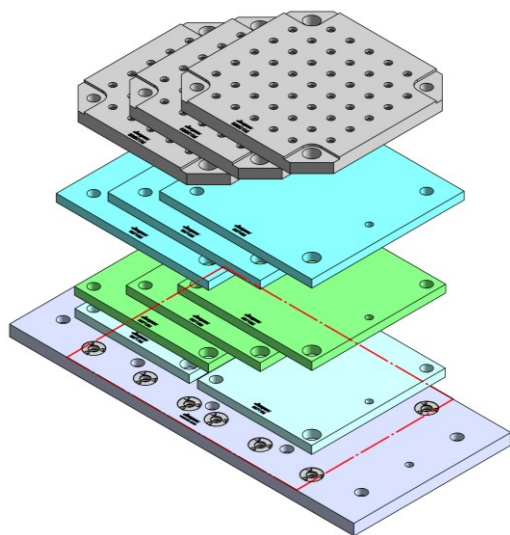

900 X 430 X 28 MM

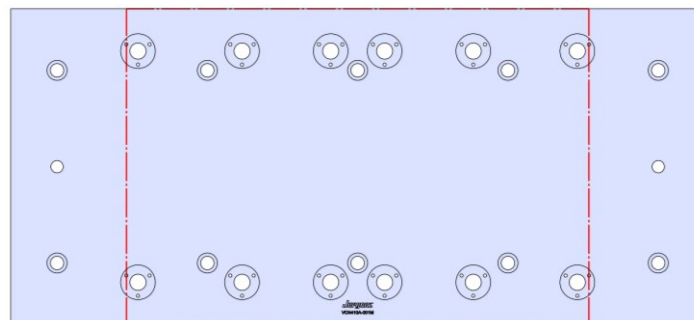

## VCN410A-001M

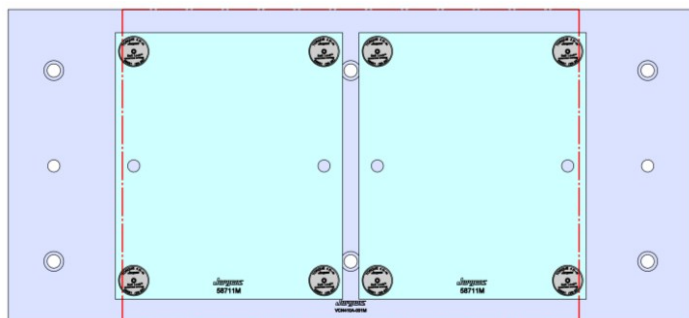

58711 Aluminum

Steel Available upon request

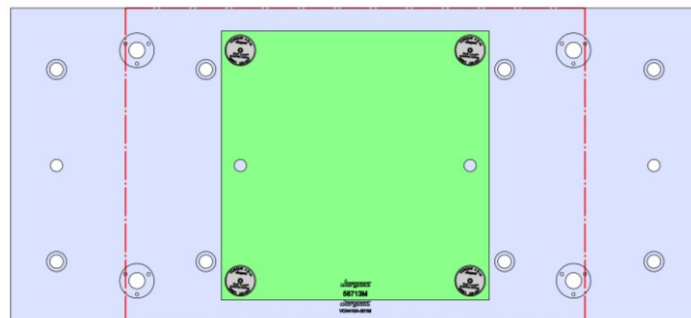

58713 Aluminum

58813 Steel

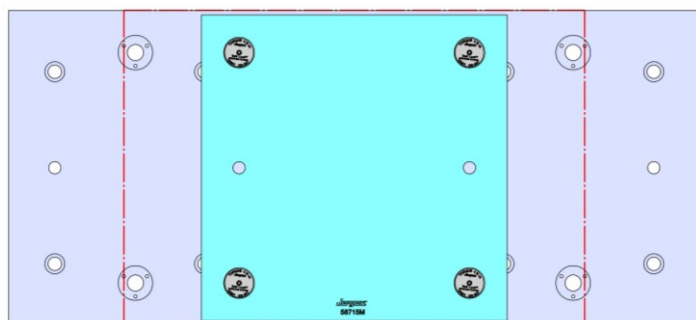

58715 Aluminum

58815 Steel

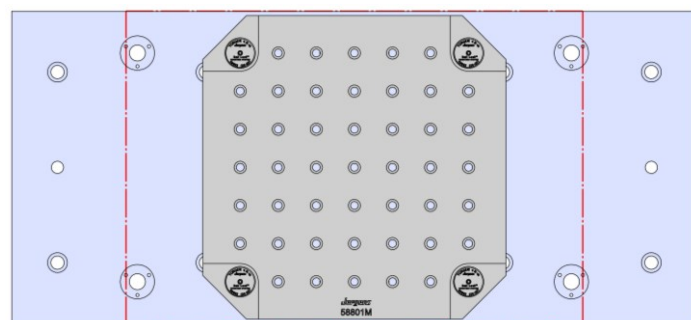

58801 Steel



VCN410A-002M

Mazak NEXUS 410A

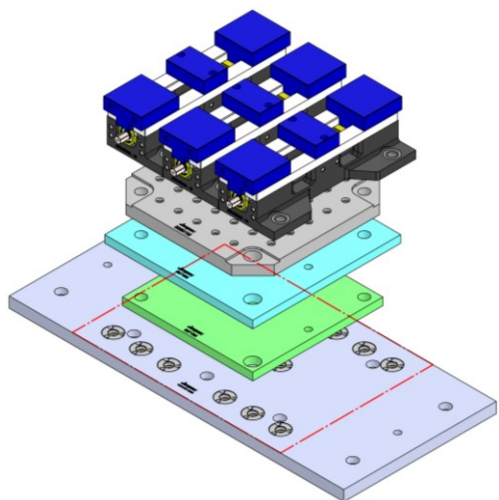

900 X 430 X 28 MM

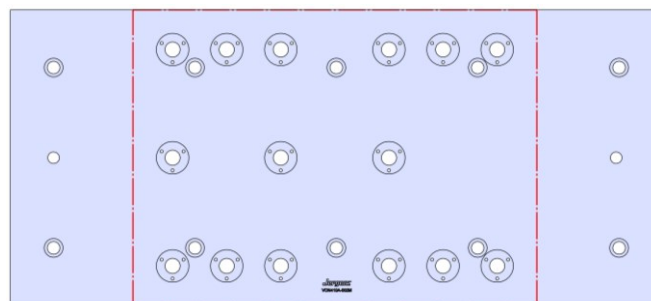

VCN410A-002M

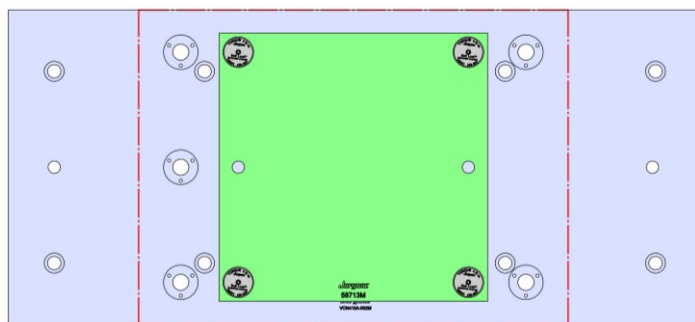

58713 Aluminum

58813 Steel

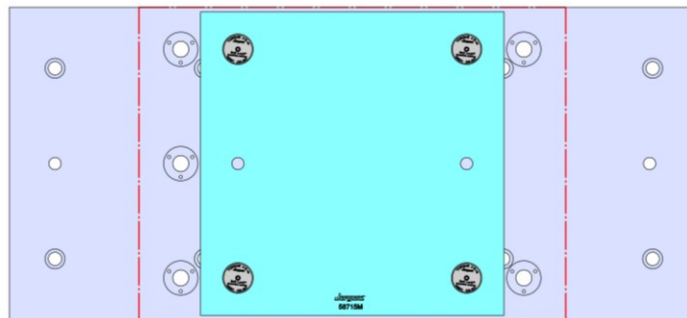

58715 Aluminum

58815 Steel

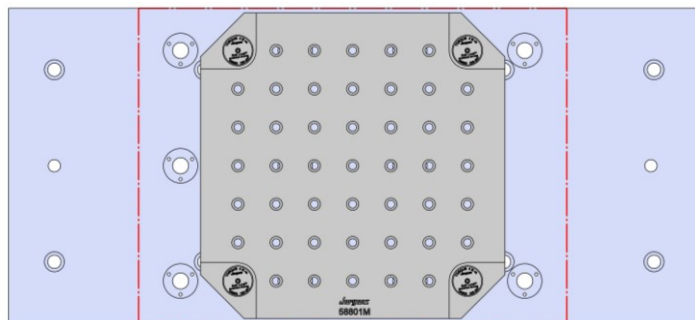

58801 Steel

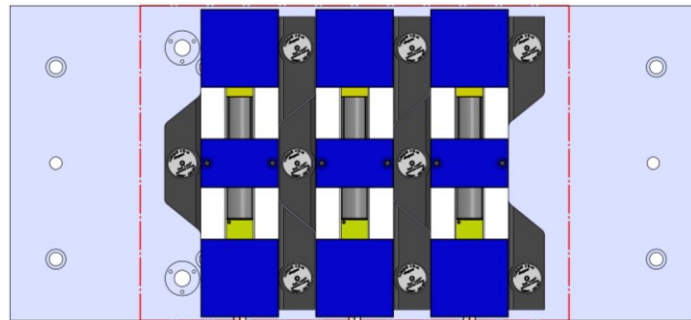

69405 100MM Vise Ball-Lock® Base



VCN410A-003M

Mazak NEXUS 410A

900 X 430 X 28 MM

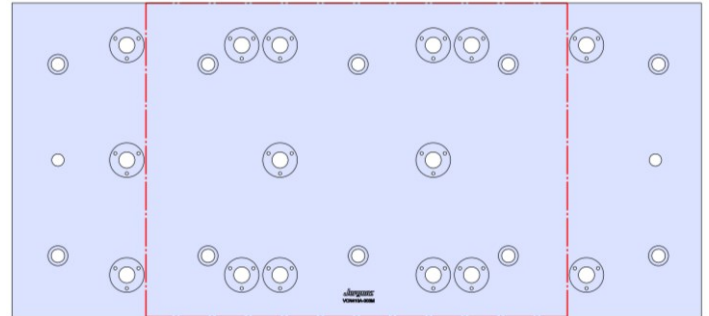
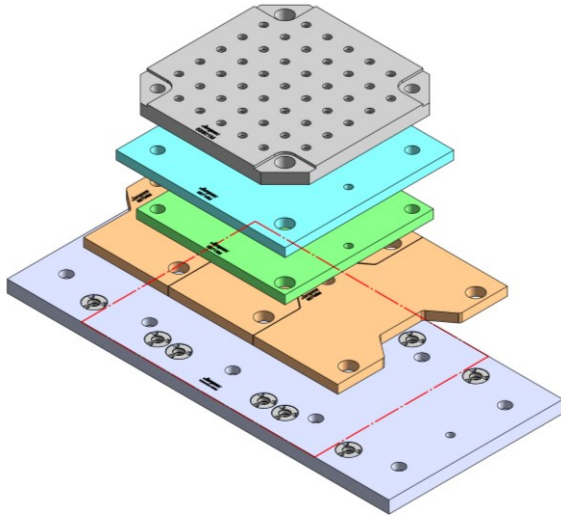

VCN410A-003M

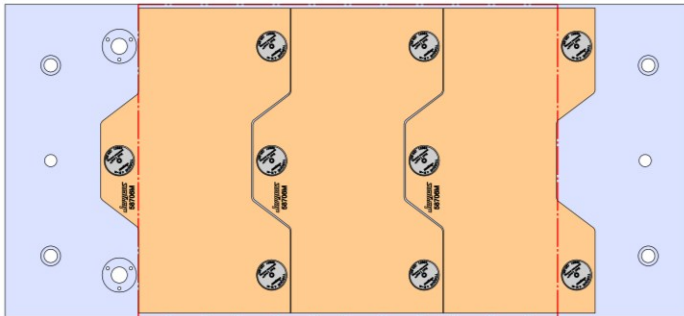

58706 Aluminum

58806 Steel

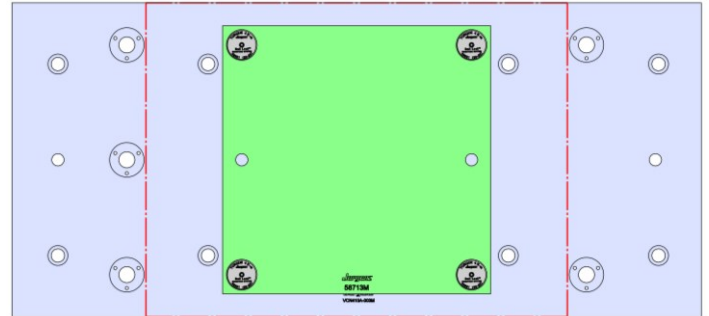

58713 Aluminum

58813 Steel

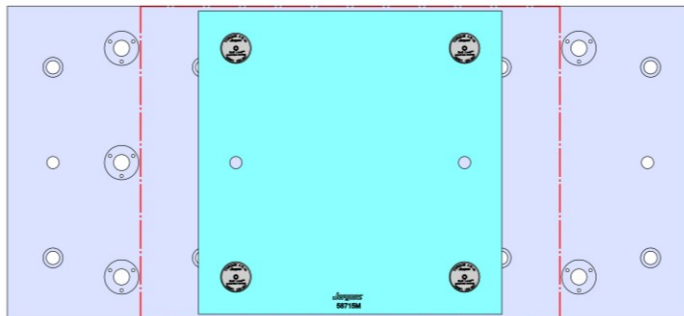

58715 Aluminum

58815 Steel

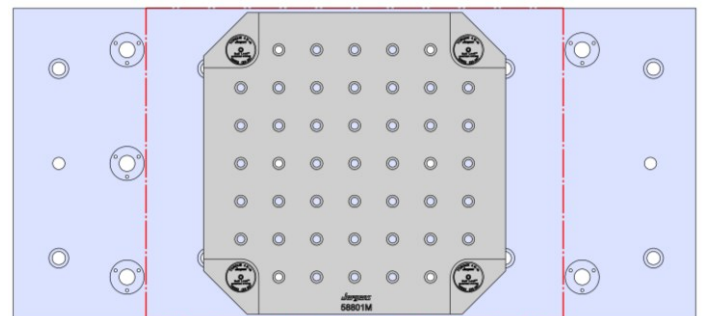

58801 Steel



# VCN410A-004M

Mazak NEXUS 410A

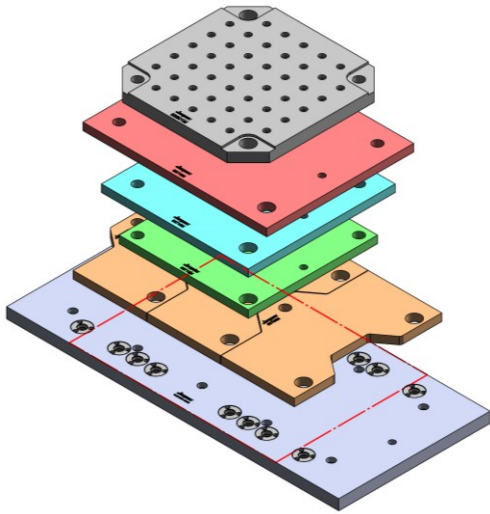

900 X 430 X 28 MM

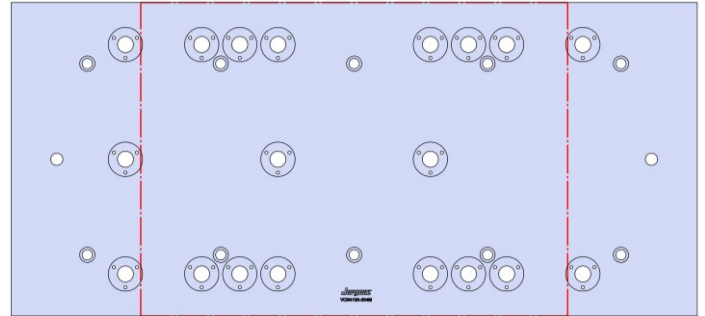

## VCN410A-004M

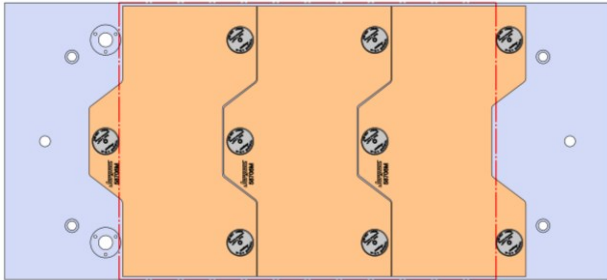

58706 Aluminum

58806 Steel

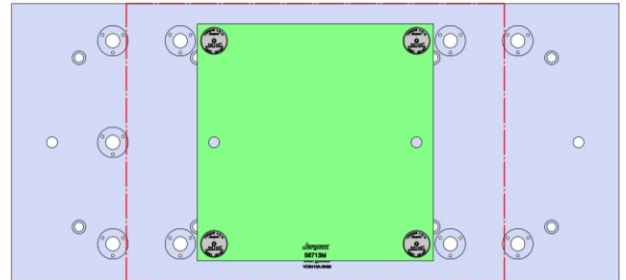

58713 Aluminum

58813 Steel

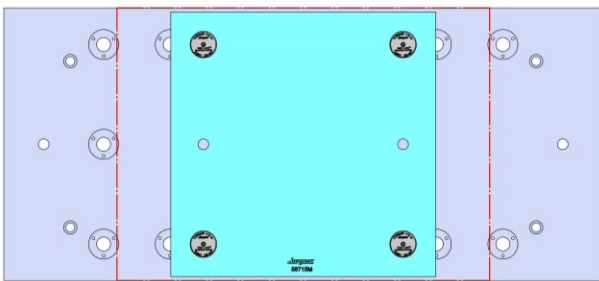

58715 Aluminum

58815 Steel

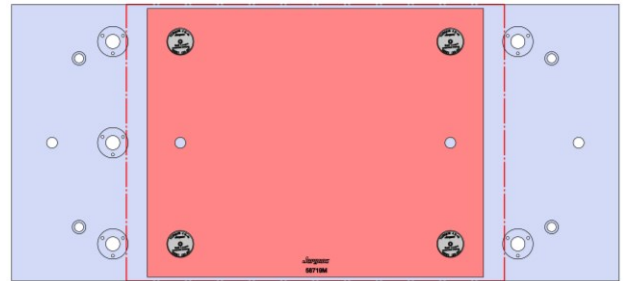

58719 Aluminum

Steel Available upon request

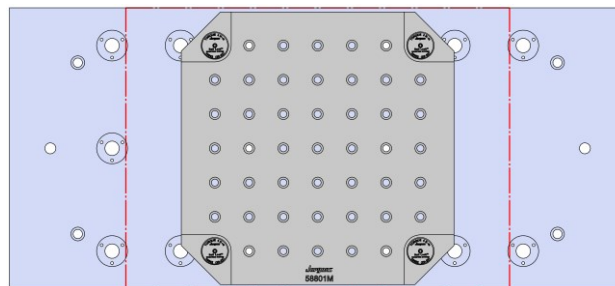

58801 Steel



# VCN410A-005M

900 X 430 X 28 MM

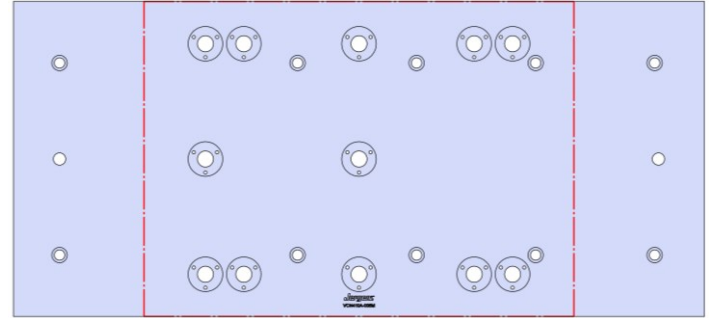
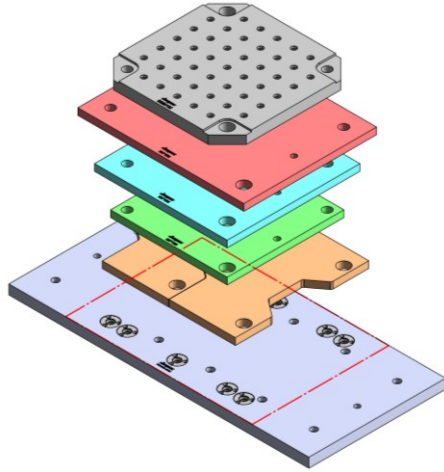

## VCN410A-005M

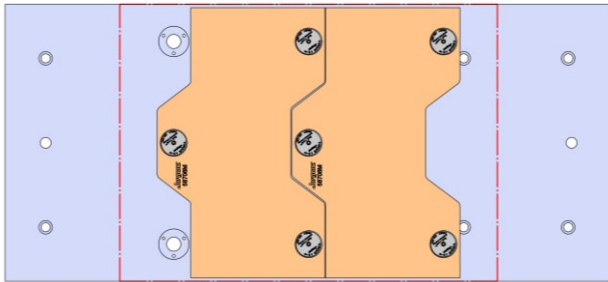

58706 Aluminum

58806 Steel

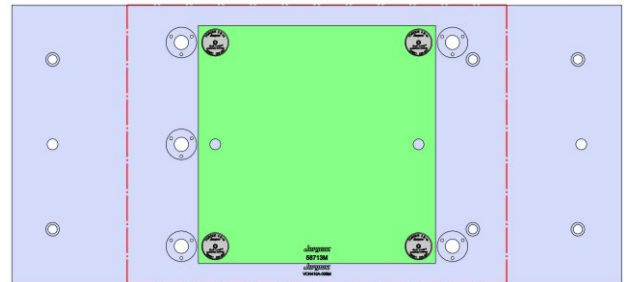

58713 Aluminum

58813 Steel

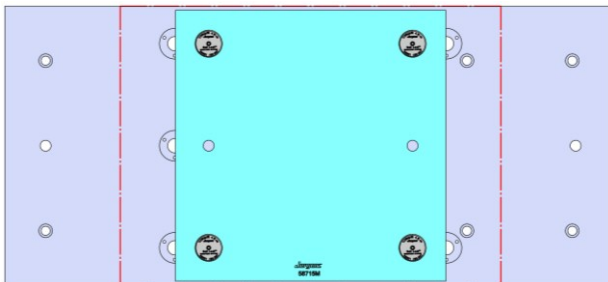

58715 Aluminum

58815 Steel

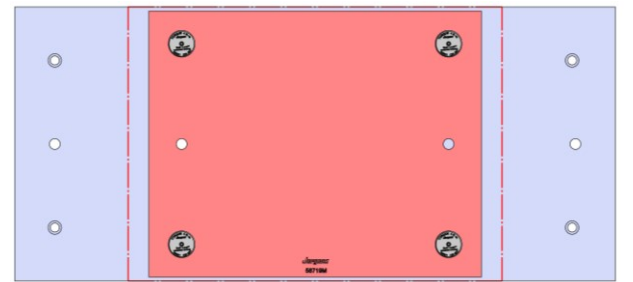

58719 Aluminum

Steel Available upon request

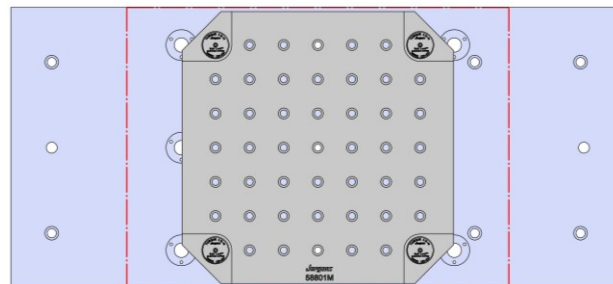

58801 Steel



# NEXUS 410B



- Table Specifications**
- Table Travel (X, Y, Z): 762 X 410 X 510mm
  - Table Dimensions (L x W): 1100 X 410mm
  - Maximum Weight on Table: 700 Kgf
  - T-Slot Width: .709" (18mm)
  - T-Slot Center Distance: 4.921" (125mm)

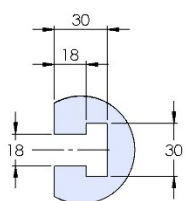
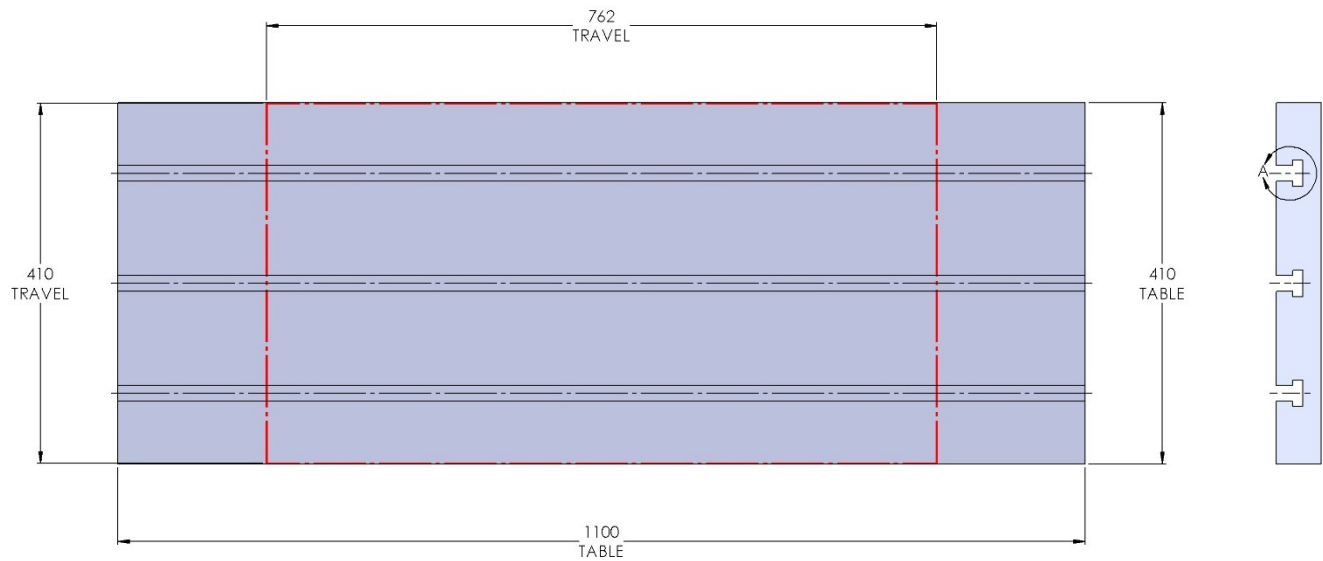

T-SLOT DETAIL A



# VCN410B-001M

**Mazak** NEXUS 410B

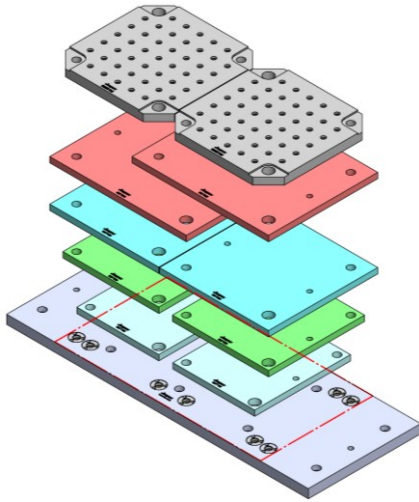

1100 X 430 X 28 MM

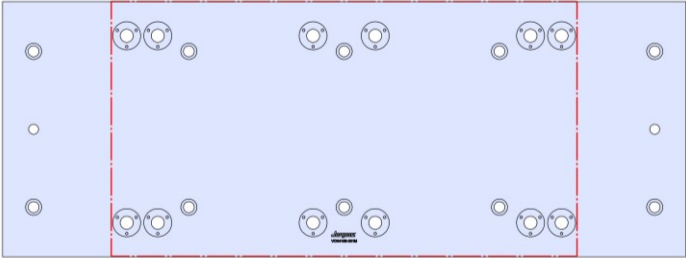

## VCN410B-001M

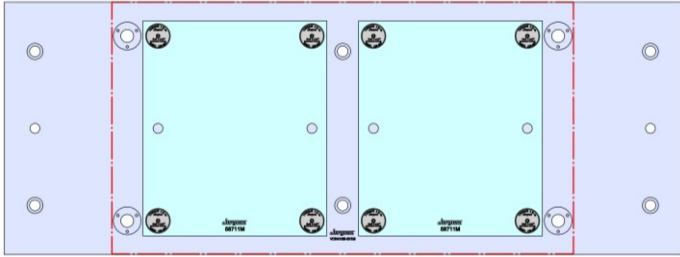

58711 Aluminum

Steel Available upon request

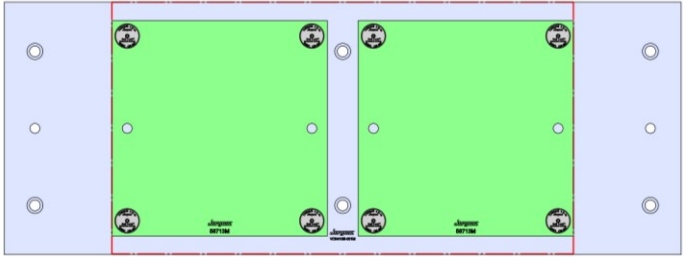

58713 Aluminum

58813 Steel

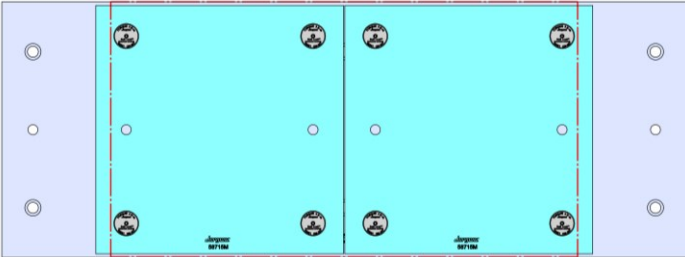

58715 Aluminum

58815 Steel

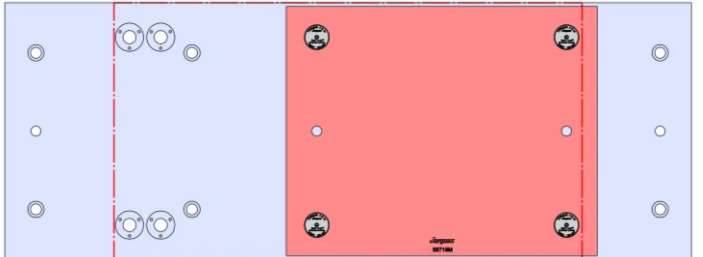

58719 Aluminum

Steel Available upon request

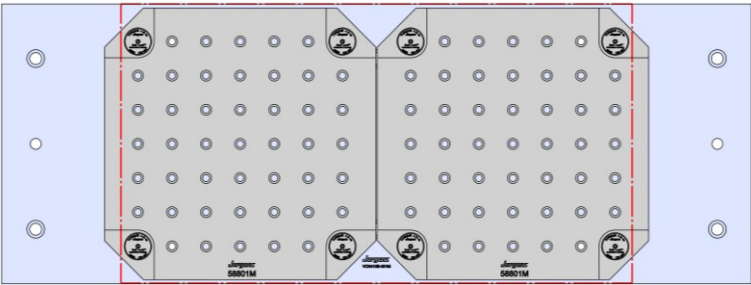

58801 Steel



# VCN410B-002M

**Mazak** NEXUS 410B

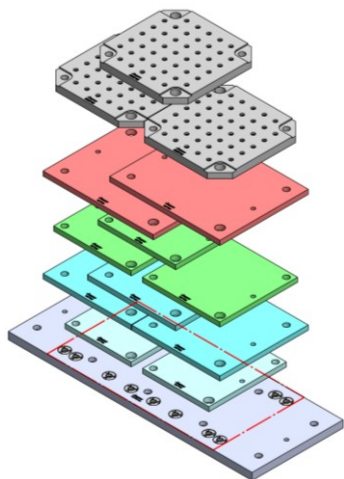

1100 X 430 X 28 MM

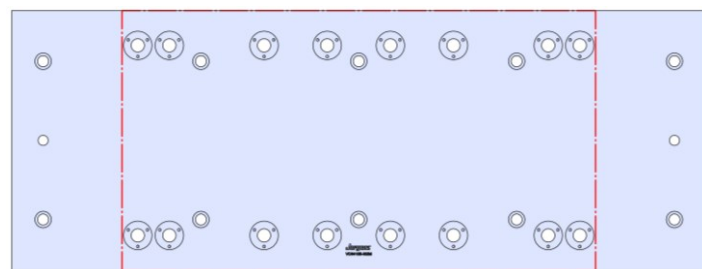

## VCN410B-002M

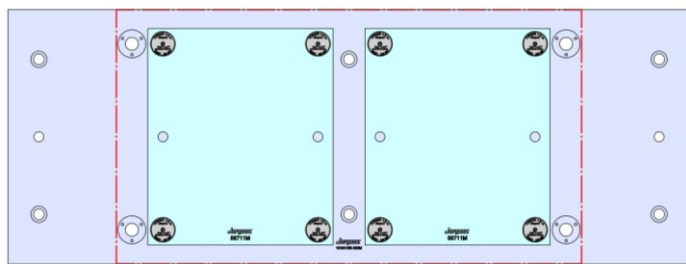

58711 Aluminum      Steel Available upon request

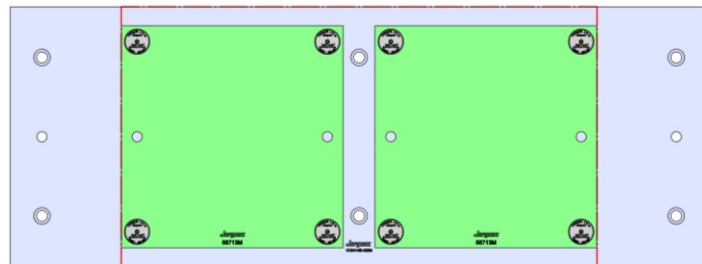

58713 Aluminum      58813 Steel

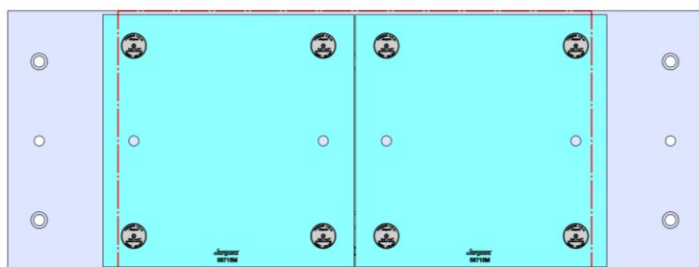

58715 Aluminum      58815 Steel

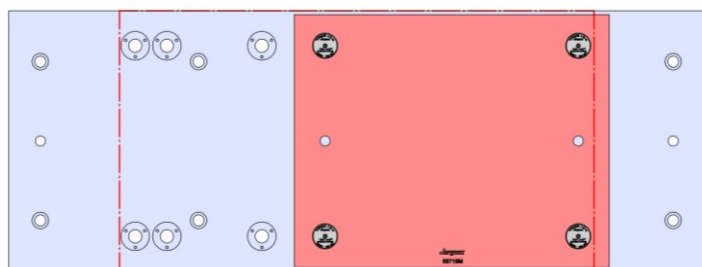

58719 Aluminum      Steel Available upon request

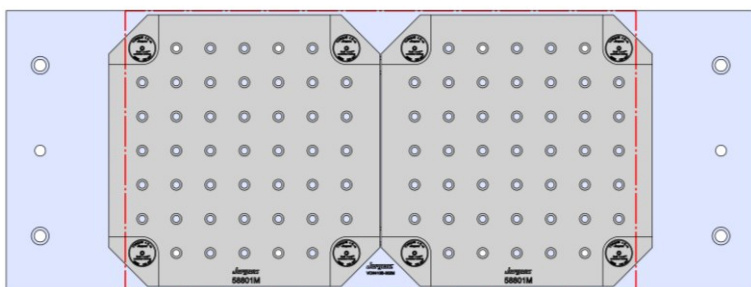

58801 Steel



# VCN410B-003M

Mazak NEXUS 410B

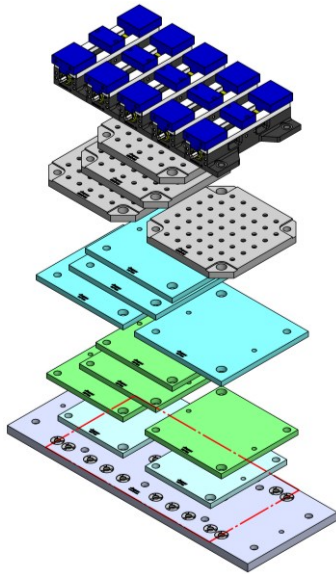

1100 X 430 X 28 MM

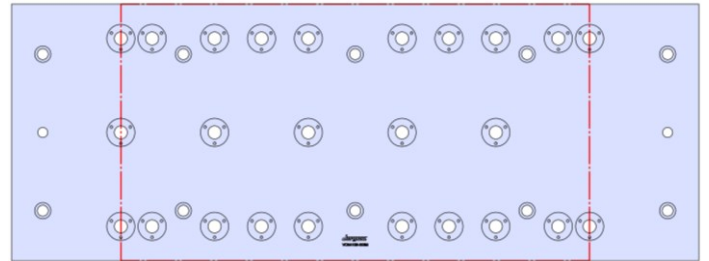

## VCN410B-003M

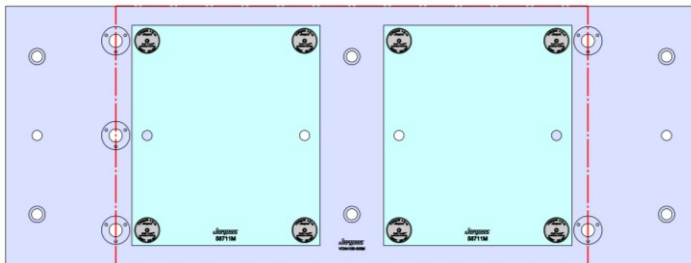

58711 Aluminum

Steel Available upon request

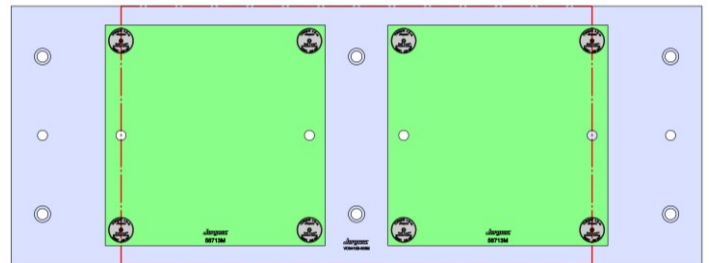

58713 Aluminum

58813 Steel

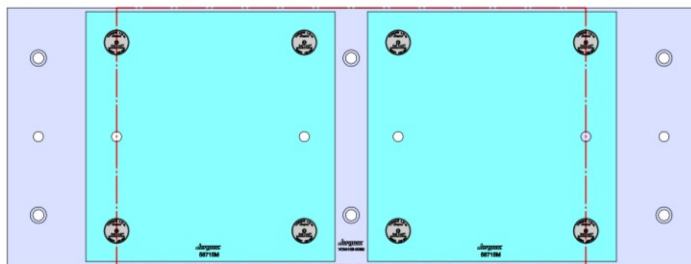

58715 Aluminum

58815 Steel

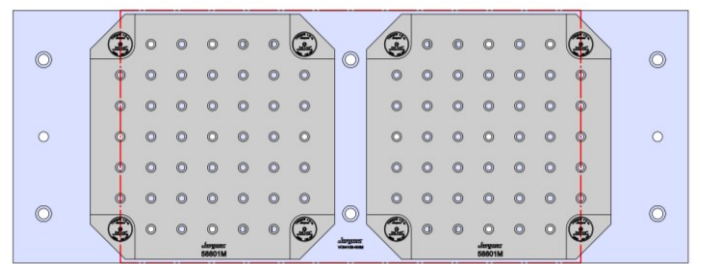

58801 Steel

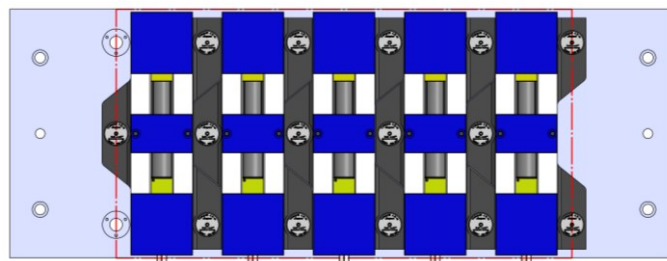

69405 100MM Vise Ball-Lock® Base



# VCN410B-004M

Mazak NEXUS 410B

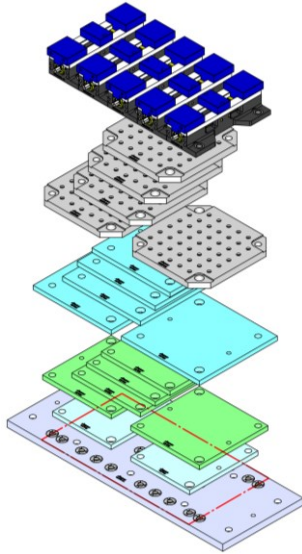

1100 X 430 X 28 MM

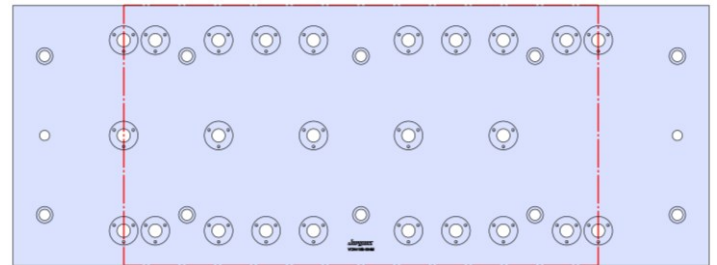

## VCN410B-004M

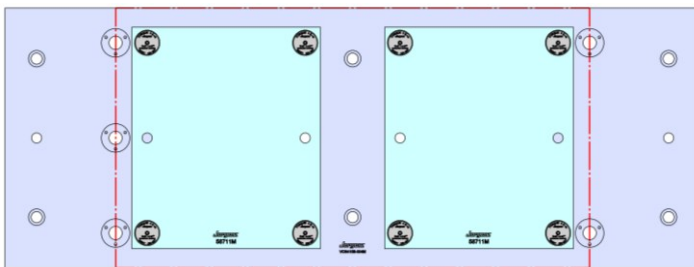

58711 Aluminum

Steel Available upon request

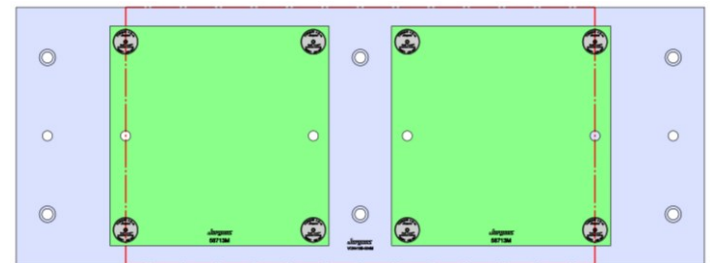

58813 Aluminum

58813 Steel

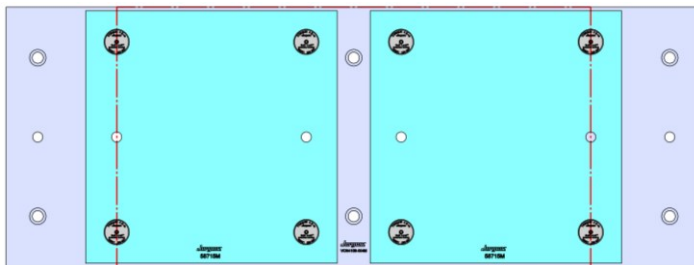

58715 Aluminum

58815 Steel

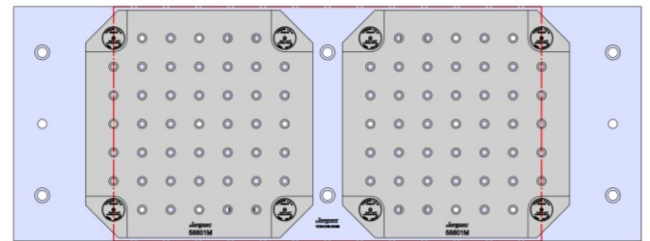

58801 Steel

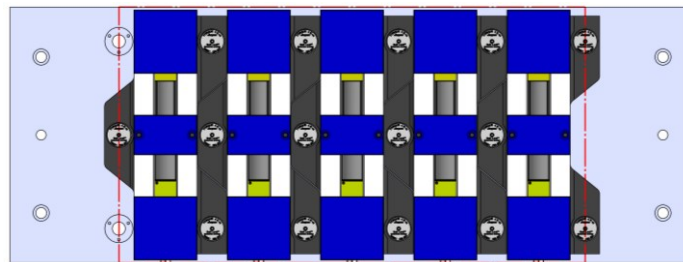

69405 100MM Vise Ball-Lock® Base



VCN410B-005M

Mazak NEXUS 410B

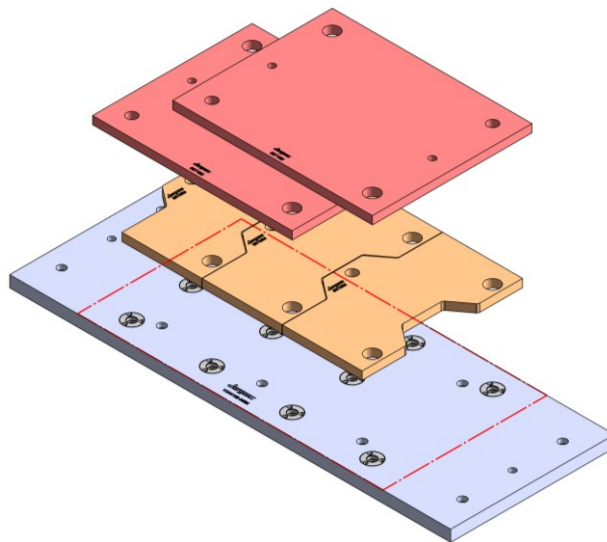

1100 X 430 X 28 MM

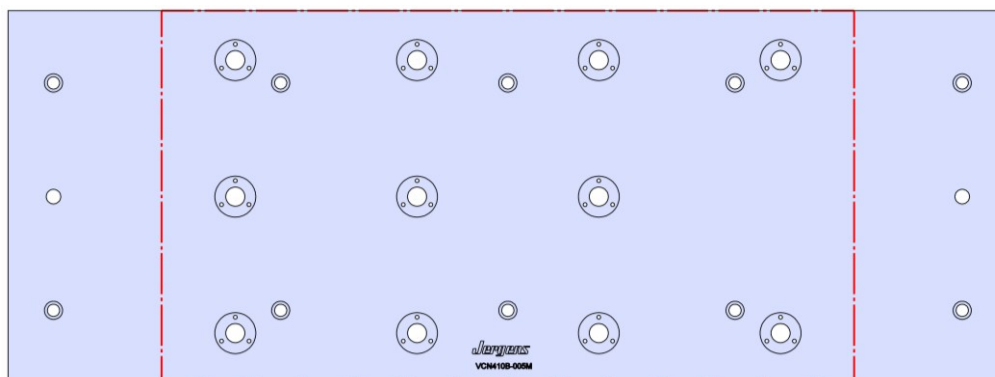

VCN410B-005M

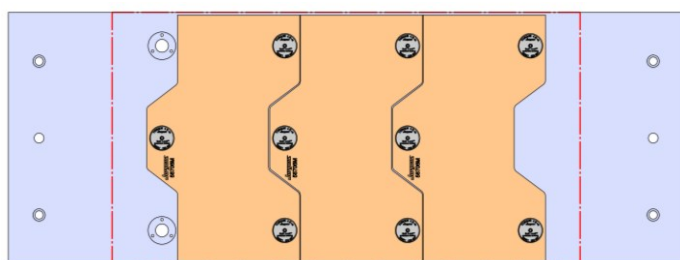

58706 Aluminum

58806 Steel

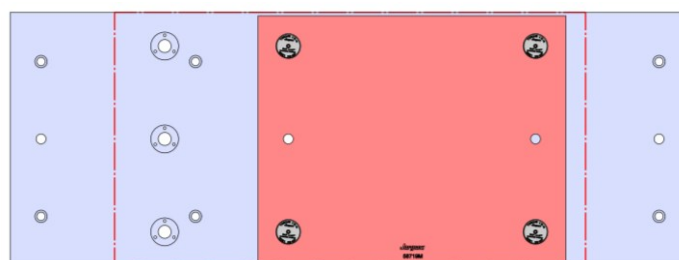

58719 Aluminum

Steel Available upon request



# VCN410B-006M

Mazak NEXUS 410B

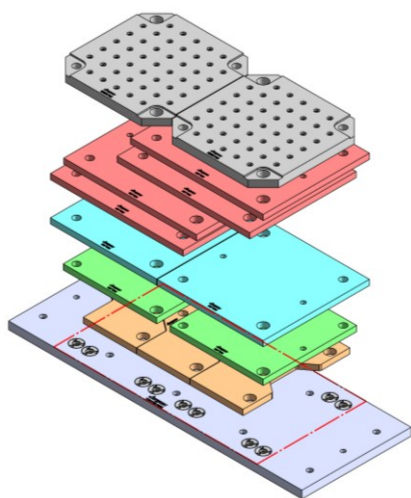

1100 X 430 X 28 MM

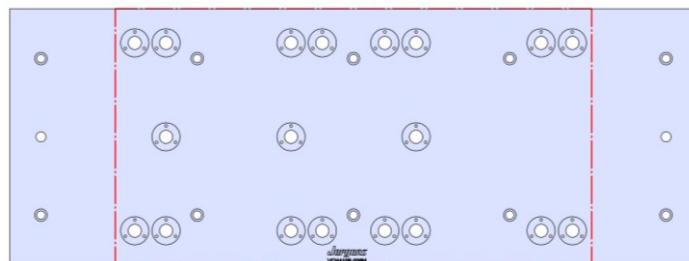

## VCN410B-006M

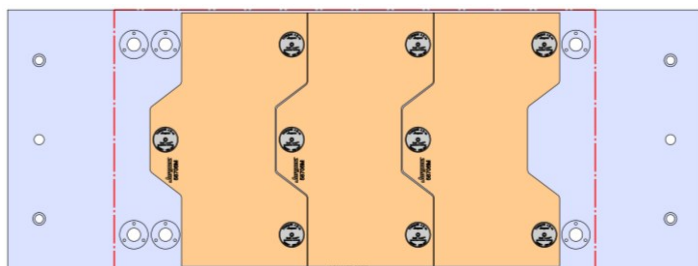

58706 Aluminum

58806 Steel

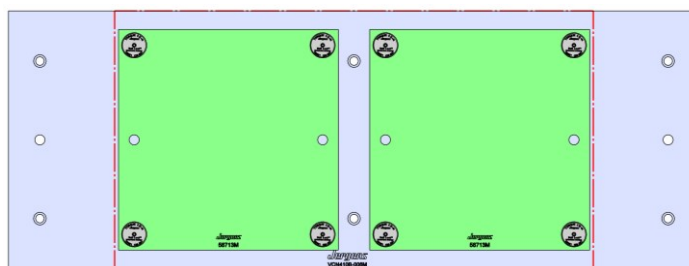

58713 Aluminum

58813 Steel

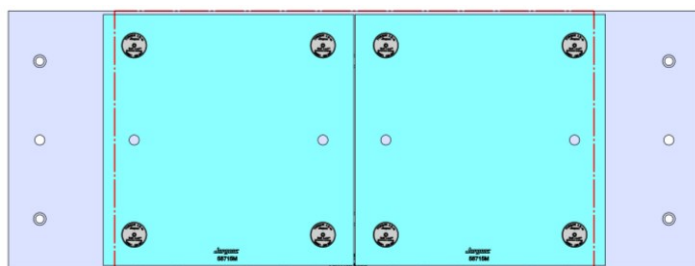

58715 Aluminum

58815 Steel

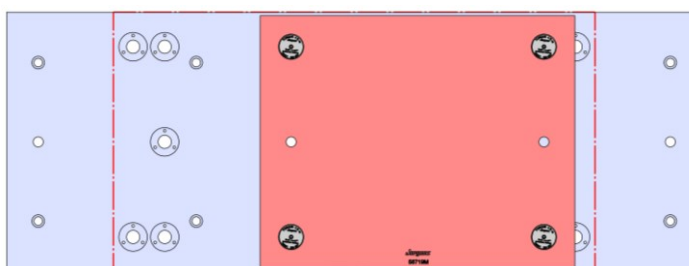

58719 Aluminum

Steel Available upon request

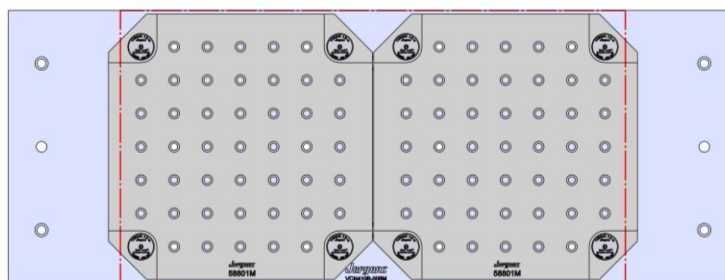

58801 Steel



# VCN410B-007M

Mazak NEXUS 410B

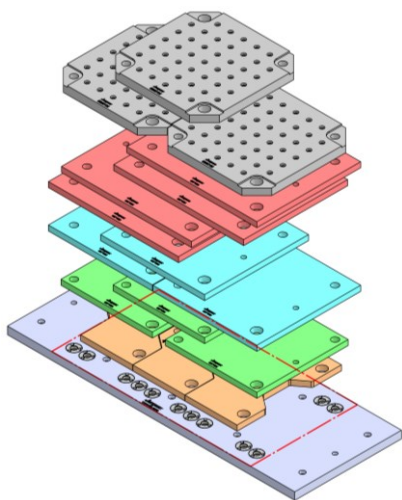

1100 X 430 X 28 MM

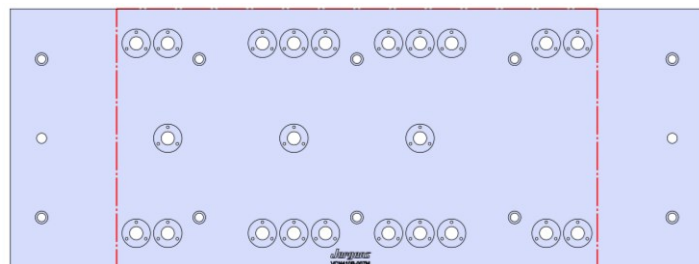

## VCN410B-007M

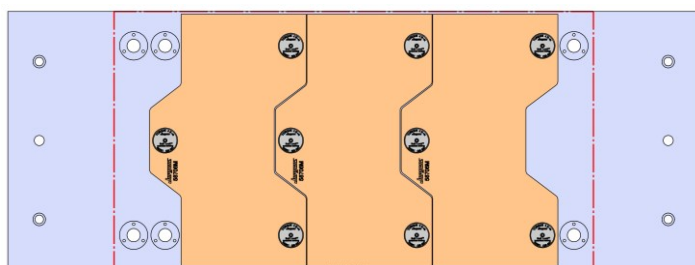

58706 Aluminum

58806 Steel

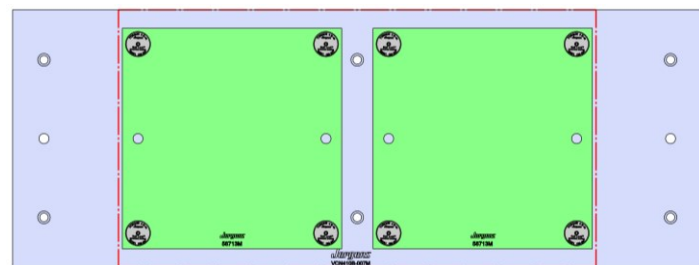

58713 Aluminum

58813 Steel

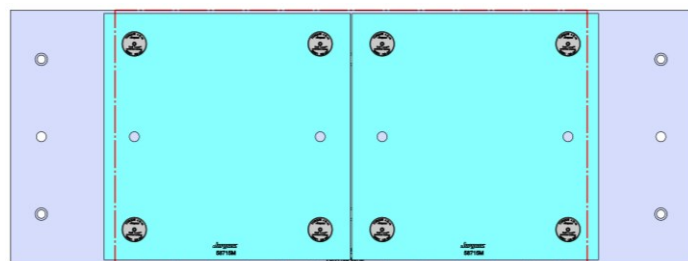

58715 Aluminum

58815 Steel

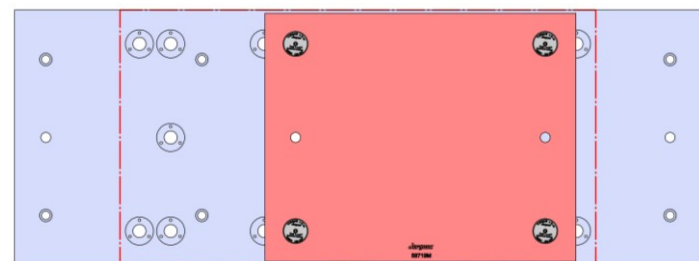

58719 Aluminum

Steel Available upon request

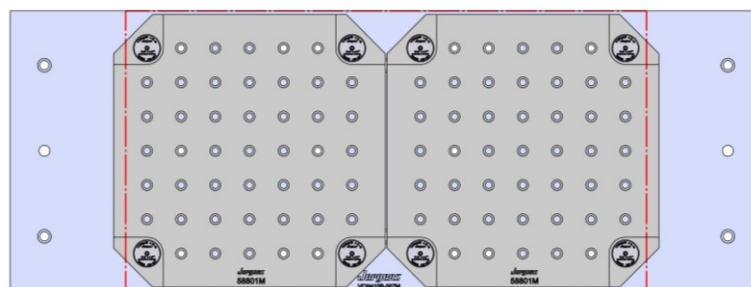

58801 Steel



VCN410B-008M

Mazak NEXUS 410B

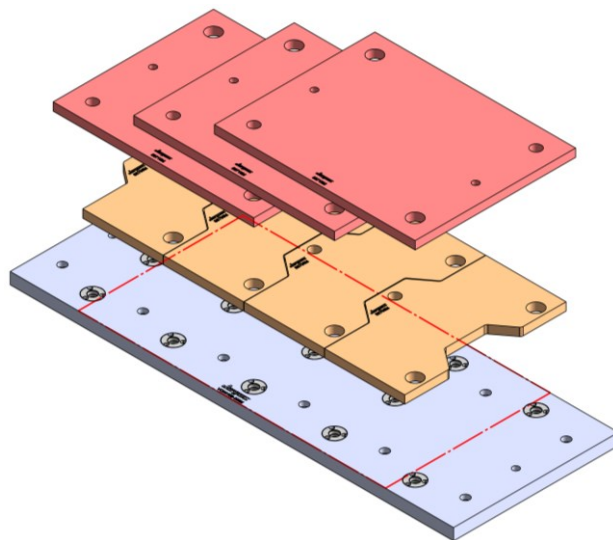

1100 X 430 X 28 MM

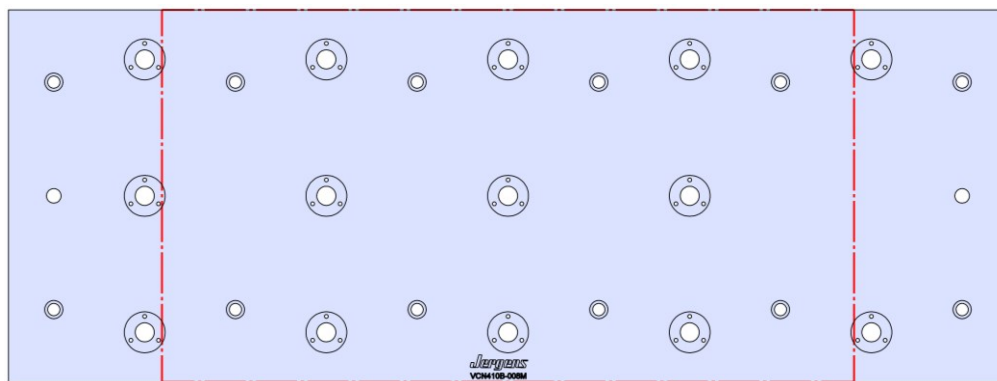

VCN410B-008M

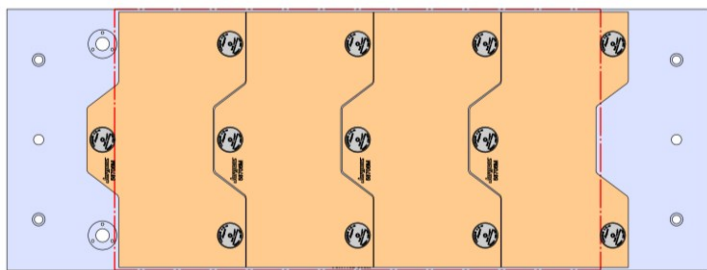

58706 Aluminum

58806 Steel

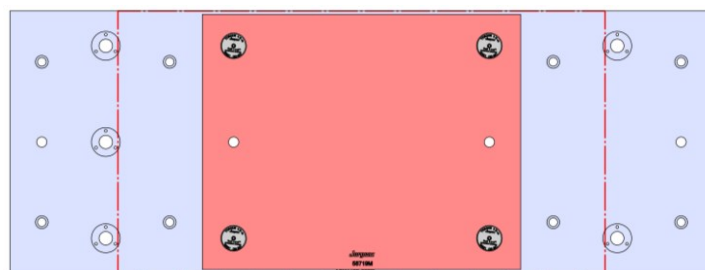

58719 Aluminum

Steel Available upon request



# VCN410B-009M

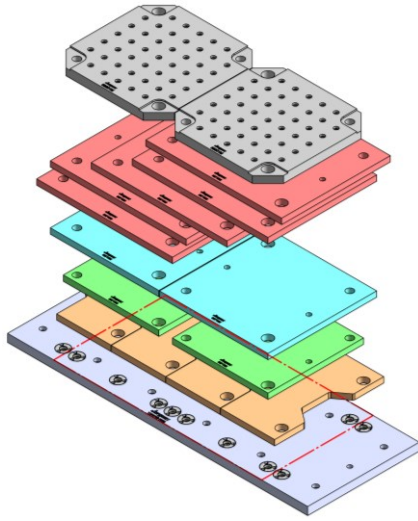

1100 X 430 X 28 MM

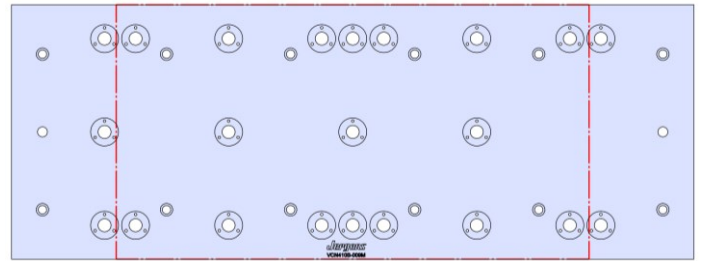

## VCN410B-009M

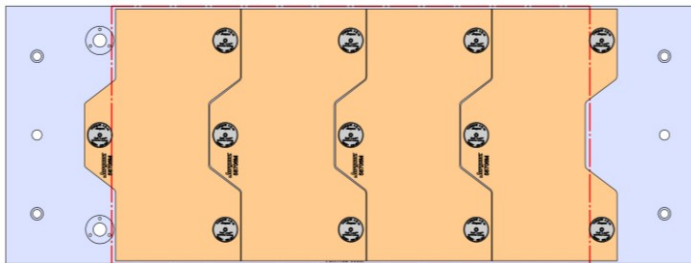

58706 Aluminum

58806 Steel

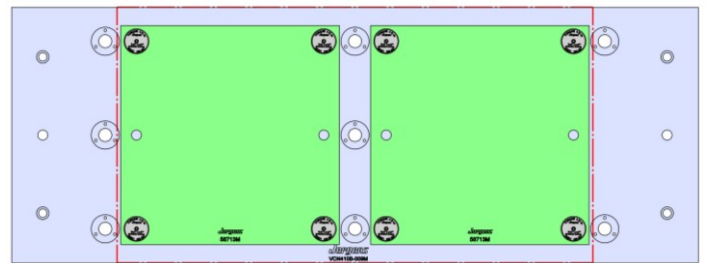

58713 Aluminum

58813 Steel

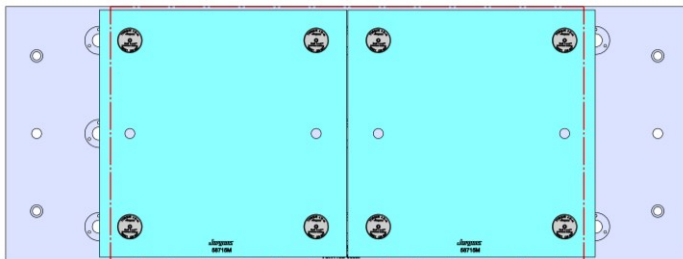

58715 Aluminum

58815 Steel

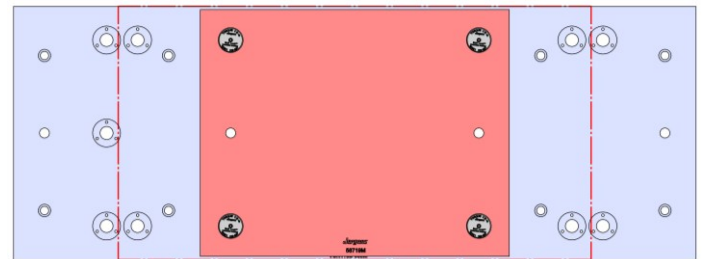

58719 Aluminum

Steel Available upon request

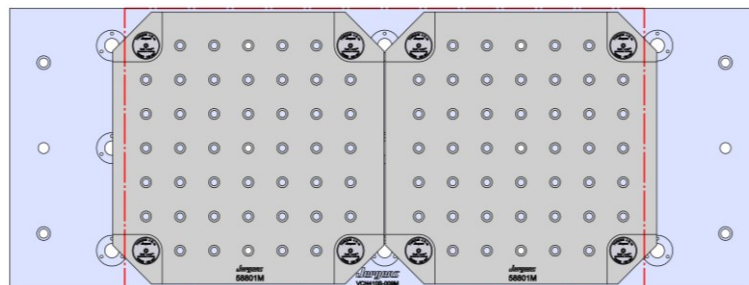

58801 Steel



# VCN410B-010M

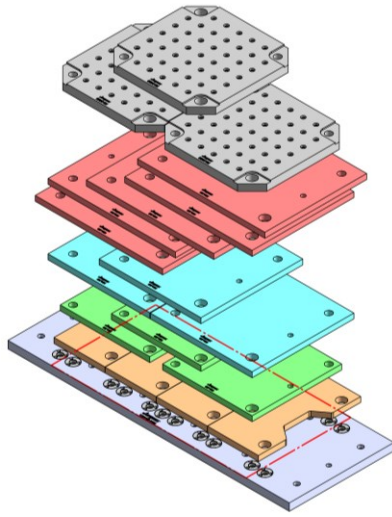

1100 X 430 X 28 MM

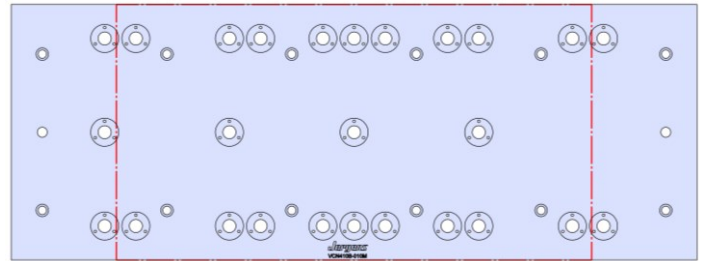

## VCN410B-010M

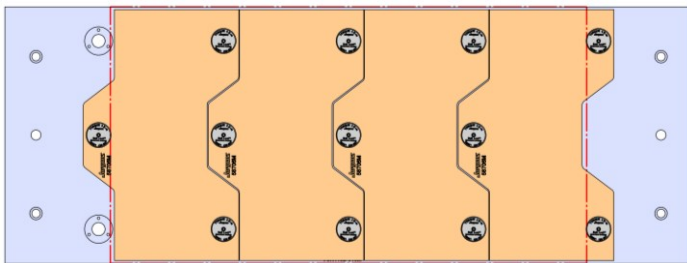

58706 Aluminum

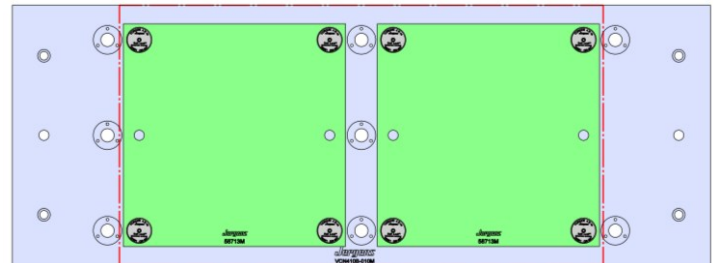

58713 Aluminum

58806 Steel

58813 Steel

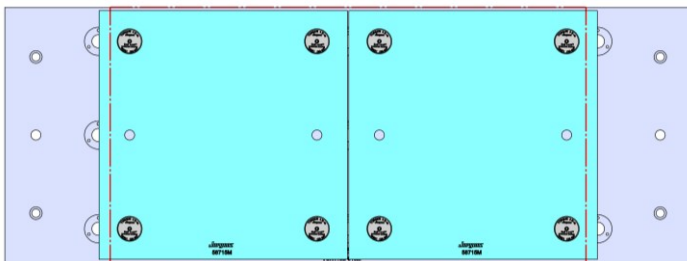

58715 Aluminum

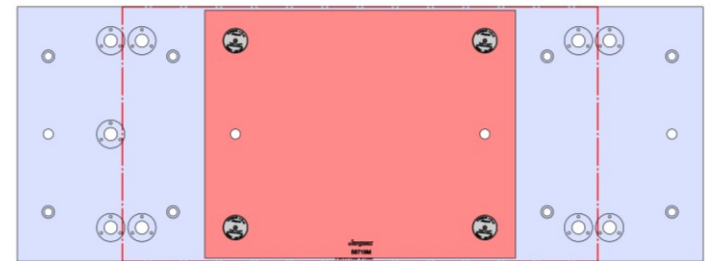

58719 Aluminum

Steel Available upon request

58815 Steel

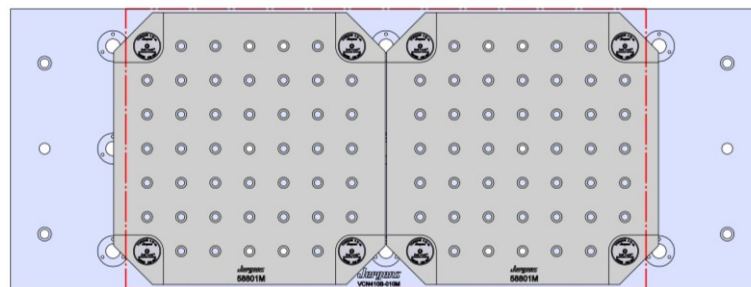

58801 Steel



# NEXUS 510C



- ### Table Specifications
- Table Travel (X, Y, Z): 1050 X 530 X 510mm
  - Table Dimensions (L x W): 1300 X 550mm
  - Maximum Weight on Table: 1198 Kg
  - T-Slot Width: .709" (18mm)
  - T-Slot Center Distance: 3.937" (100mm)

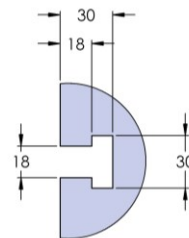
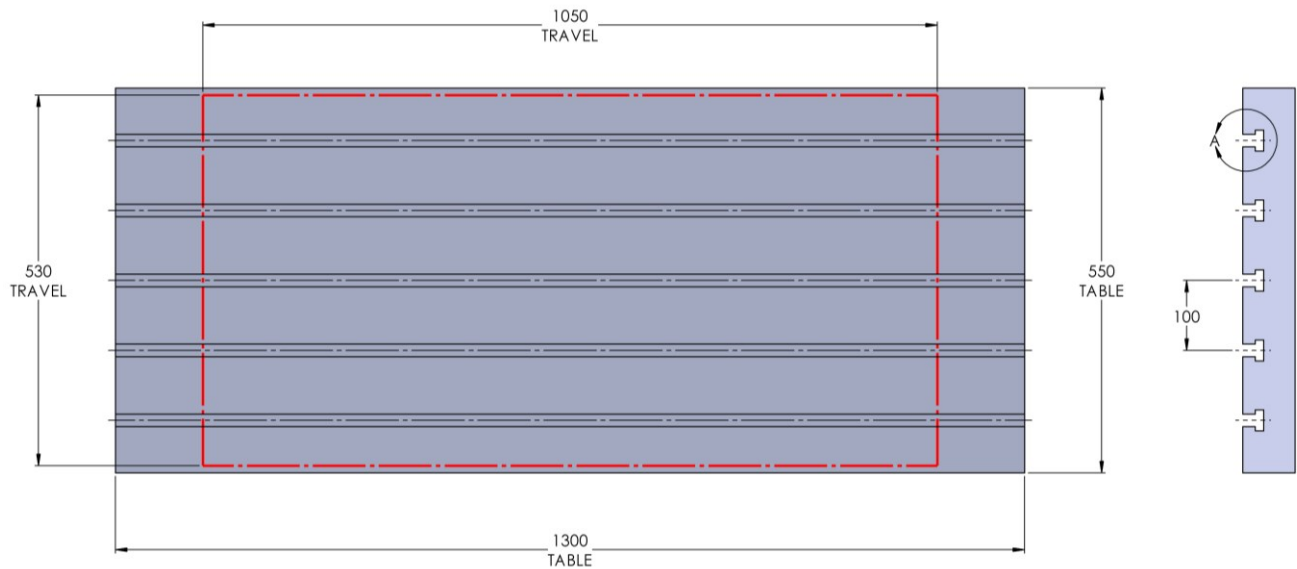

T-SLOT  
DETAIL A



VCN510C-001M

**Mazak** NEXUS 510C

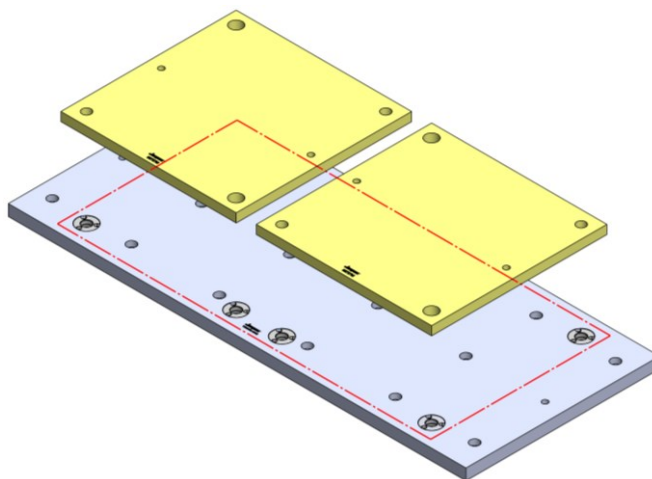

1300 X 550 X 32 MM

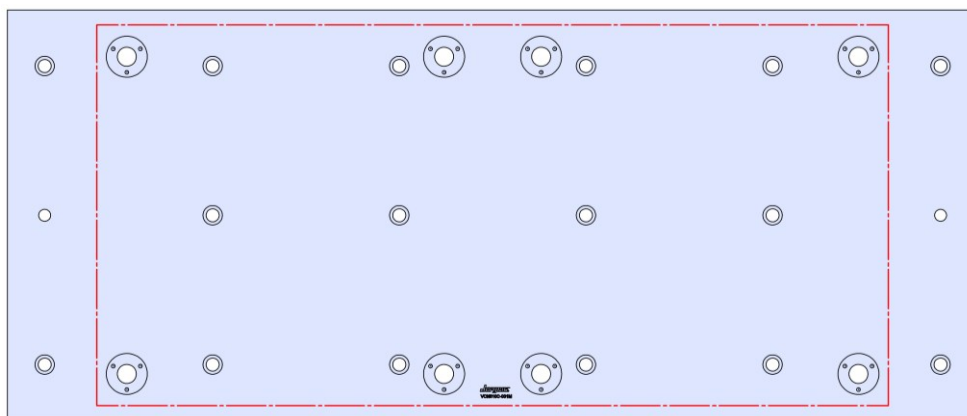

VCN510C-001M

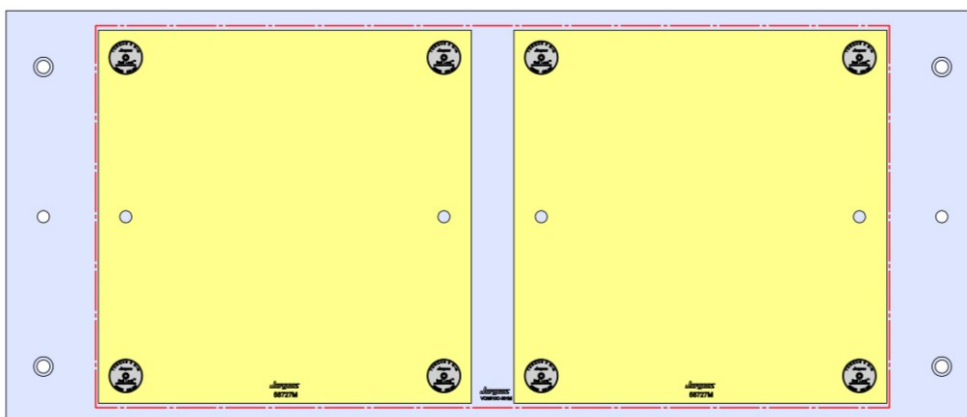

58727 Aluminum

58827 Steel



VCN510C-002M

Mazak NEXUS 510C

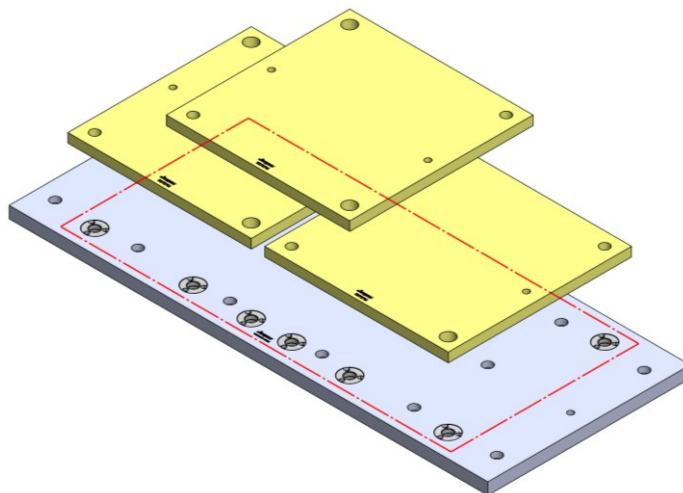

1300 X 550 X 32 MM

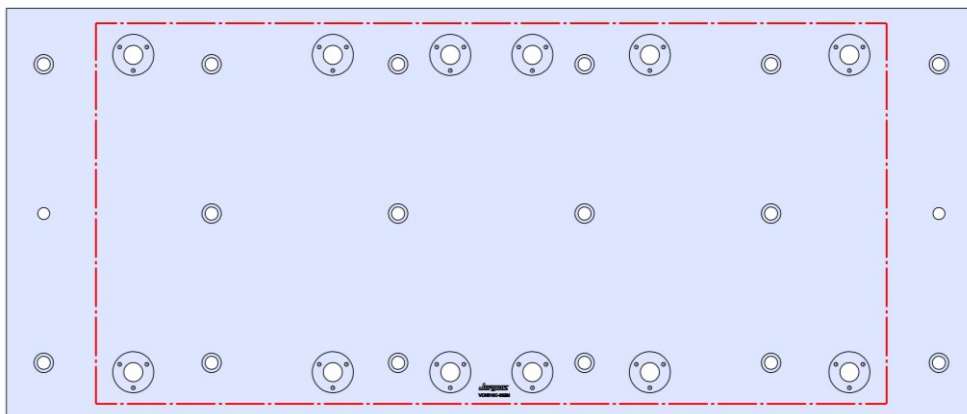

VCN510C-002M

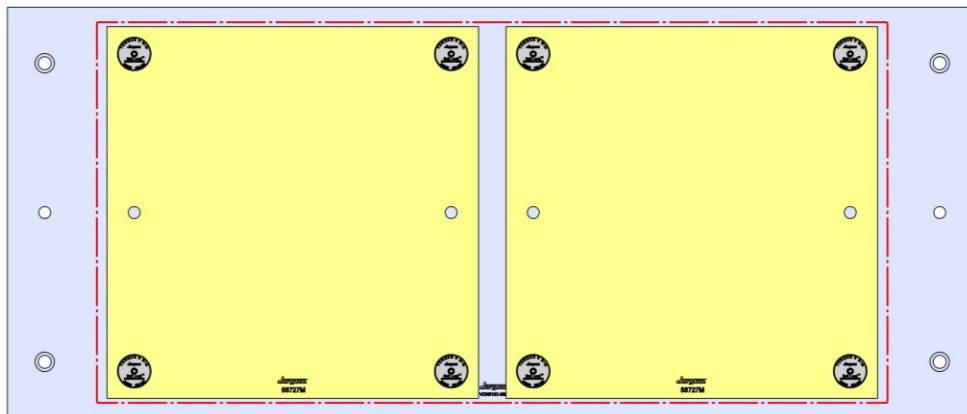

58727 Aluminum

58827 Steel



VCN510C-003M

Mazak NEXUS 510C

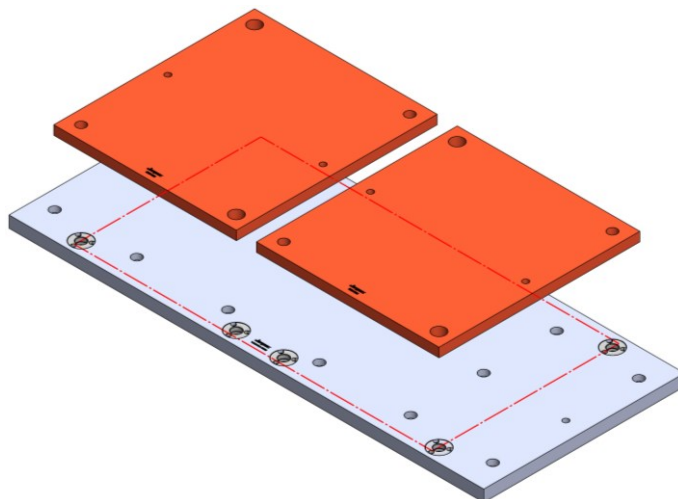

1300 X 550 X 32 MM

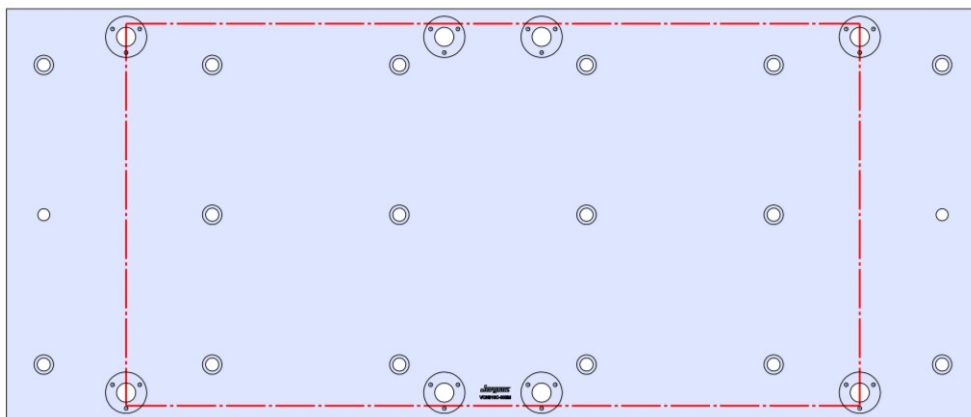

VCN510C-003M

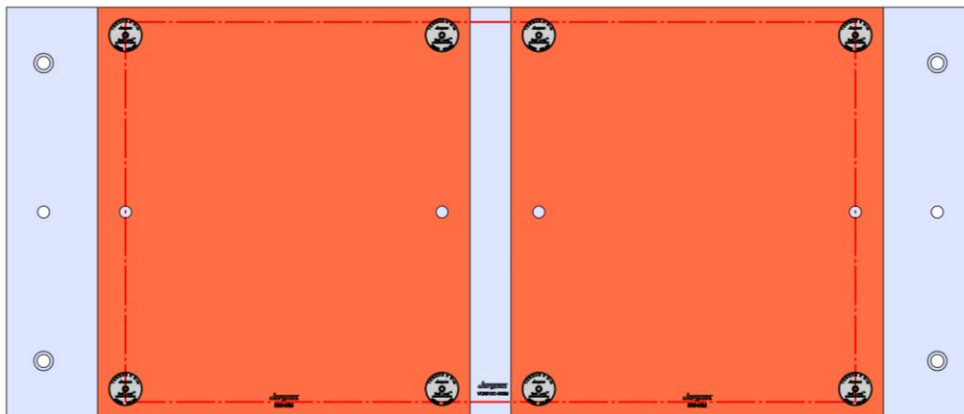

Aluminum Available upon request

58845 Steel



VCN510C-004M

Mazak NEXUS 510C

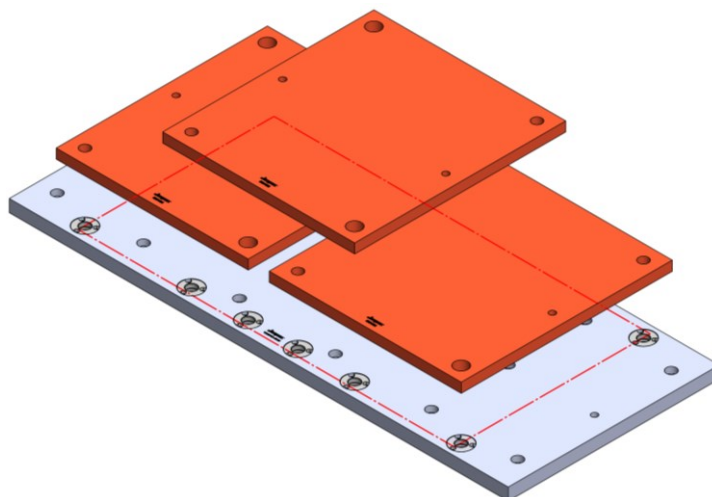

1300 X 550 X 32 MM

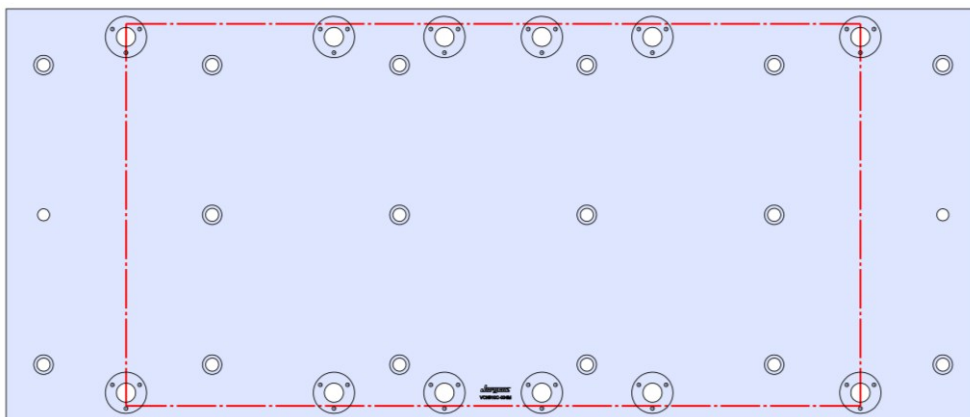

VCN510C-004M

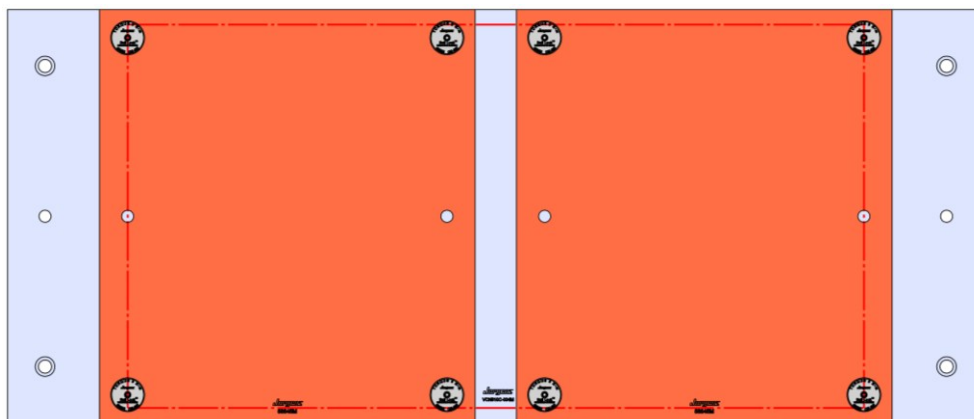

Aluminum Available upon request

58845 Steel



# VCN510C-005M

1300 X 550 X 32 MM

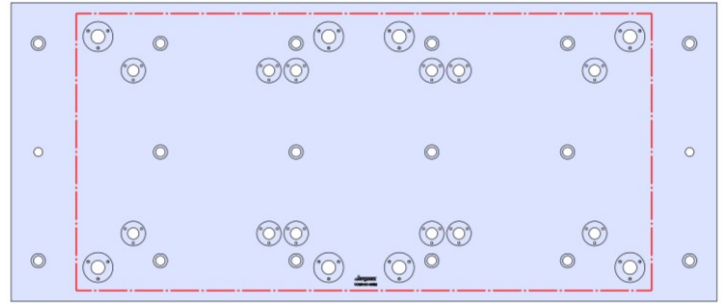
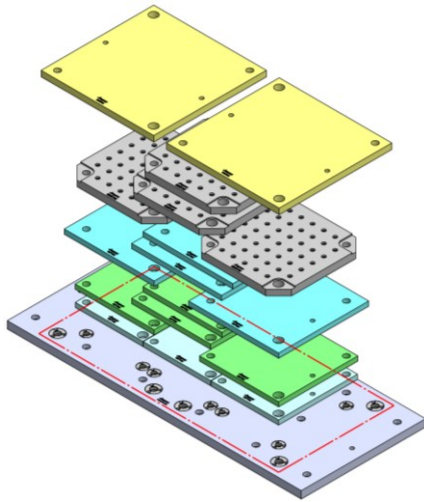

## VCN510C-005M

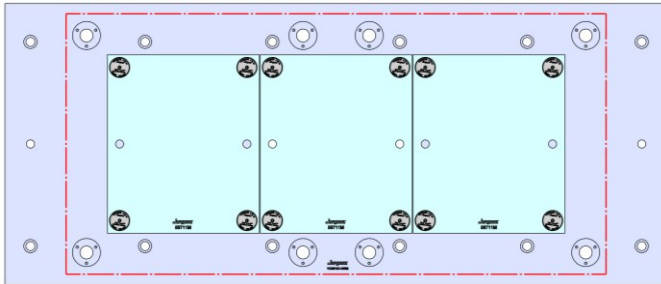

58711 Aluminum

Steel Available upon request

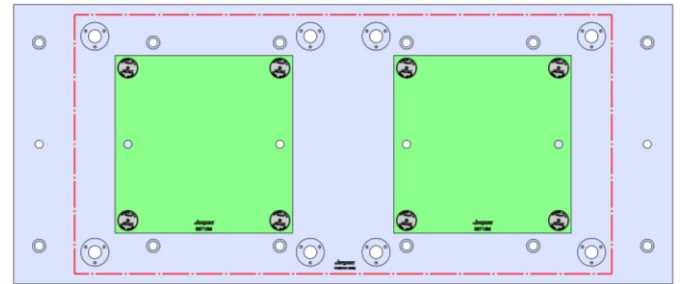

58713 Aluminum

58813 Steel

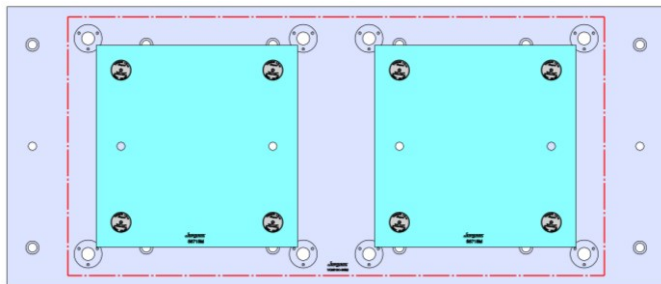

58715 Aluminum

58815 Steel

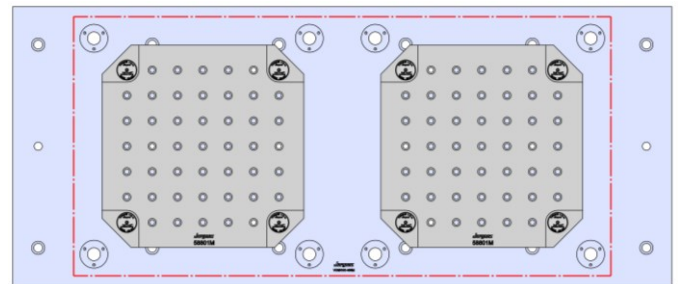

58801 Steel

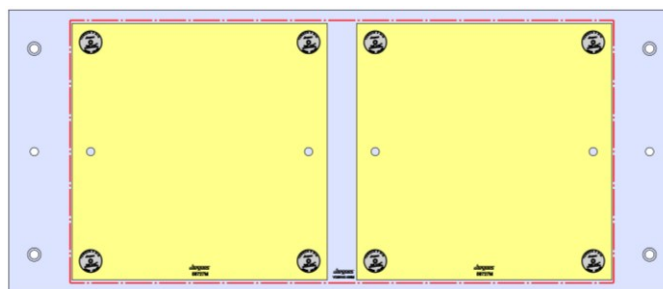

58727 Aluminum

58827 Steel



# VCN510C-006M

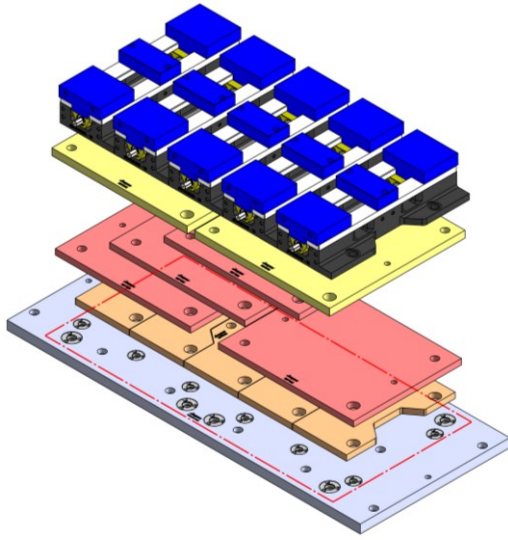

1300 X 550 X 32 MM

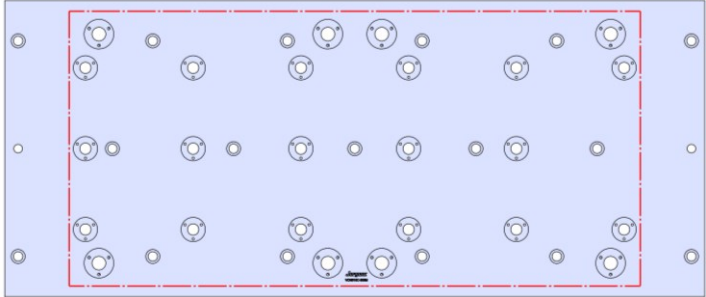

## VCN510C-006M

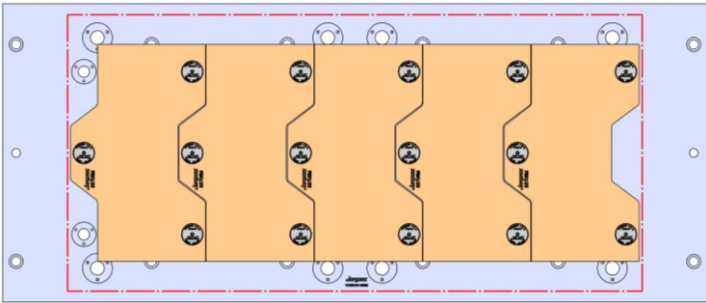

58706 Aluminum

58806 Steel

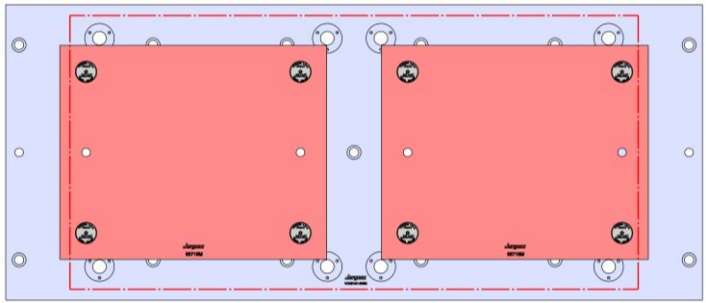

58719 Aluminum

Steel Available upon request

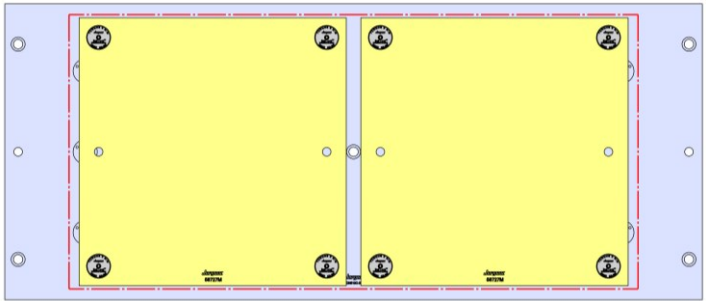

58727 Aluminum

58827 Steel

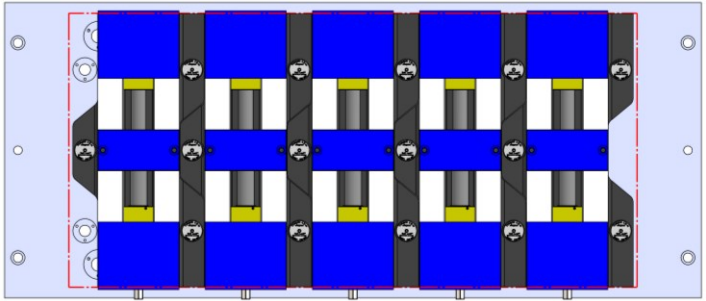

69406 150MM Vise Ball-Lock® Base



# VCN510C-007M

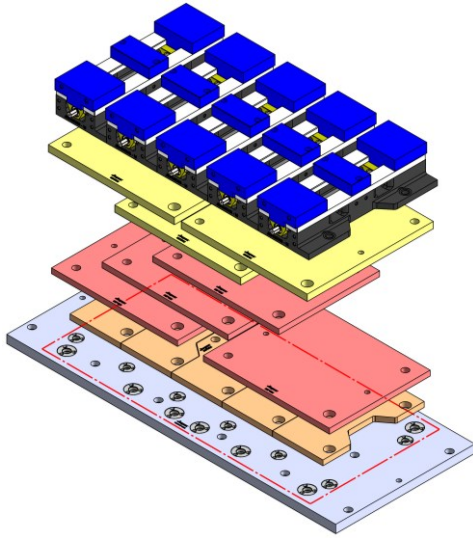

1300 X 550 X 32 MM

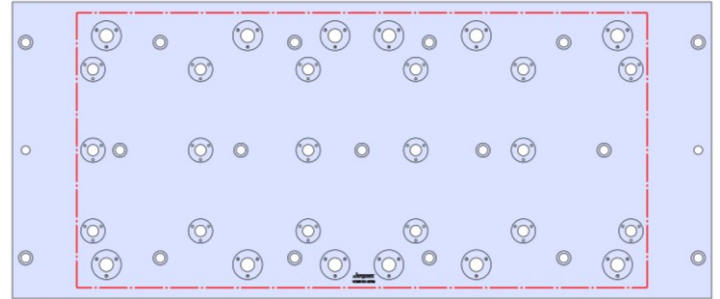

## VCN510C-007M

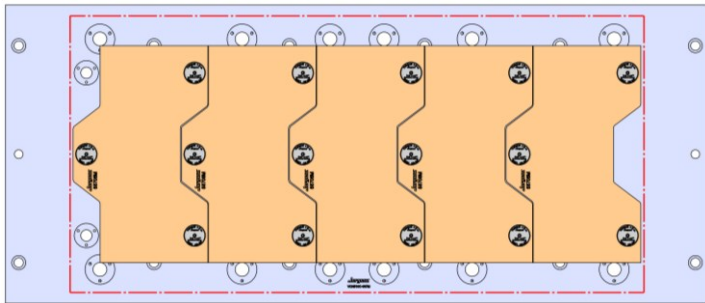

58706 Aluminum

58806 Steel

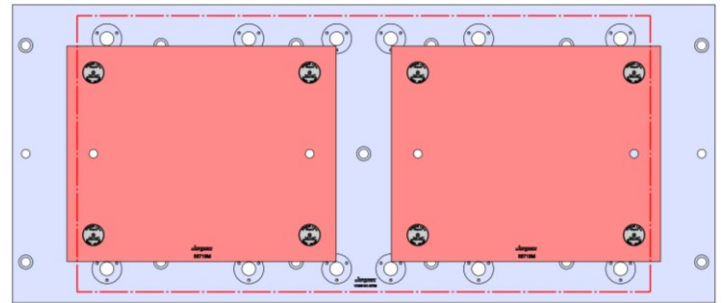

58719 Aluminum

Steel Available upon request

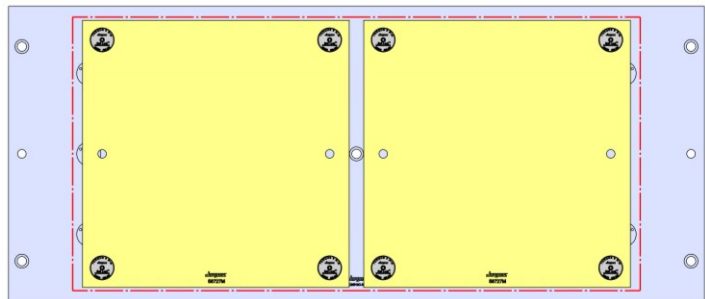

58727 Aluminum

58827 Steel

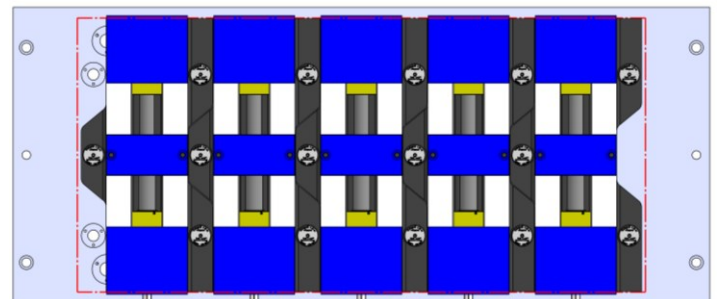

69406 150MM Vise Ball-Lock® Base



# VCN510C-008M

Mazak NEXUS 510C

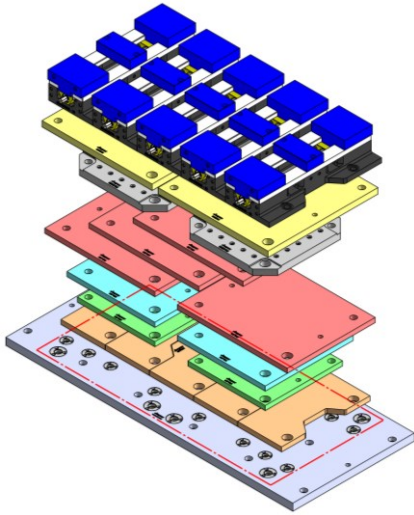

1300 X 550 X 32 MM

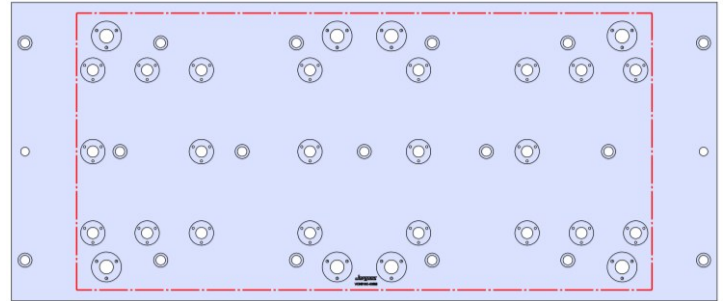

## VCN510C-008M

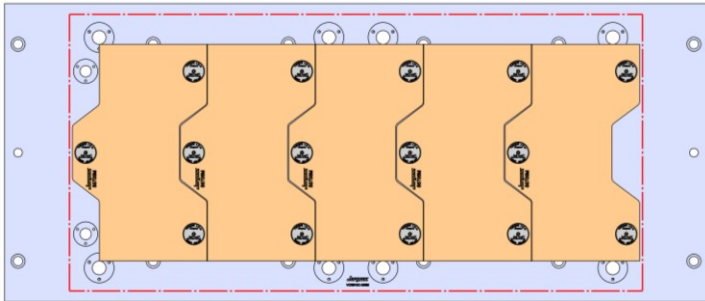

58706 Aluminum

58806 Steel

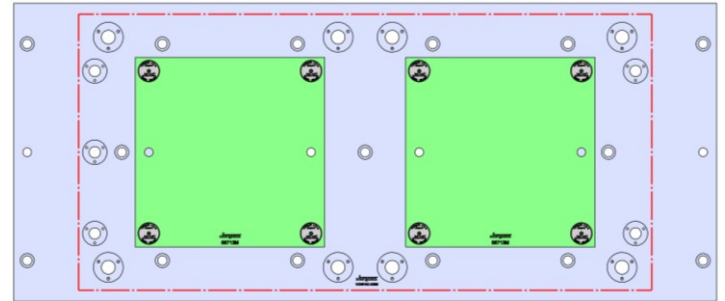

58713 Aluminum

58813 Steel

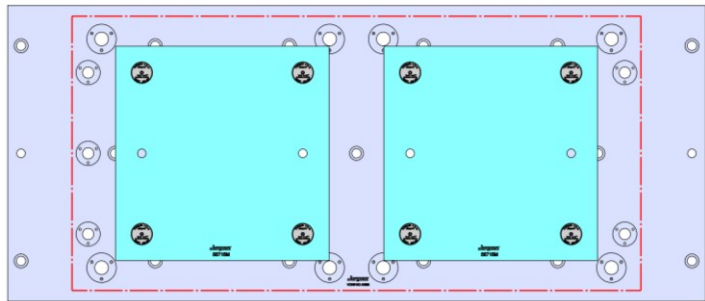

58715 Aluminum

58815 Steel

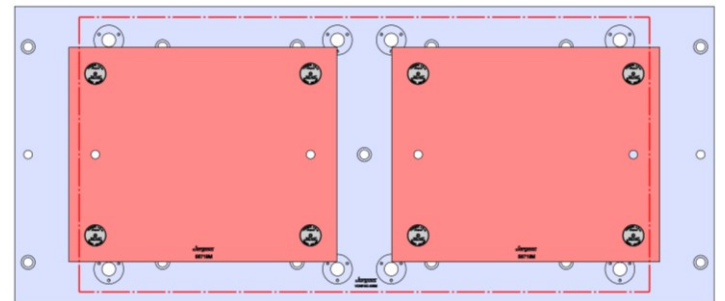

58719 Aluminum

Steel Available upon request



# VCN510C-008M (CONTINUED)

Mazak NEXUS 510C

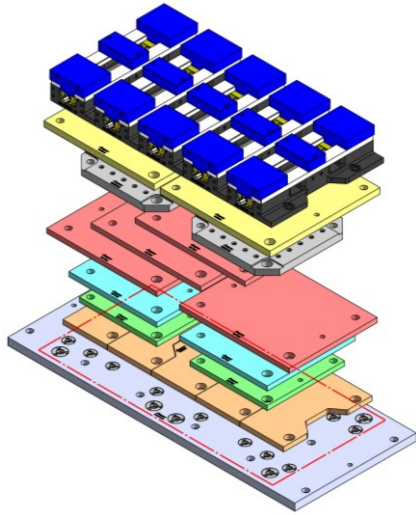

1300 X 550 X 32 MM

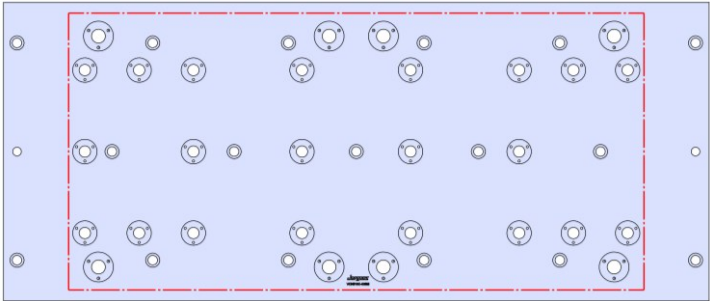

VCN510C-008M

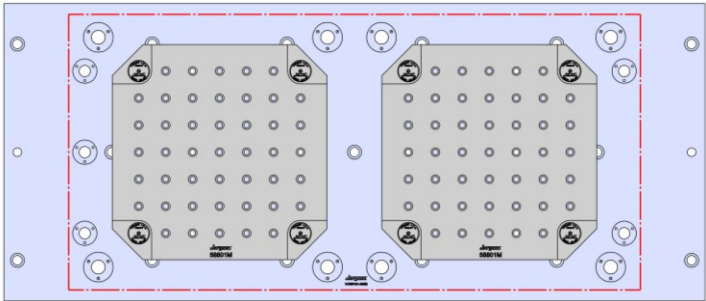

58801 Steel

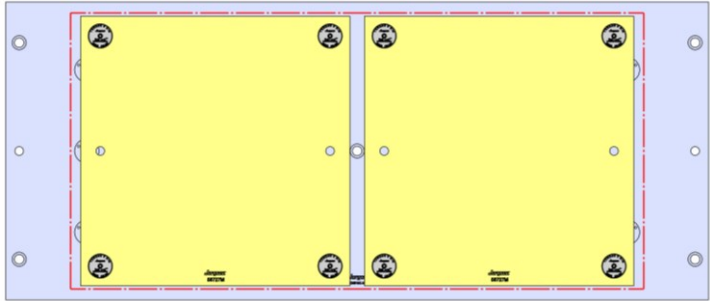

58727 Aluminum

58827 Steel

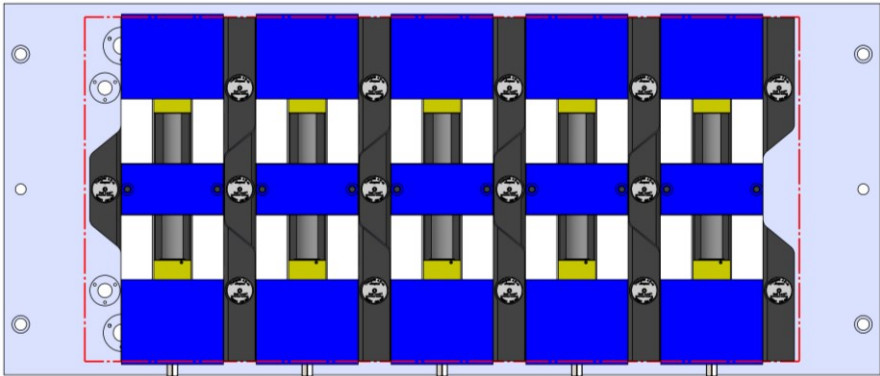

69406 150MM Vise Ball-Lock® Base



# VCN510C-009M

Mazak NEXUS 510C

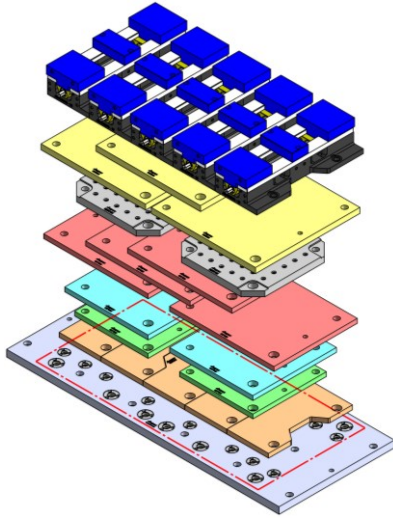

1300 X 550 X 32 MM

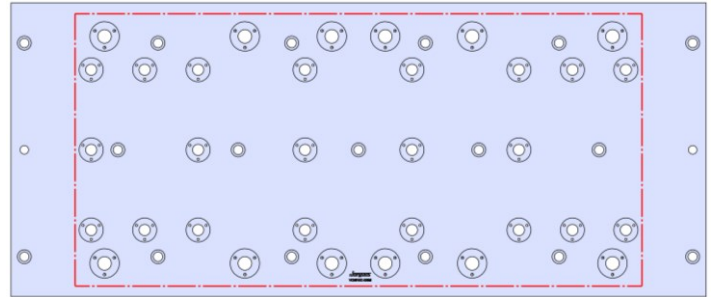

VCN510C-009M

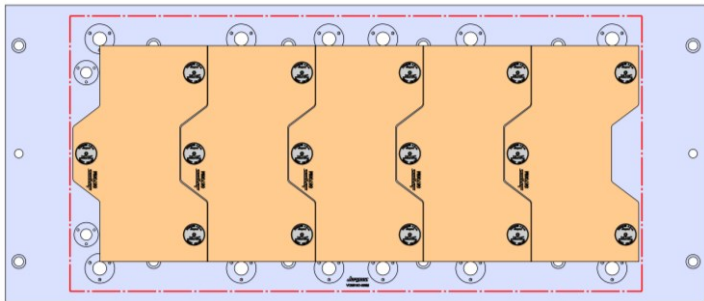

58706 Aluminum

58806 Steel

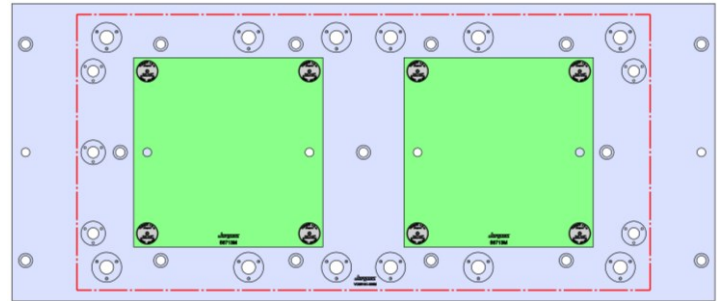

58713 Aluminum

58813 Steel

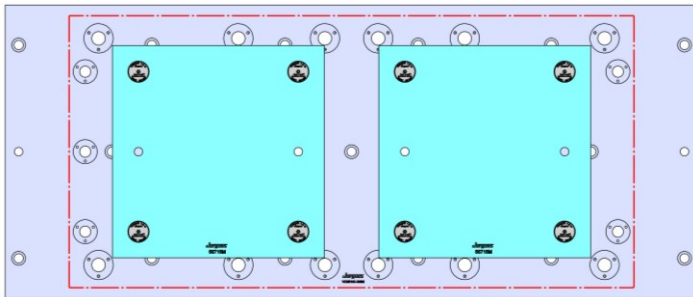

58715 Aluminum

58815 Steel

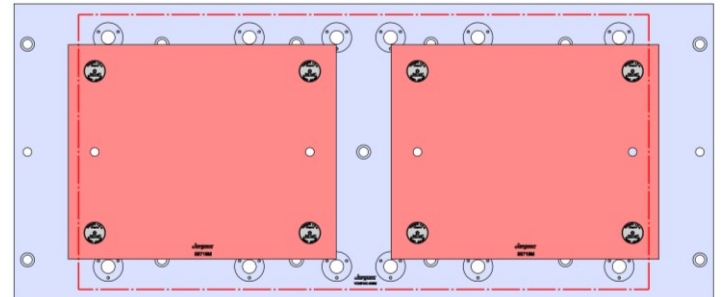

58719 Aluminum

Steel Available upon request



# VCN510C-009M (CONTINUED)

Mazak NEXUS 510C

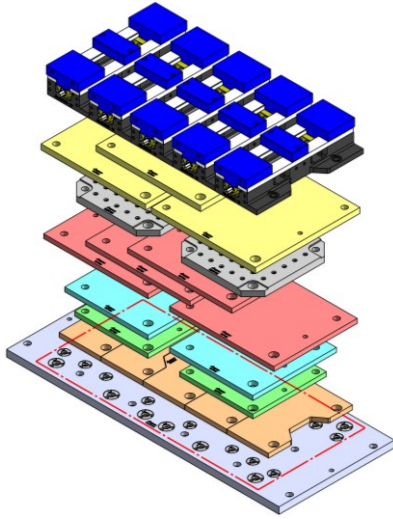

1300 X 550 X 32 MM

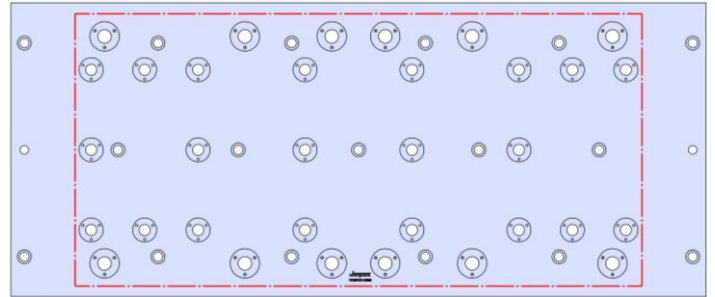

VCN510C-009M

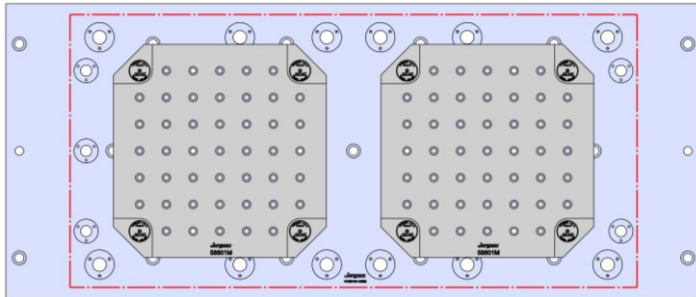

58801 Steel

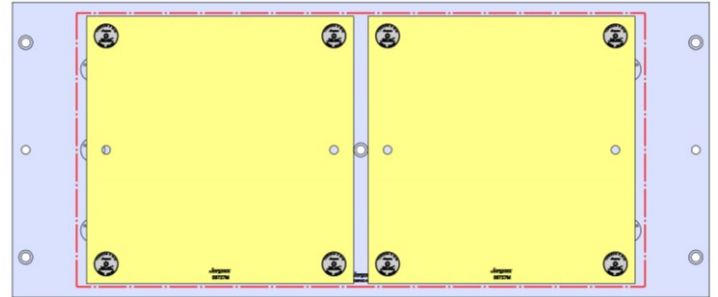

58727 Aluminum

58827 Steel

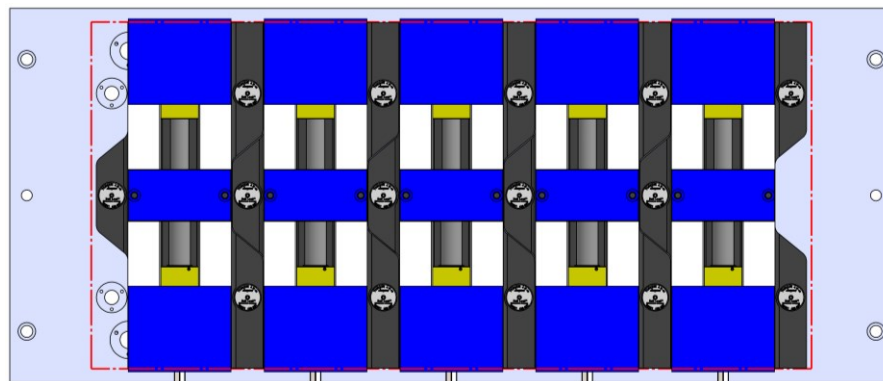

69406 150MM Vise Ball-Lock® Base



# VCN510C-010M

Mazak NEXUS 510C

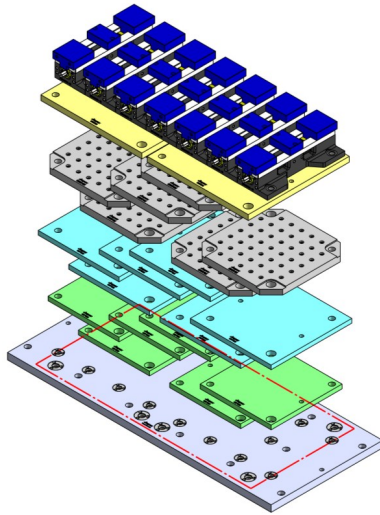

1300 X 550 X 32 MM

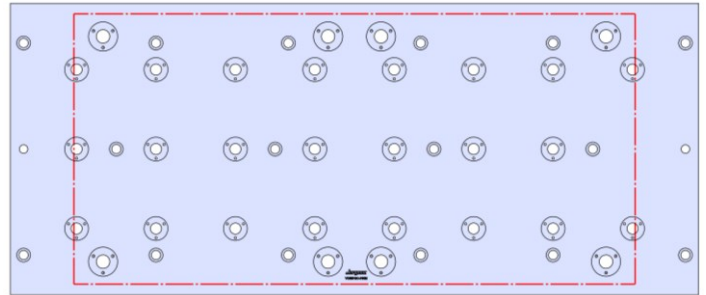

## VCN510C-010M

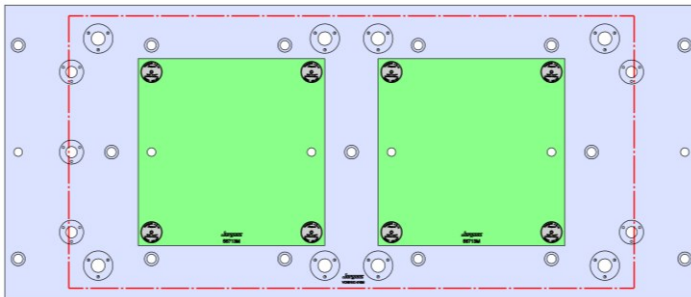

58713 Aluminum

58813 Steel

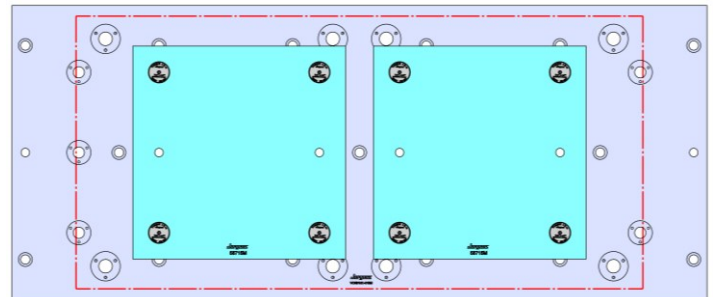

58715 Aluminum

58815 Steel

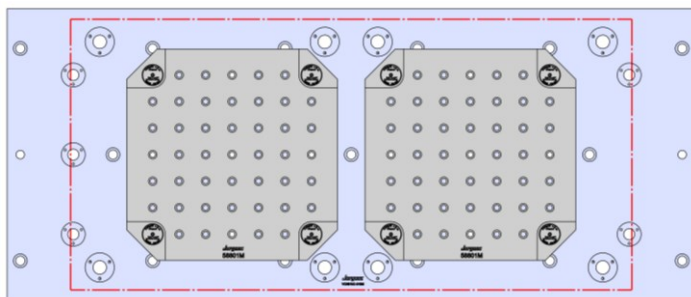

58801 Steel

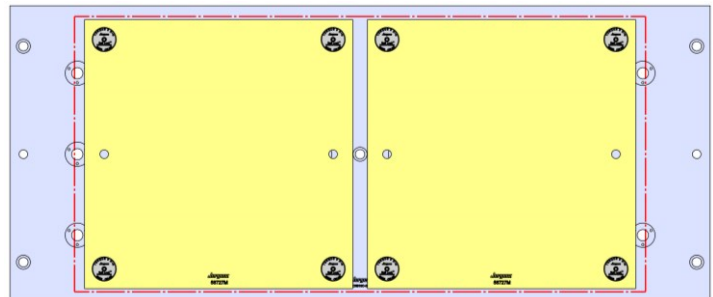

58727 Aluminum

58827 Steel



# VCN510C-010M (CONTINUED)

Mazak NEXUS 510C

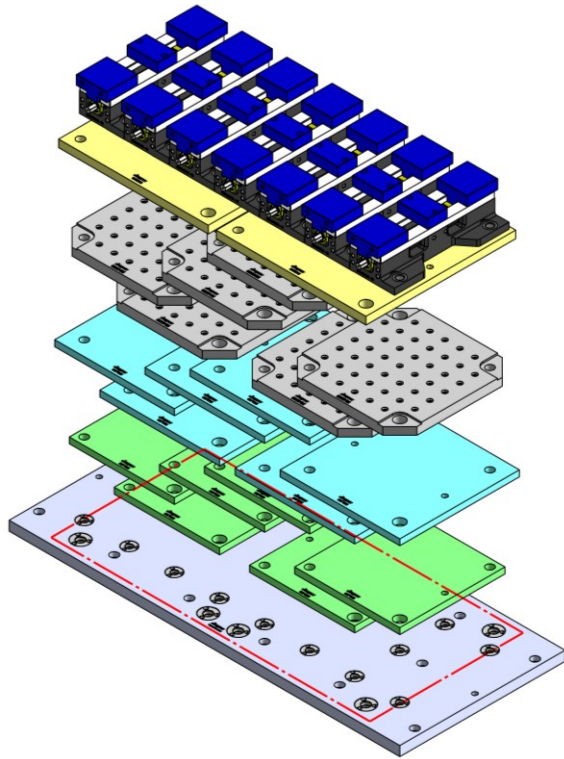

1300 X 550 X 32 MM

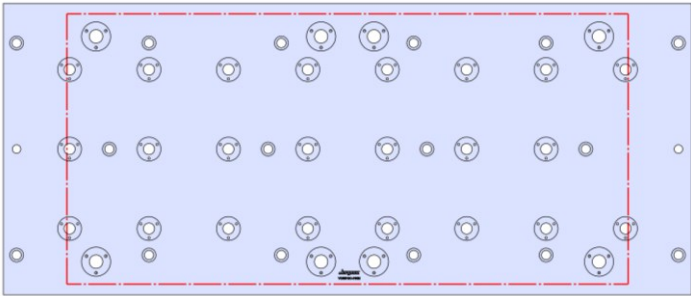

VCN510C-010M

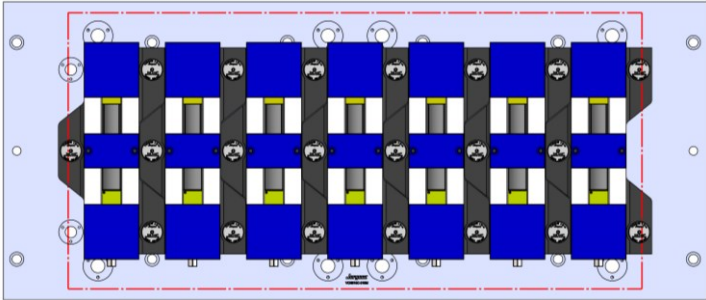

69405 100MM Vise Ball-Lock® Base



# VCN510C-011M

**Mazak** NEXUS 510C

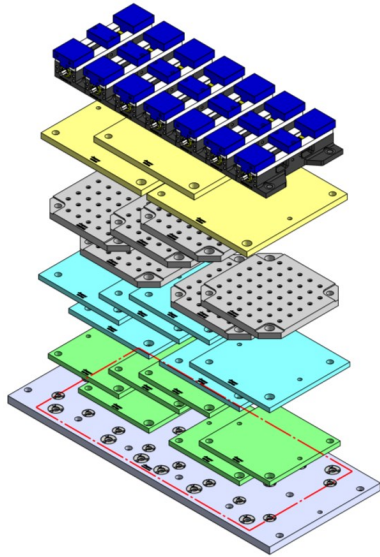

1300 X 550 X 32 MM

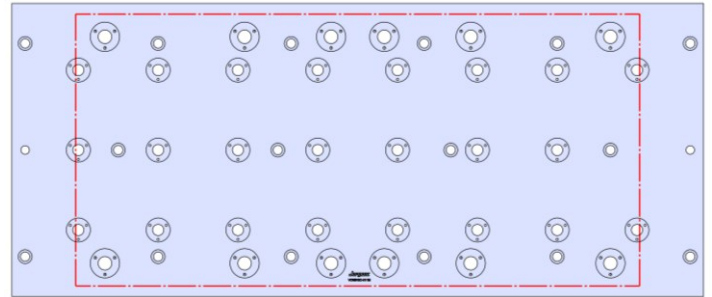

## VCN510C-011M

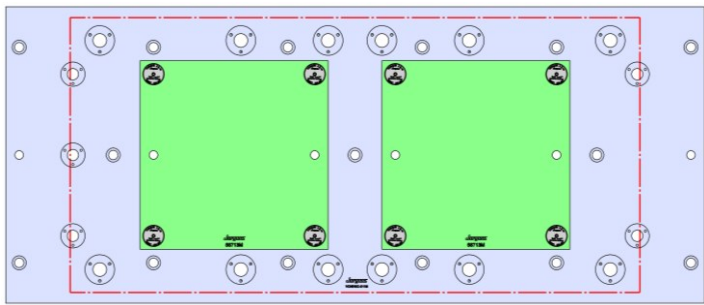

58713 Aluminum

58813 Steel

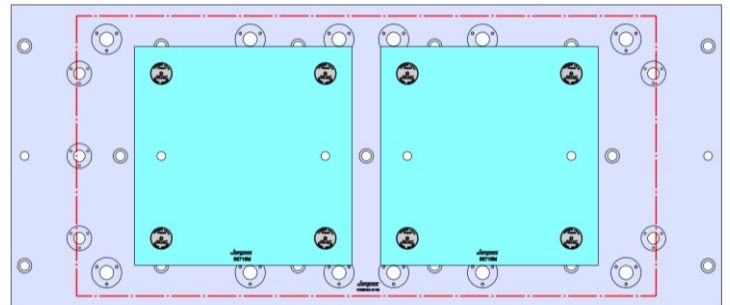

58715 Aluminum

58815 Steel

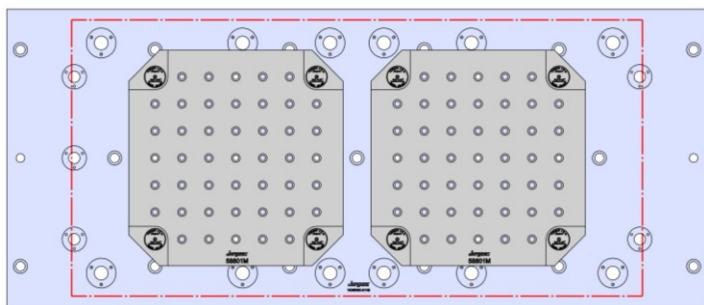

58801 Steel

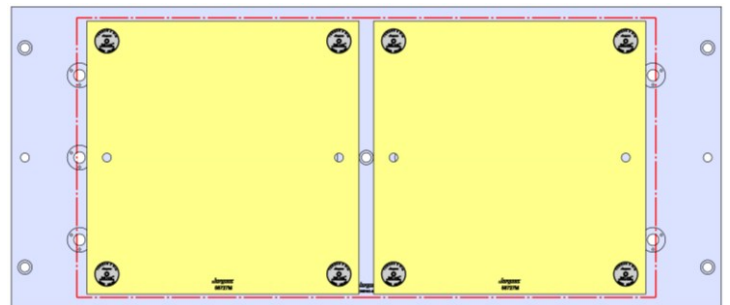

58727 Aluminum

58827 Steel



# VCN510C-011M (CONTINUED)

**Mazak** NEXUS 510C

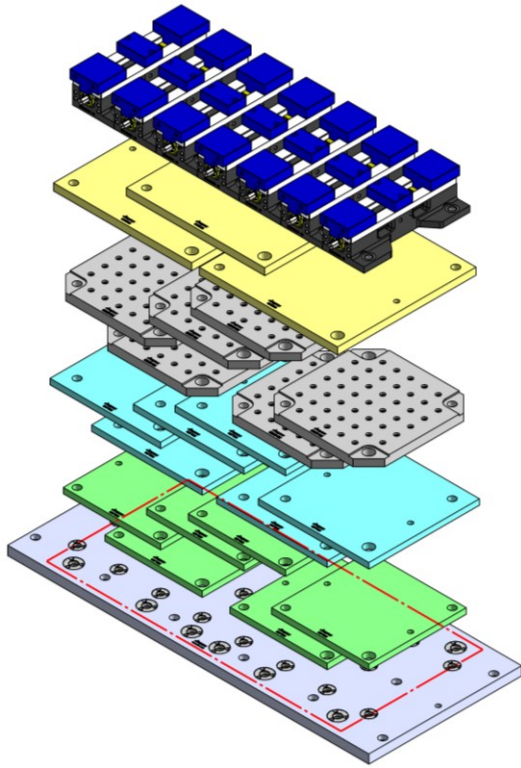

1300 X 550 X 32 MM

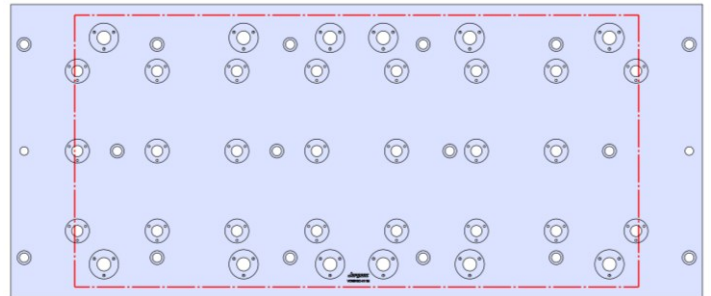

VCN510C-011M

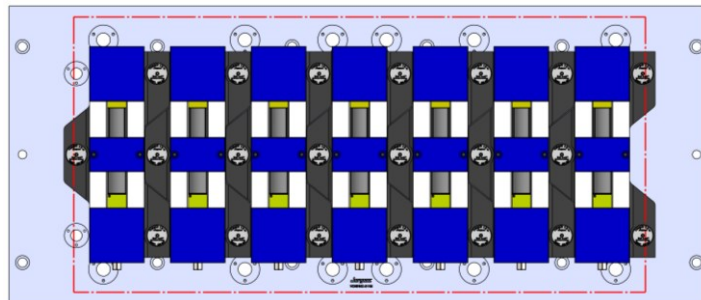

69405 100MM Vise Ball-Lock® Base



# FJV-200



## Table Specifications

- Table Travel (X, Y, Z): 560 X 410 X 410mm
- Table Dimensions (L x W): 800 X 460mm
- Maximum Weight on Table: 350 Kgf
- T-Slot Width: .709" (18mm)
- T-Slot Center Distance: 4.921" (125mm)

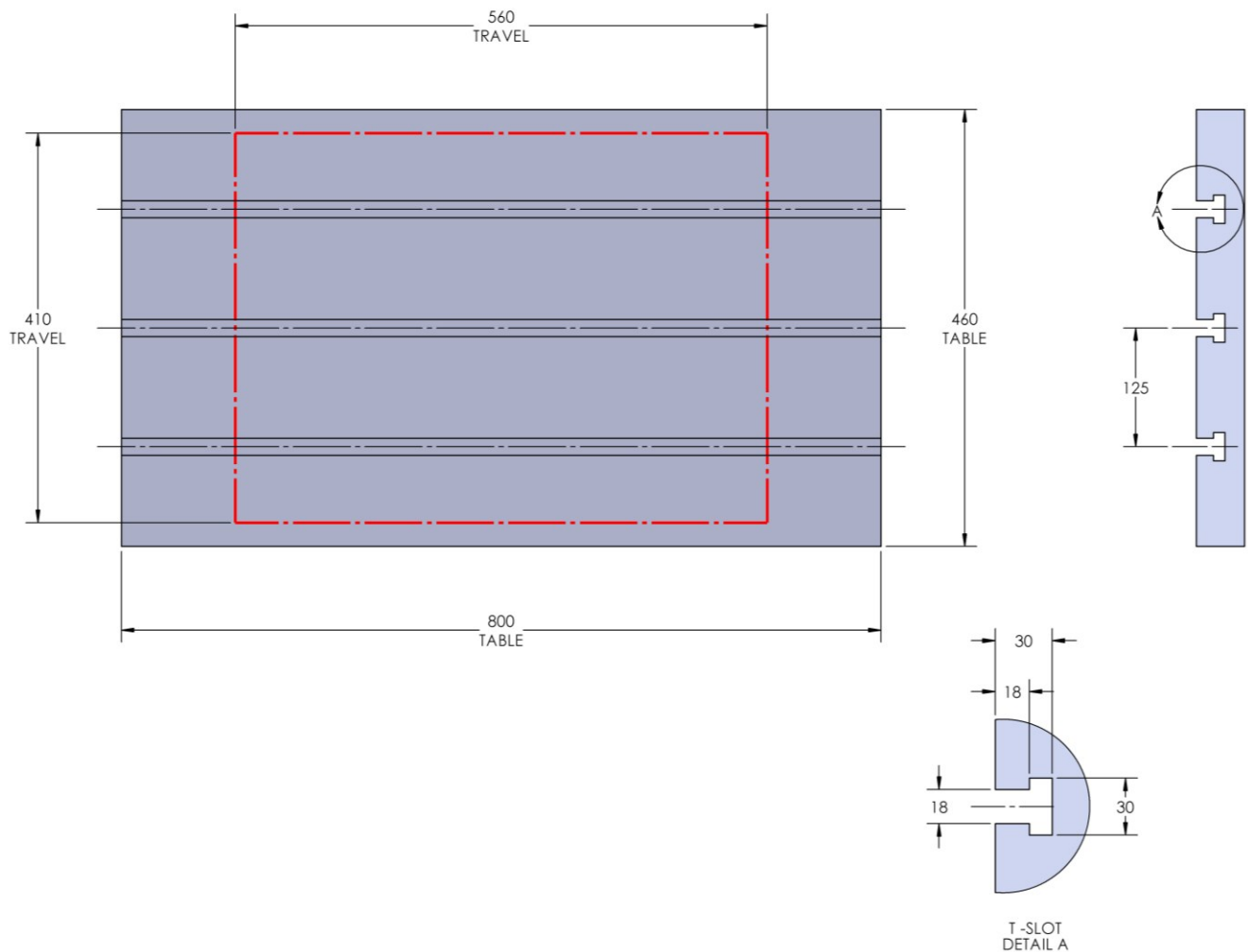



# FJV200-001M

**Mazak** FJV-200



800 X 460 X 28 MM

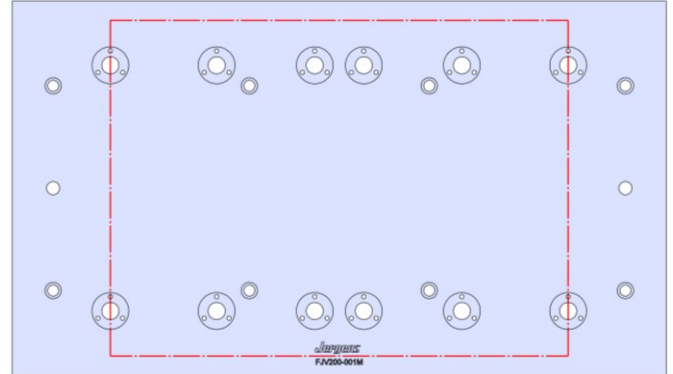
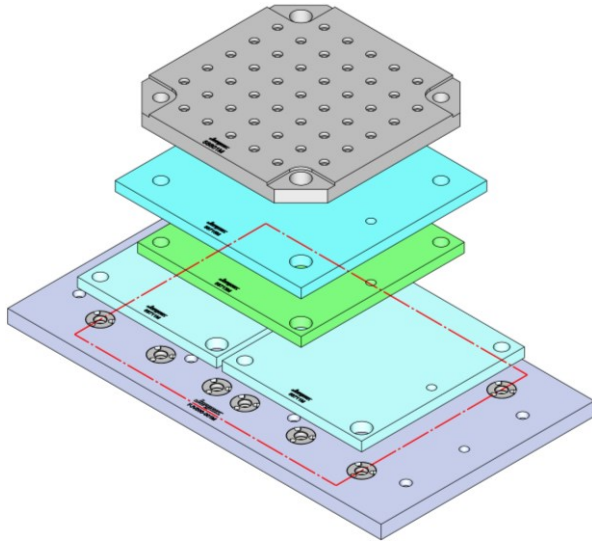

## FJV200-001M

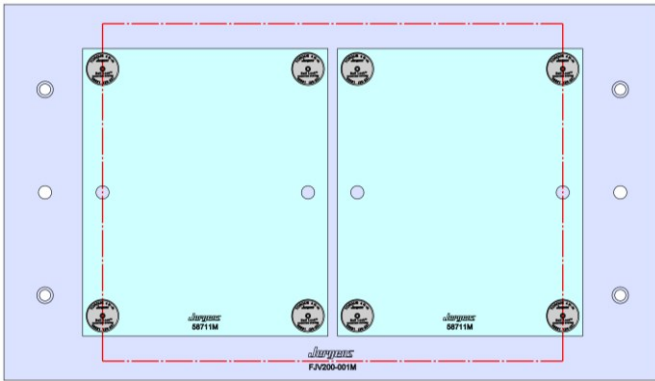

58711 Aluminum

Steel Available upon request

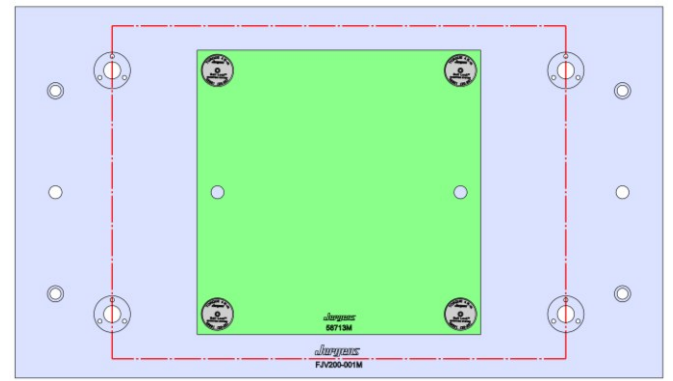

58713 Aluminum

58813 Steel

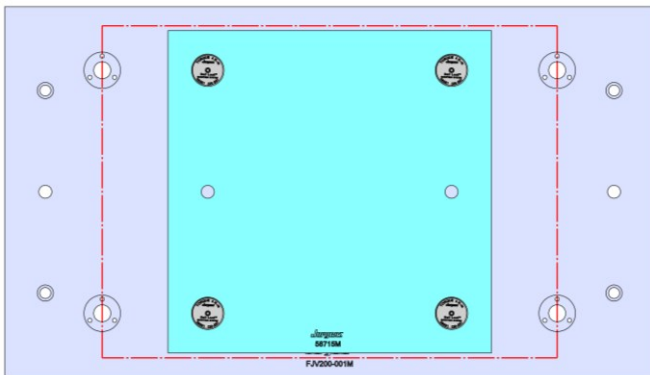

58715 Aluminum

58815 Steel

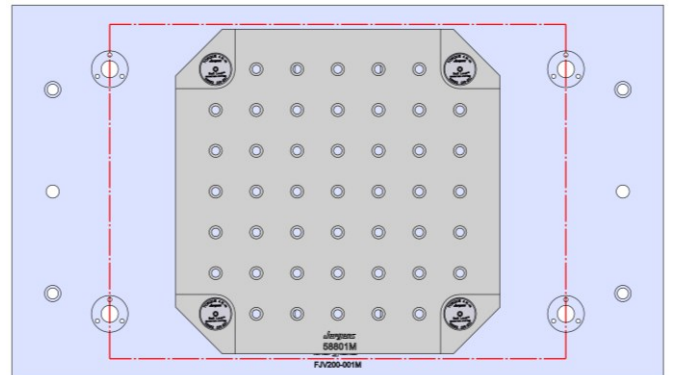

58801 Steel



# FJV200-002M

**Mazak** FJV-200

800 X 460 X 28 MM

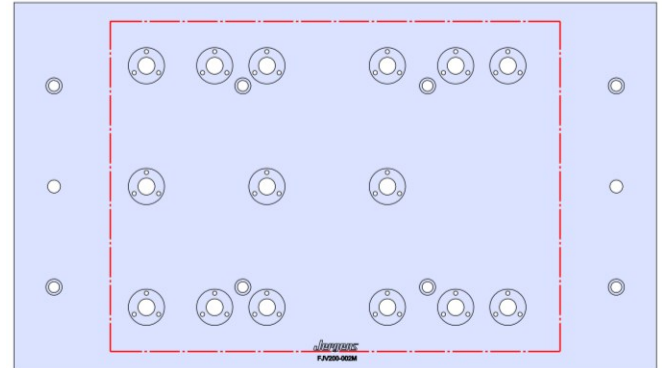
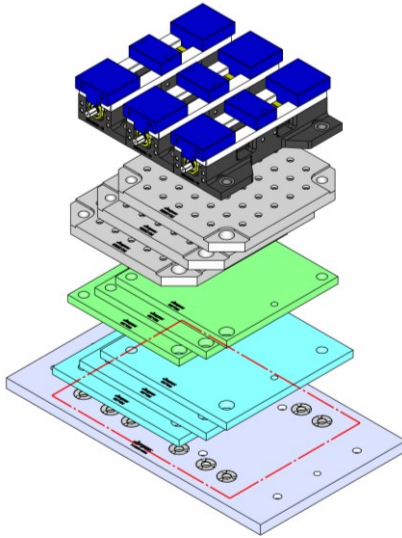

## FJV200-002M

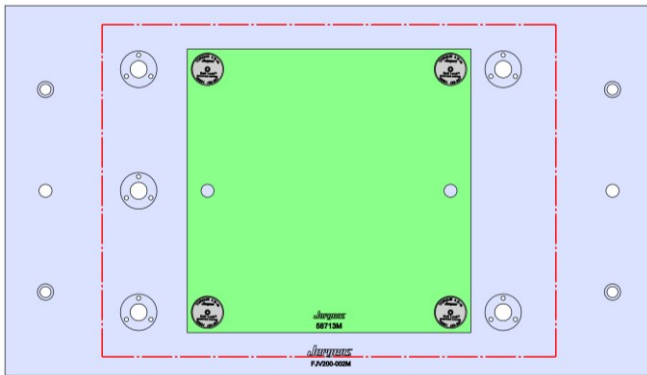

58713 Aluminum

58813 Steel

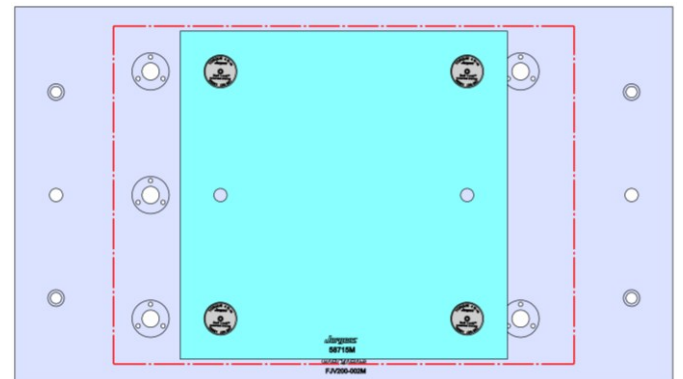

58715 Aluminum

58815 Steel

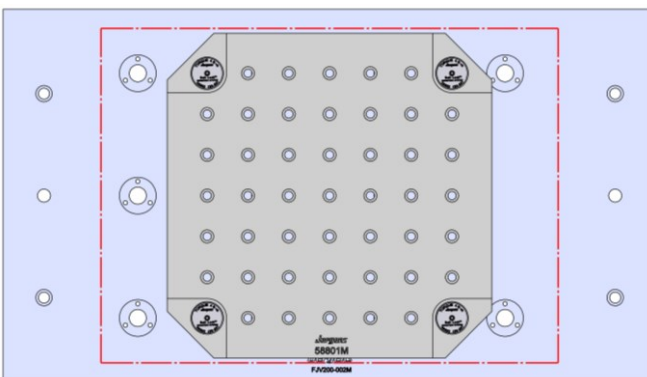

58801 Steel

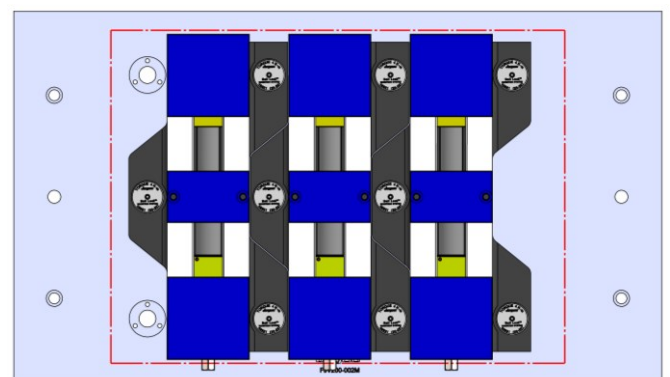

69405 100MM Vise Ball-Lock® Base



# FJV200-003M

**Mazak** FJV-200



800 X 460 X 28 MM

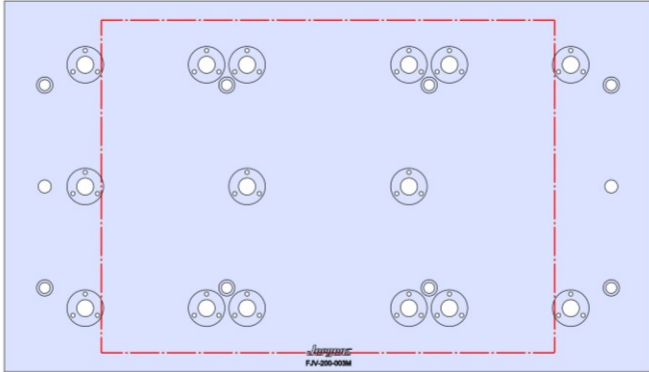
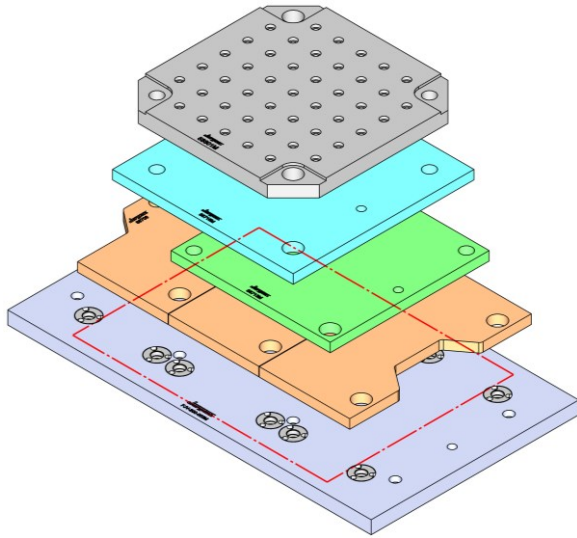

FJV200-003M

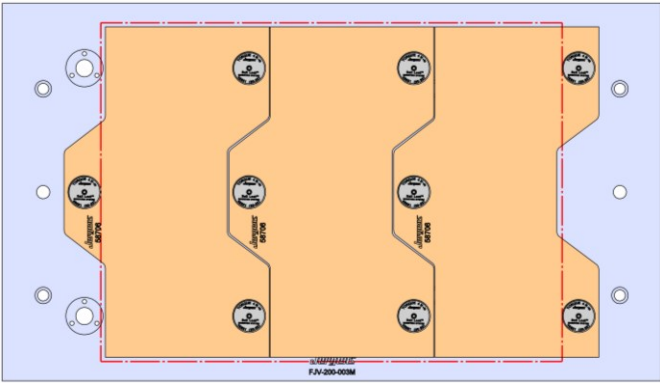

58706 Aluminum

58806 Steel

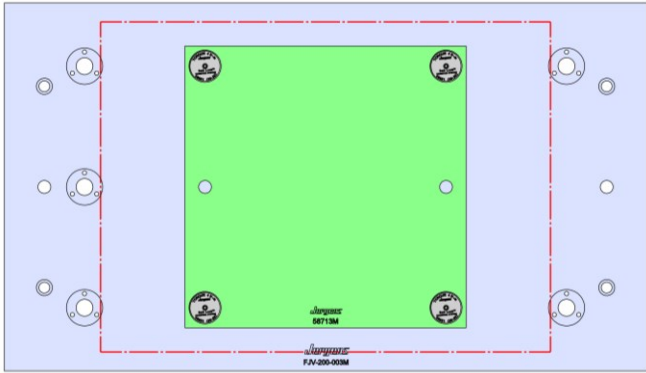

58713 Aluminum

58813 Steel

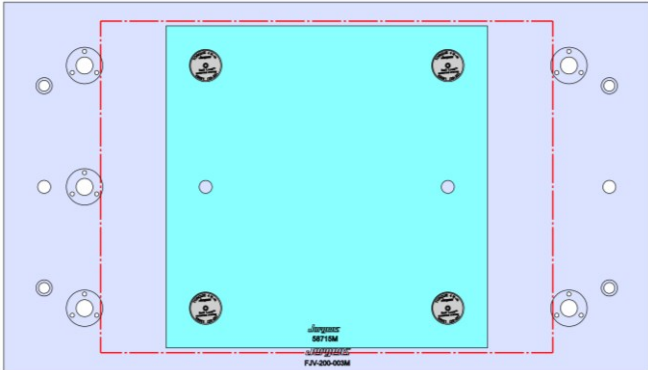

58715 Aluminum

58815 Steel

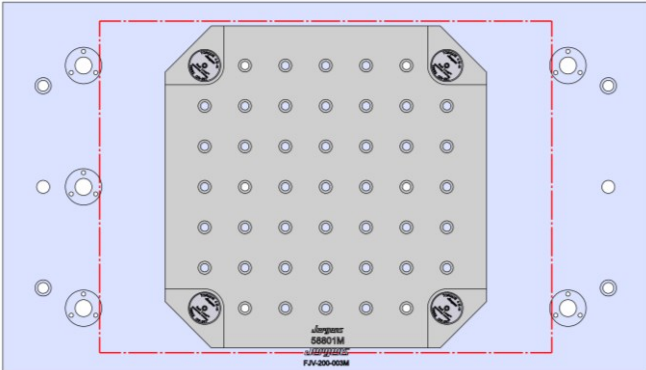

58801 Steel



**Mazak** FJV-200

FJV200-004M

800 X 460 X 28 MM

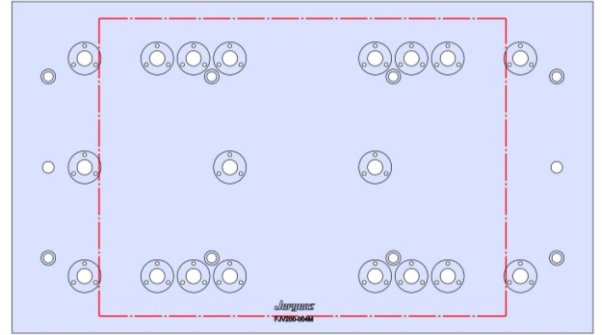
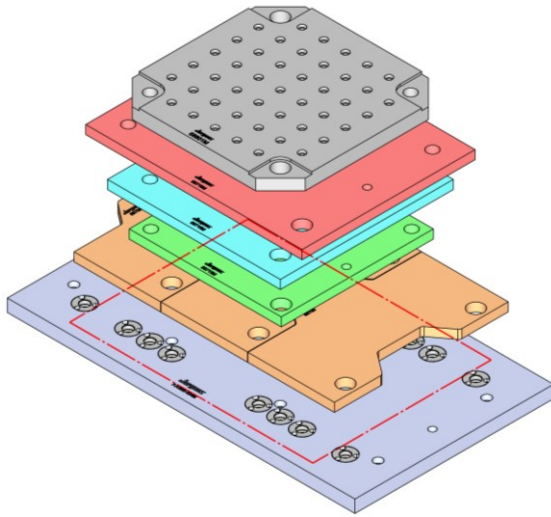

FJV200-004M

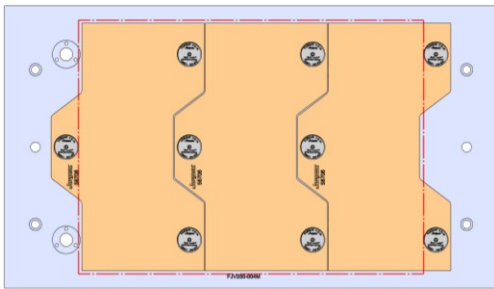

58706 Aluminum

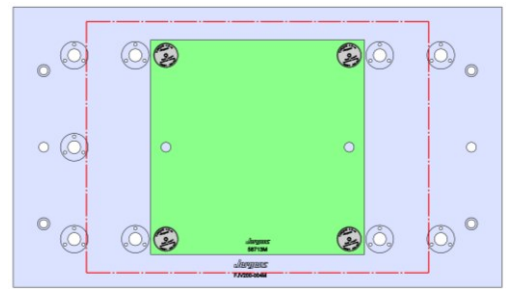

58806 Steel

58713 Aluminum

58813 Steel

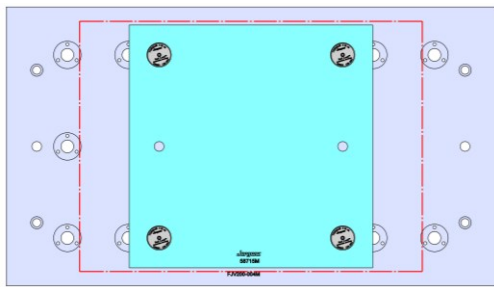

58715 Aluminum

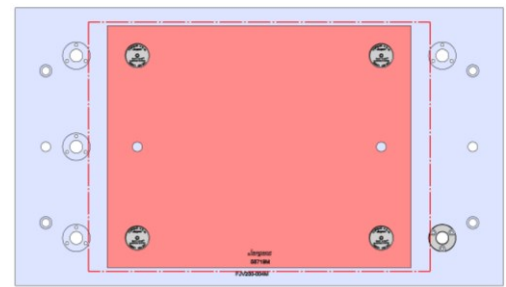

58815 Steel

58719 Aluminum

Steel Available upon request

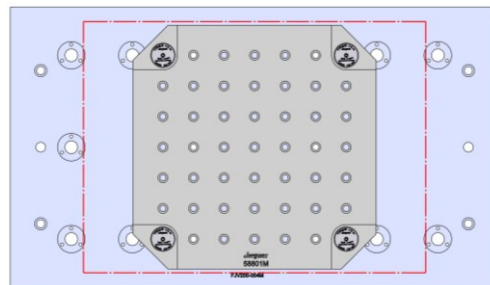

58801 Steel



Mazak FJV-200

FJV200-005M

800 X 460 X 28 MM

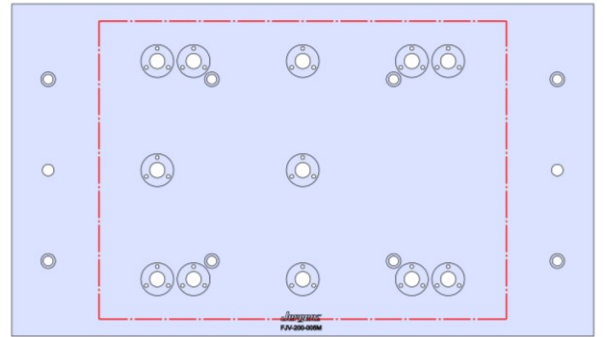
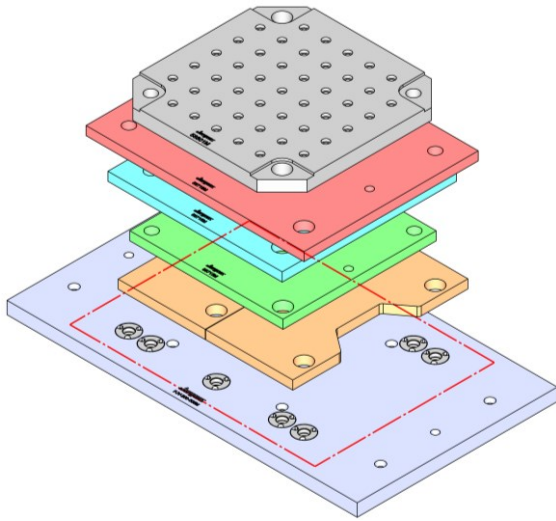

FJV200-005M

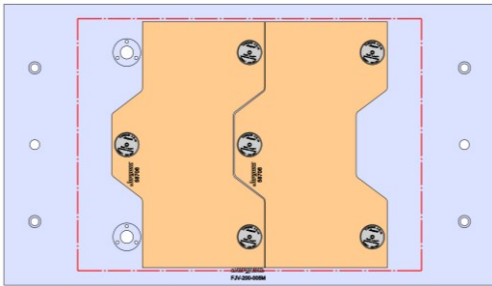

58706 Aluminum

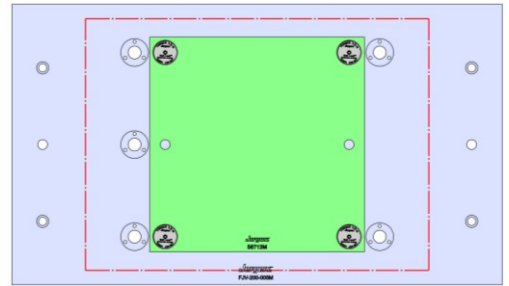

58806 Steel

58713 Aluminum

58813 Steel

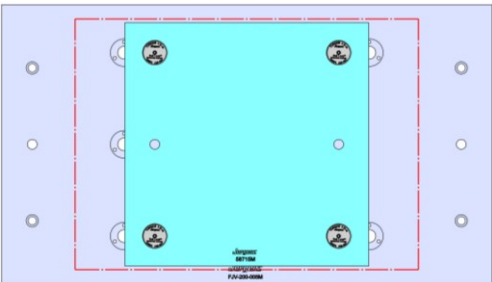

58715 Aluminum

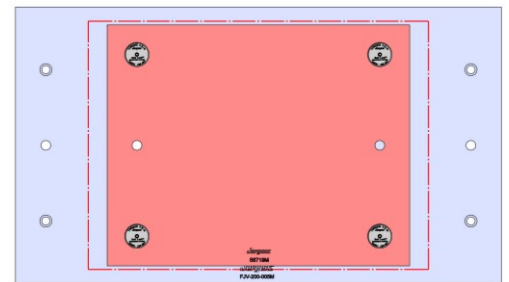

58815 Steel

58719 Aluminum

Steel Available upon request

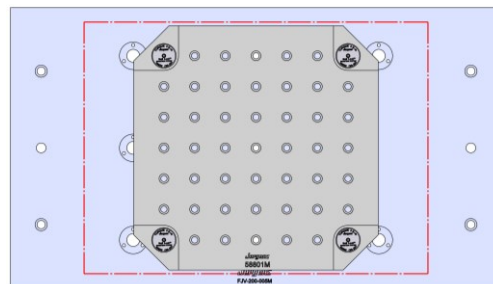

58801 Steel



# FJV-250



## Table Specifications

- Table Travel (X, Y, Z): 1020 X 510 X 460mm
- Table Dimensions (L x W): 1200 X 550mm
- Maximum Weight on Table: 1198 Kgf
- T-Slot Width: .709" (18mm)
- T-Slot Center Distance: 3.937" (100mm)

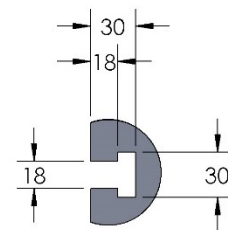
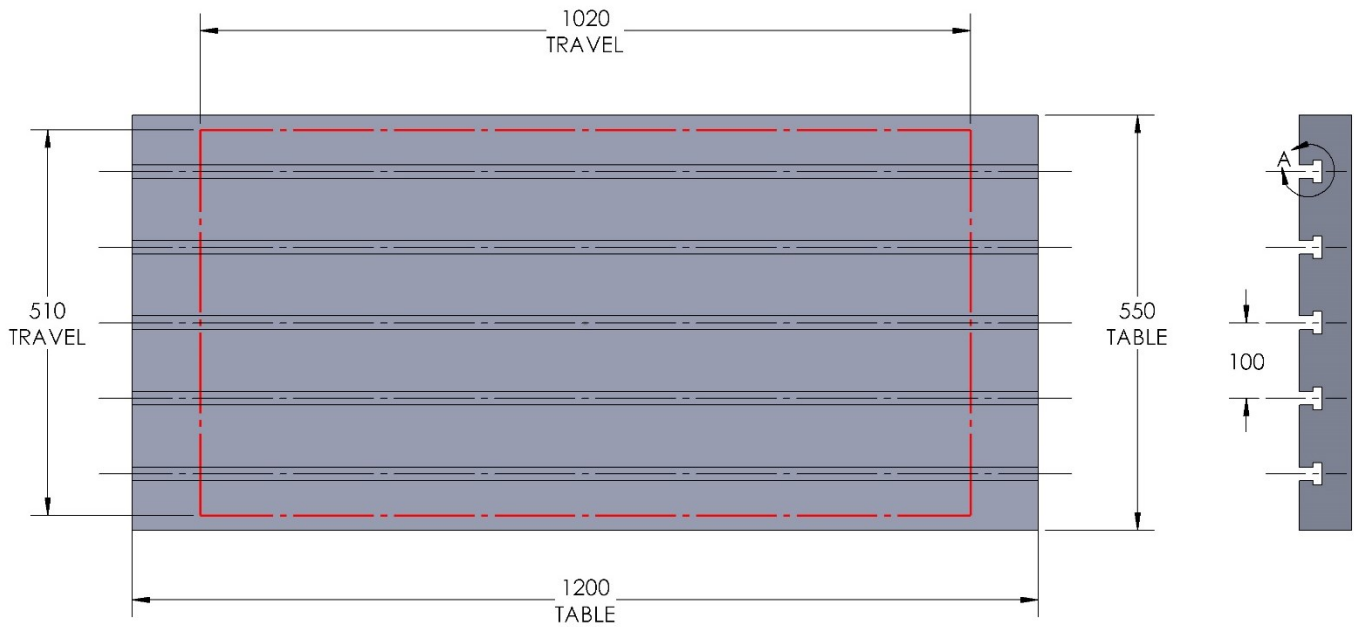

T-SLOT  
DETAIL  
A



FJV250-001M

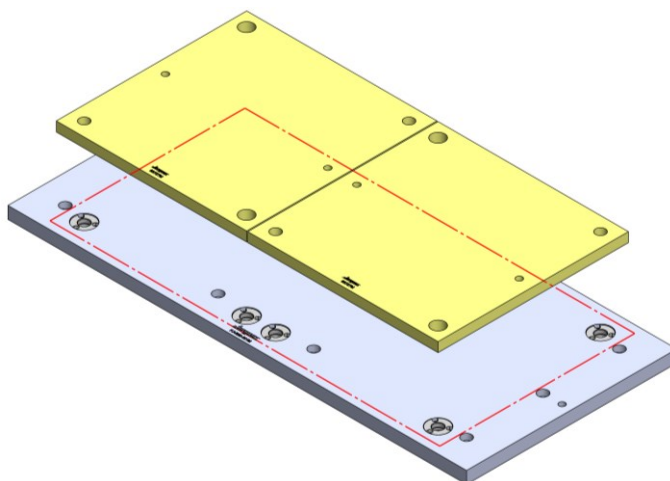

1200 X 550 X 32 MM

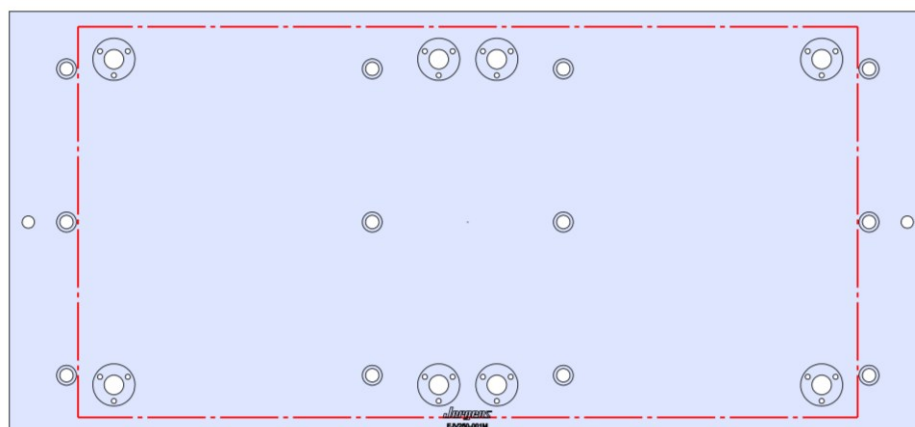

FJV250-001M

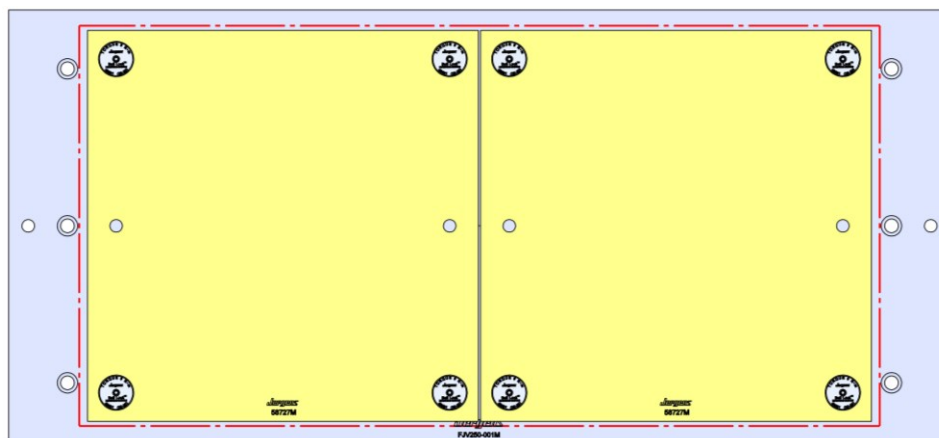

58727 Aluminum

58827 Steel



FJV250-002M

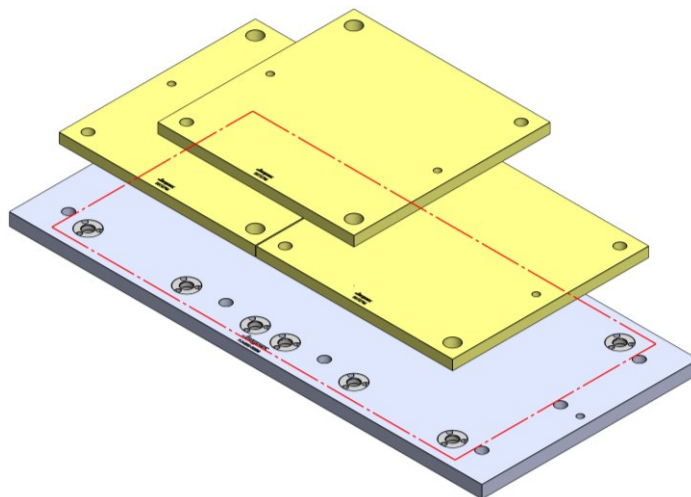

1200 X 550 X 32 MM

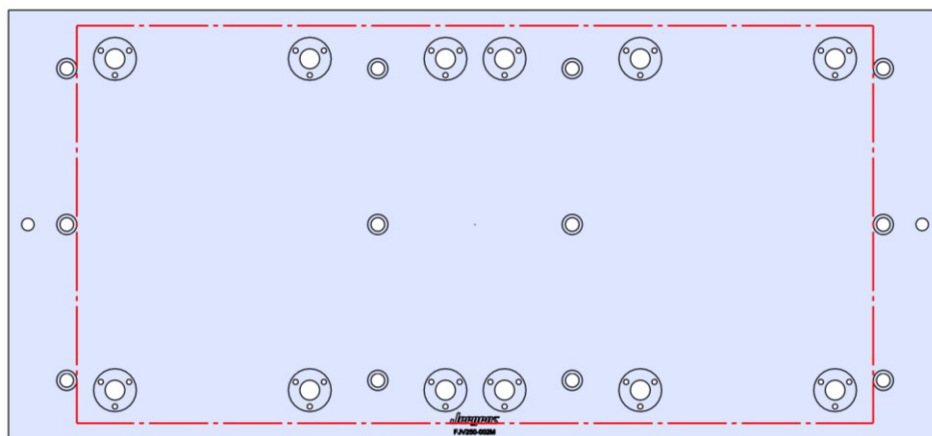

FJV250-002M

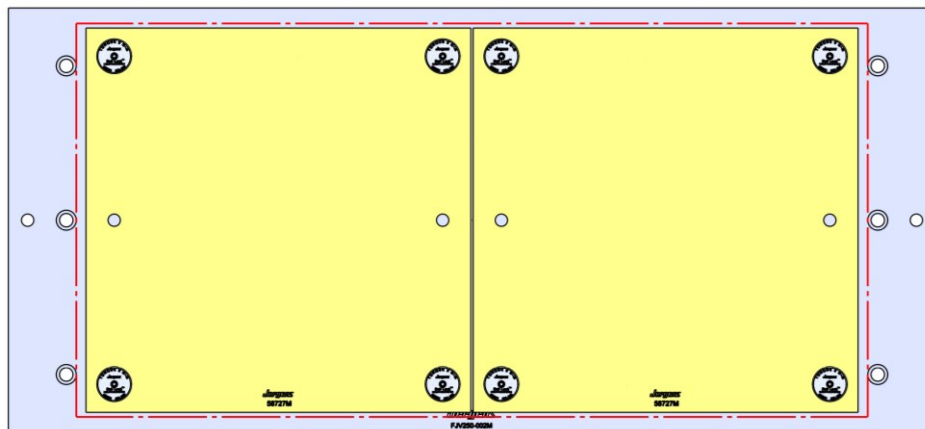

58727 Aluminum

58827 Steel



# FJV250-003M

**Mazak** FJV-250

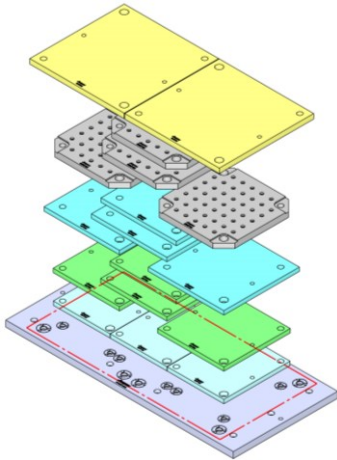

1200 X 550 X 32 MM

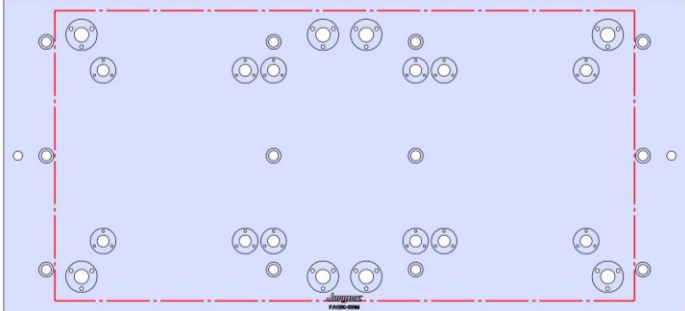

## FJV250-003M

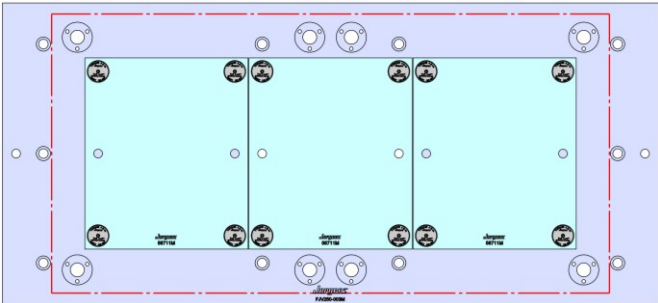

58711 Aluminum Steel Available upon request

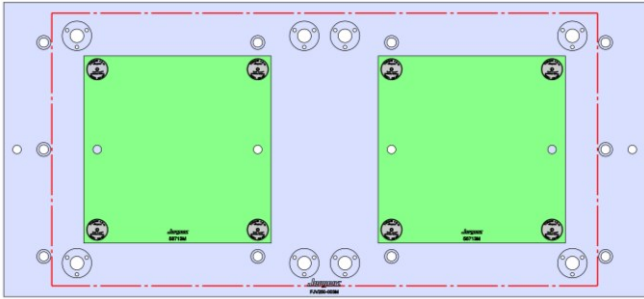

58713 Aluminum 58813 Steel

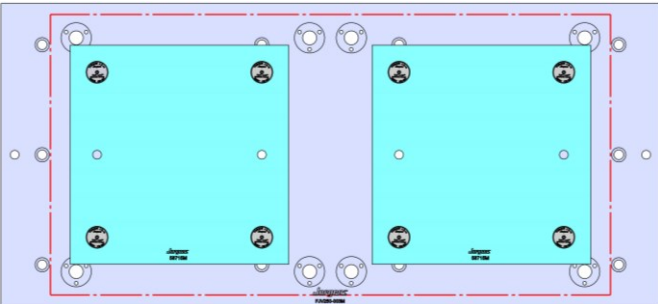

58715 Aluminum 58815 Steel

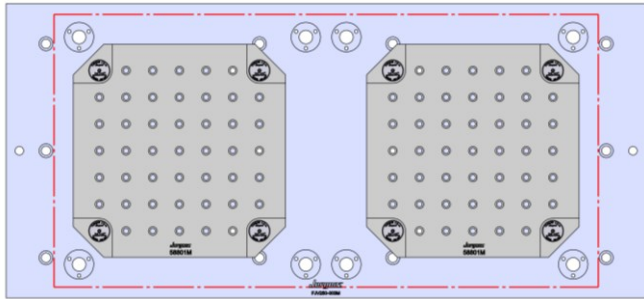

58801 Steel

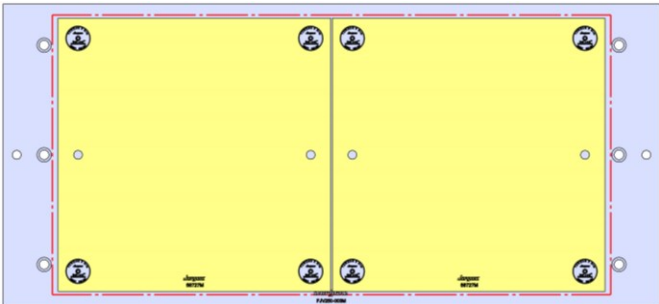

58727 Aluminum 58827 Steel



Mazak FJV-250



FJV250-004M

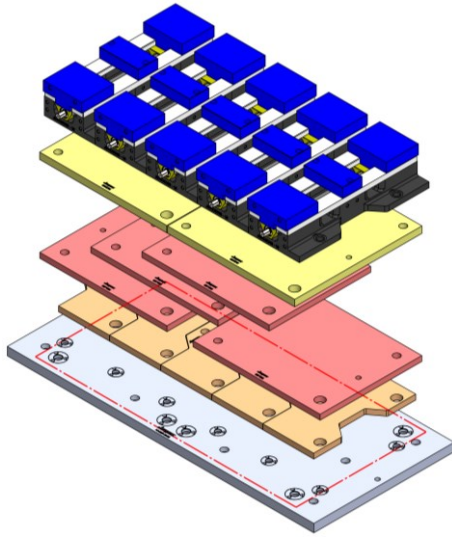

1200 X 550 X 32 MM

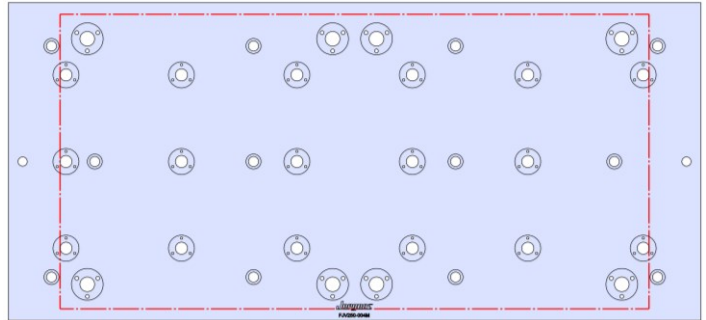

FJV250-004M

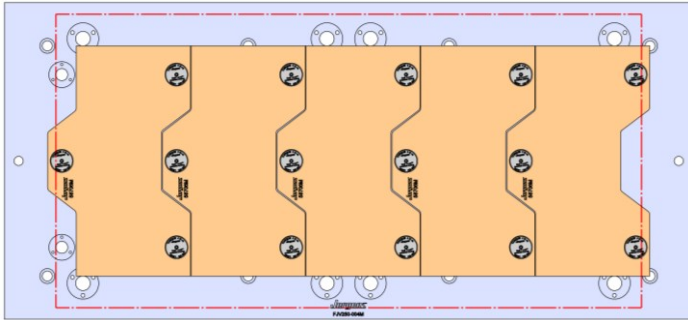

58706 Aluminum

58806 Steel

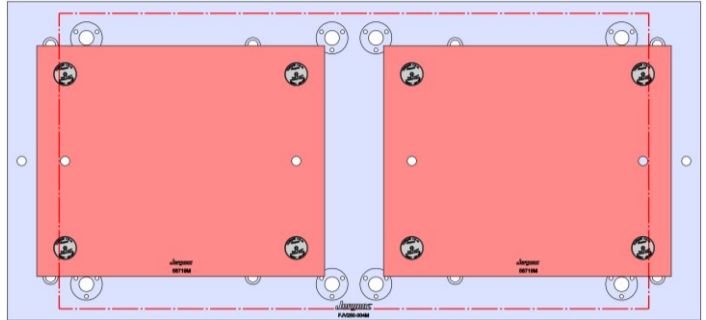

58719 Aluminum

Steel Available upon request

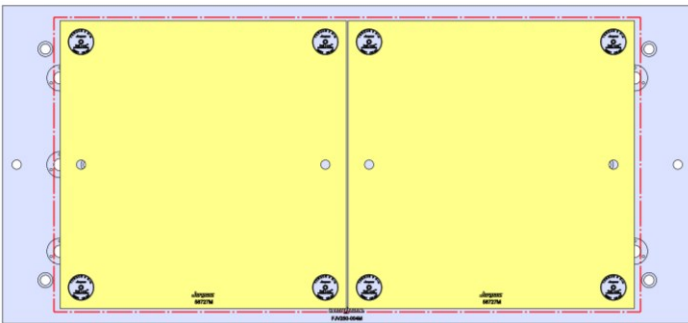

58727 Aluminum

58827 Steel

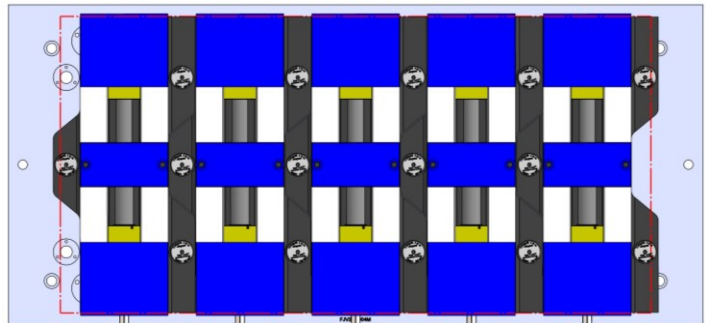

69406 150MM Vise Ball-Lock® Base



Mazak FJV-250



FJV250-005M

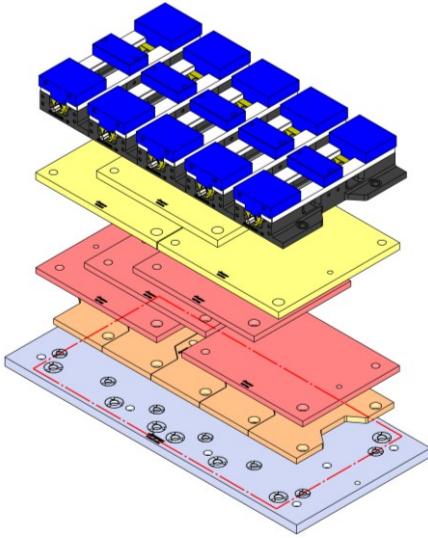

1200 X 550 X 32 MM

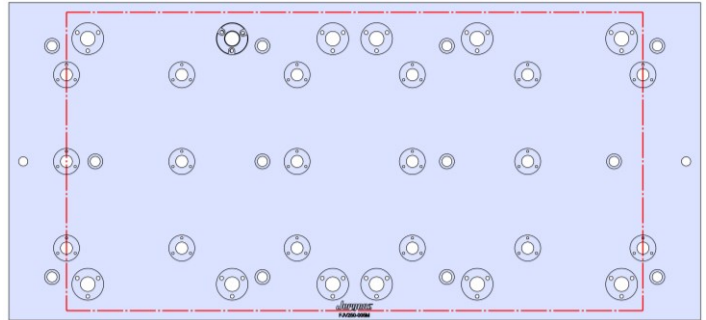

FJV250-005M

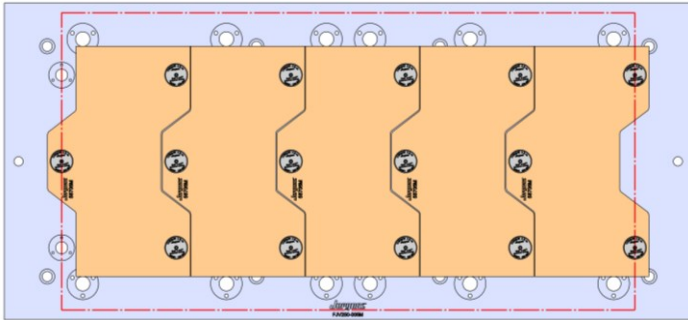

58706 Aluminum

58806 Steel

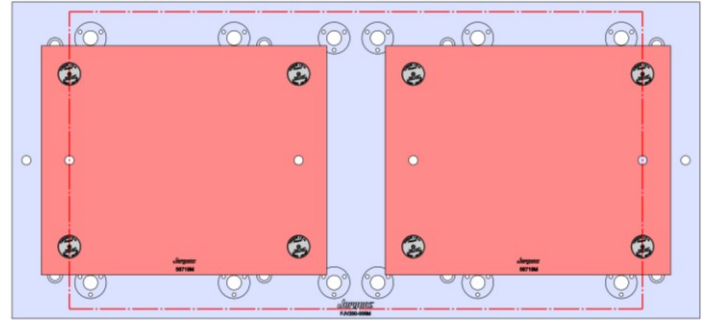

58719 Aluminum

Steel Available upon request

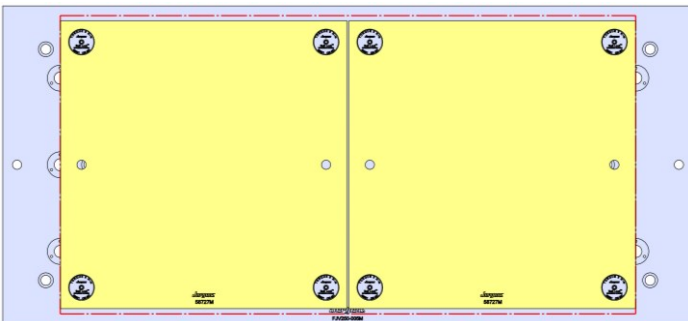

58727 Aluminum

58827 Steel

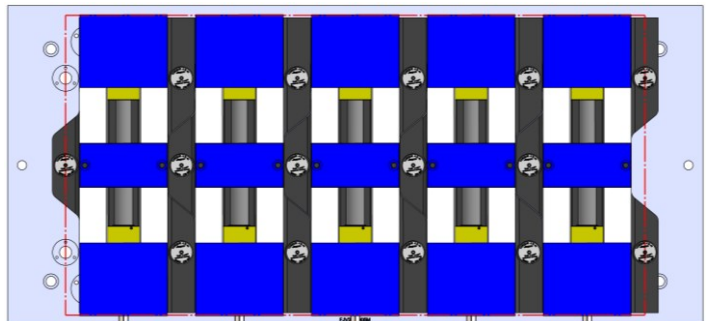

69406 150MM Vise Ball-Lock® Base



# FJV250-006M

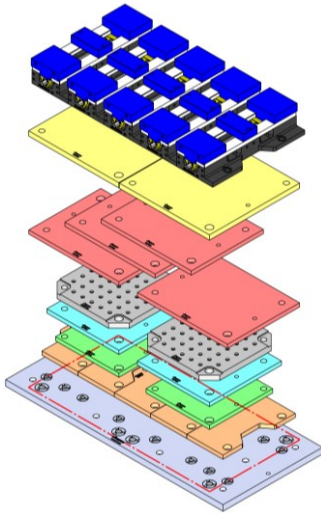

1200 X 550 X 32 MM

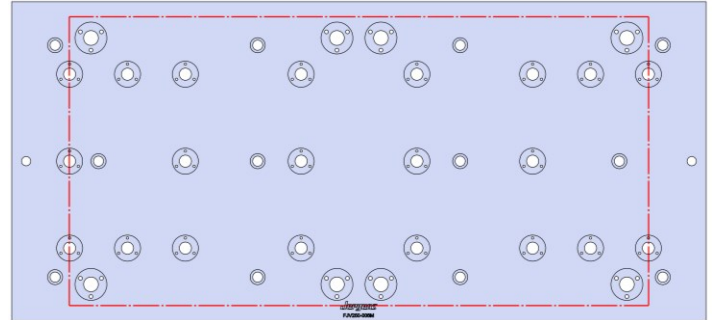

## FJV250-006M

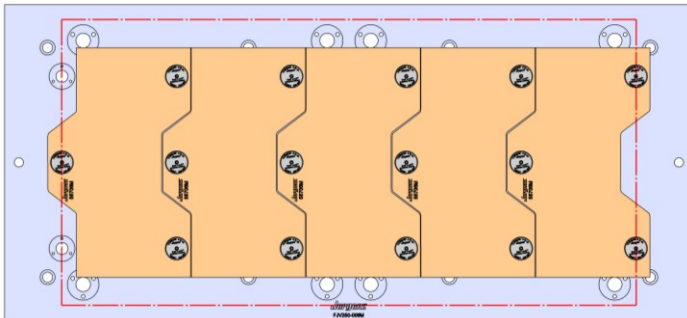

58706 Aluminum

58806 Steel

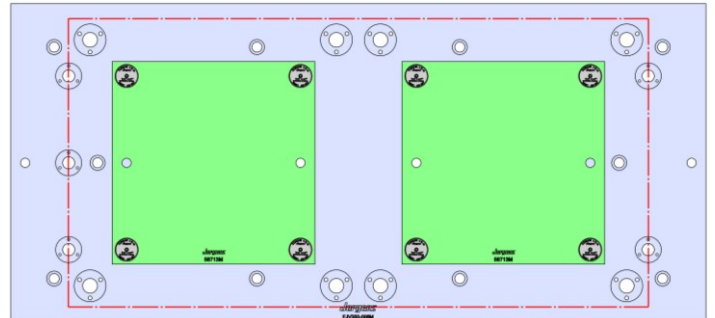

58713 Aluminum

58813 Steel

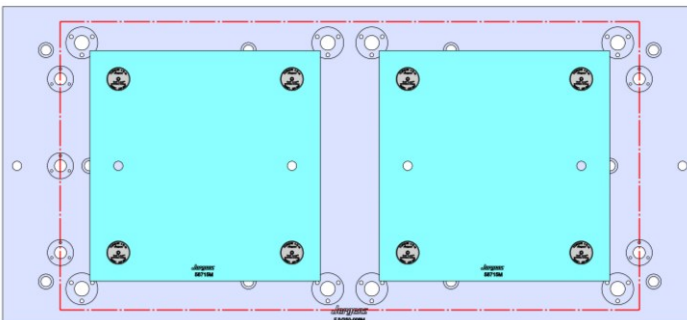

58715 Aluminum

58815 Steel

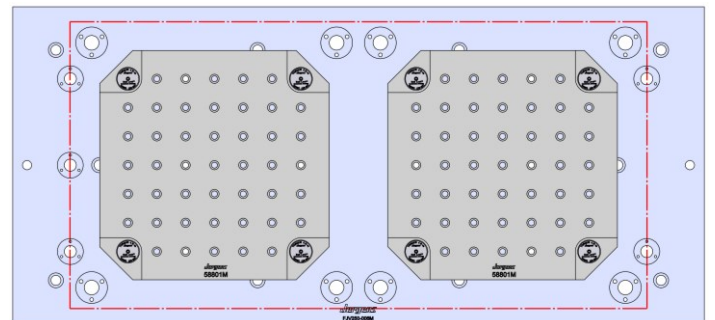

58801 Steel



Mazak FJV-250



# FJV250-006M (CONTINUED)

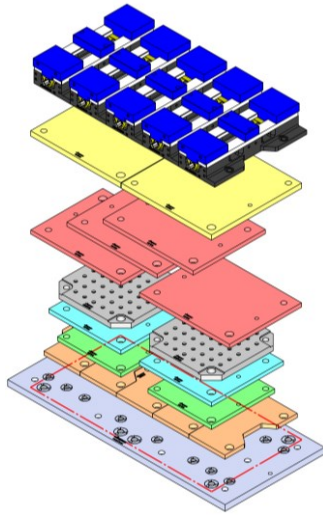

1200 X 550 X 32 MM

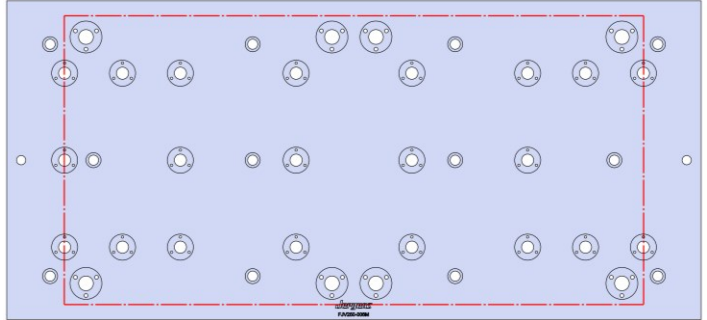

FJV250-006M

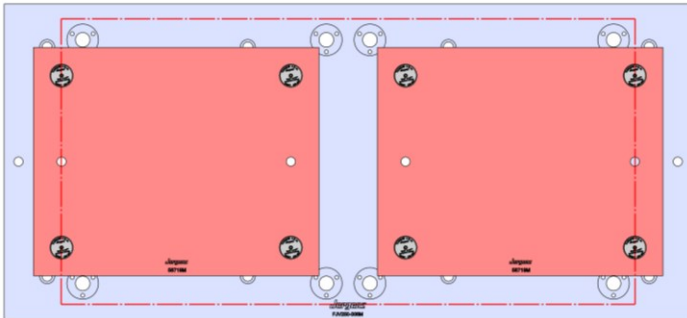

58719 Aluminum

Steel Available upon request

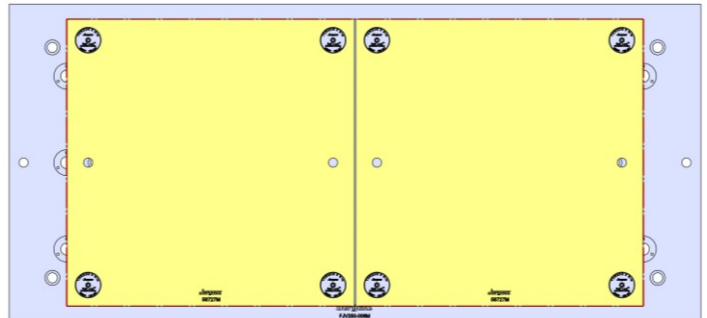

58727 Aluminum

58827 Steel

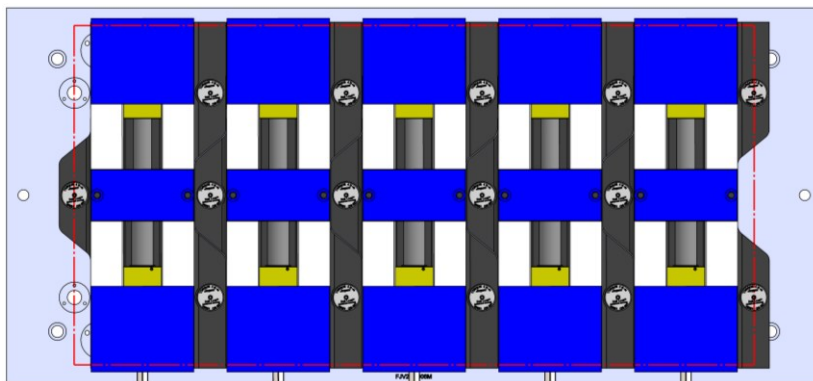

69406 150MM Vise Ball-Lock® Base



Mazak FJV-250



FJV250-007M

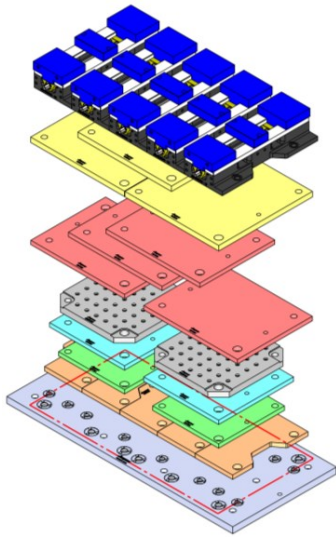

1200 X 550 X 32 MM

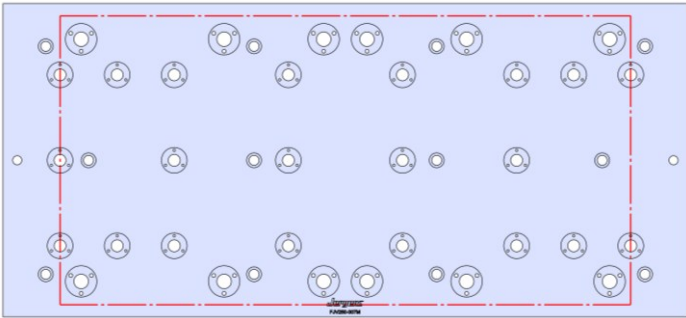

FJV250-007M

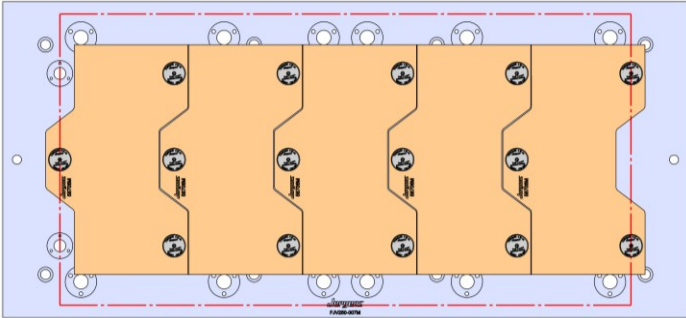

58706 Aluminum

58806 Steel

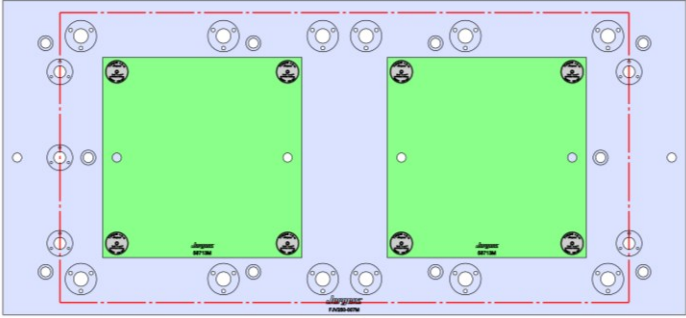

58713 Aluminum

58813 Steel

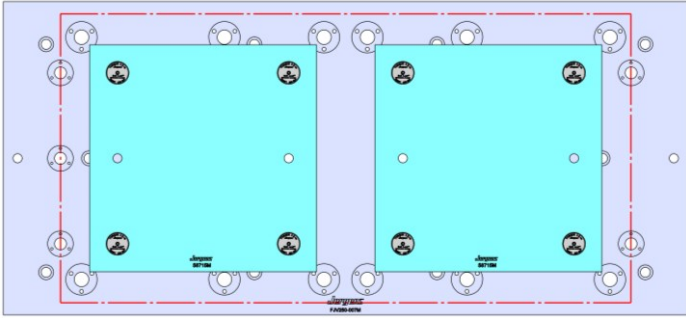

58715 Aluminum

58815 Steel

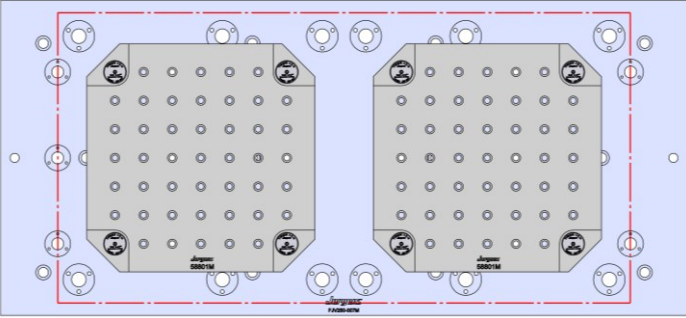

58801 Steel



# FJV250-007M (CONTINUED)

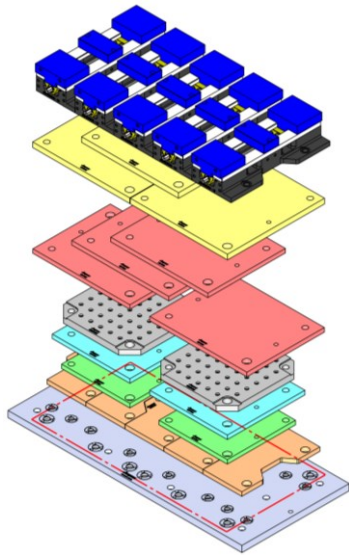

1200 X 550 X 32 MM

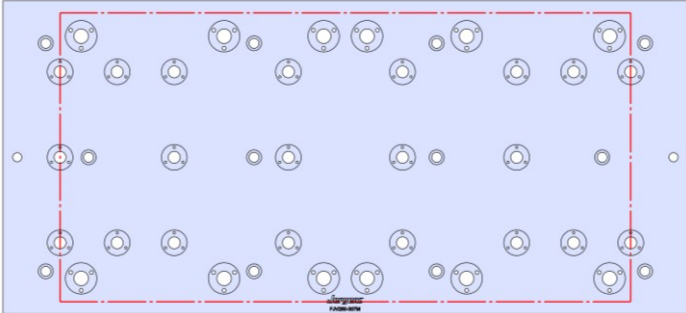

FJV250-007M

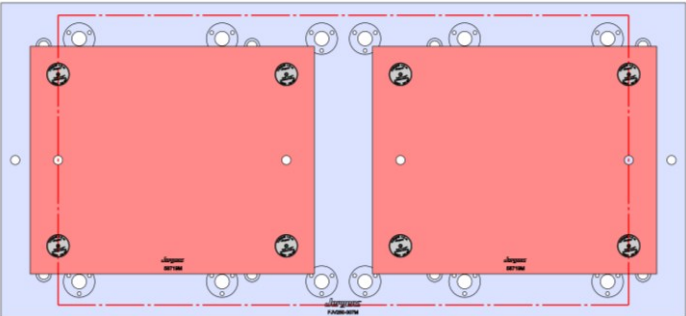

58719 Aluminum

Steel Available upon request

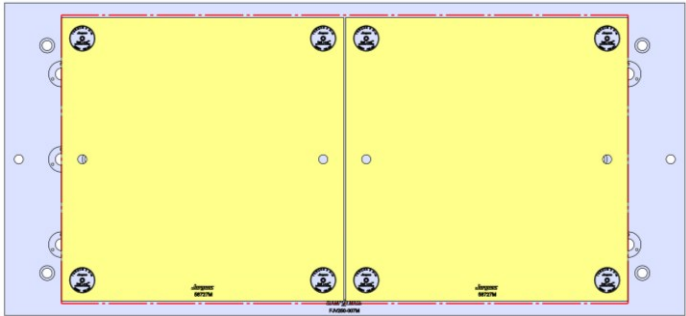

58727 Aluminum

58827 Steel

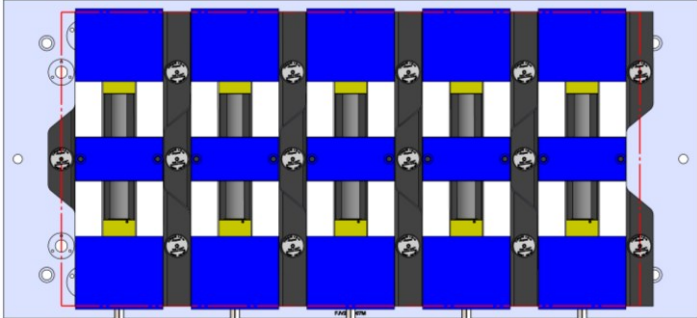

69406 150MM Vise Ball-Lock® Base



FJV250-008M

Mazak FJV-250



1200 X 550 X 32 MM

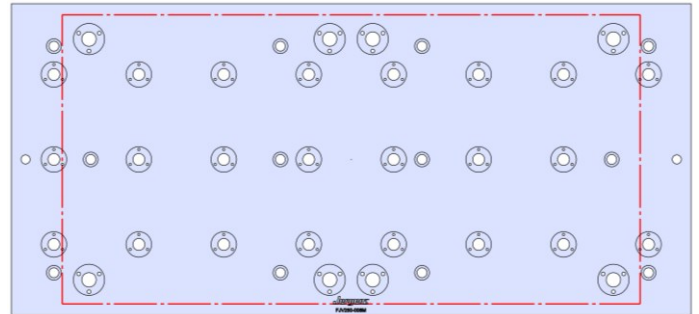
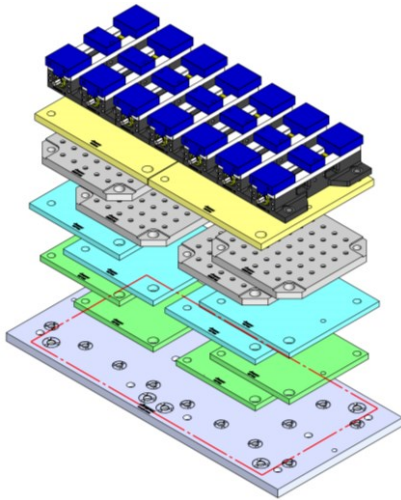

FJV250-008M

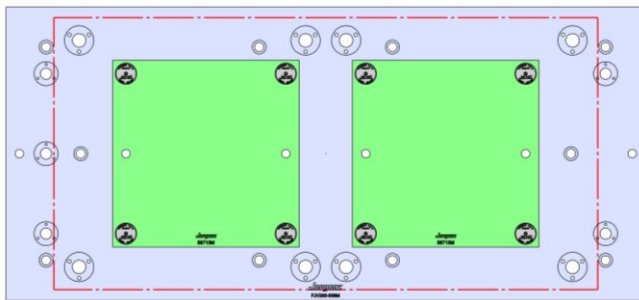

58713 Aluminum

58813 Steel

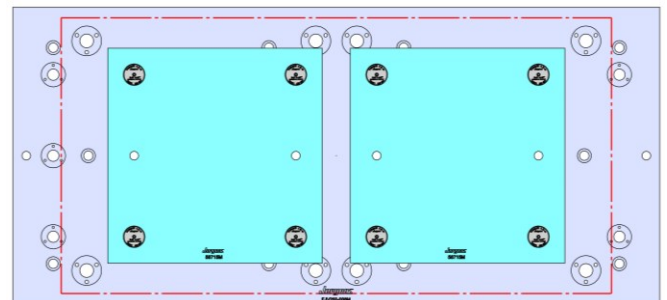

58715 Aluminum

58815 Steel

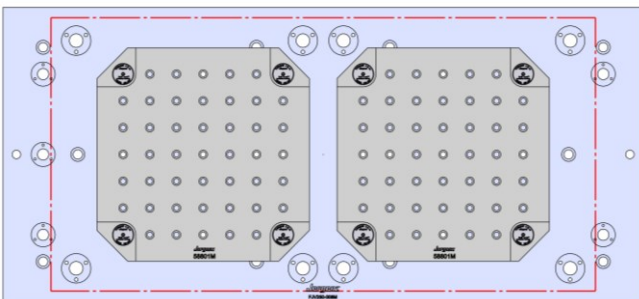

58801 Steel

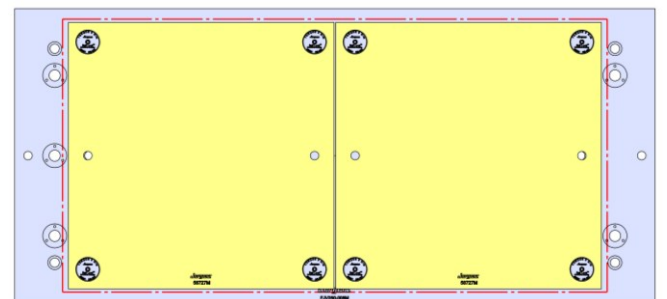

58727 Aluminum

58827 Steel

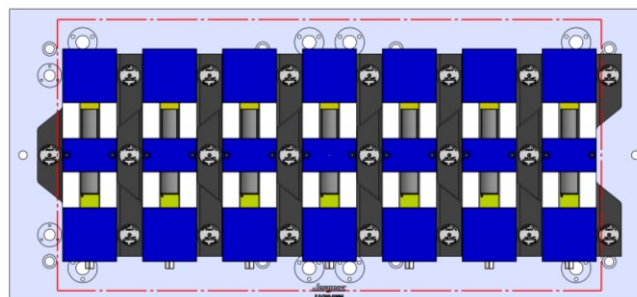

69405 100MM Vise Ball-Lock® Base



FJV250-009M

Mazak FJV-250

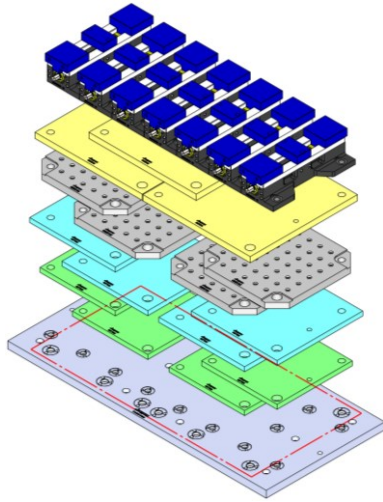

1200 X 550 X 32 MM

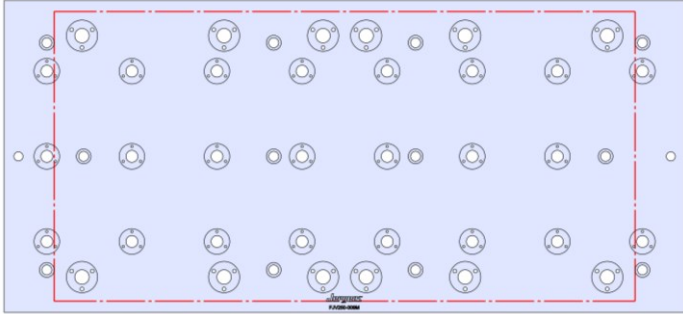

FJV250-009M

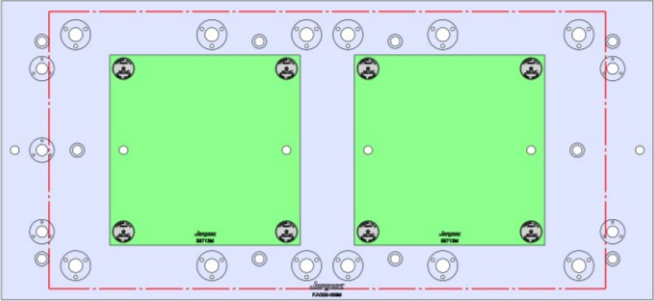

58713 Aluminum

58813 Steel

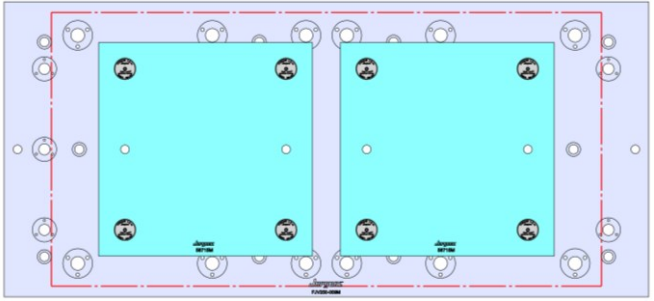

58715 Aluminum

58815 Steel

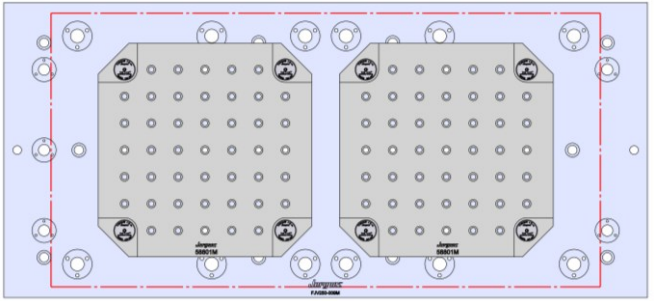

58801 Steel

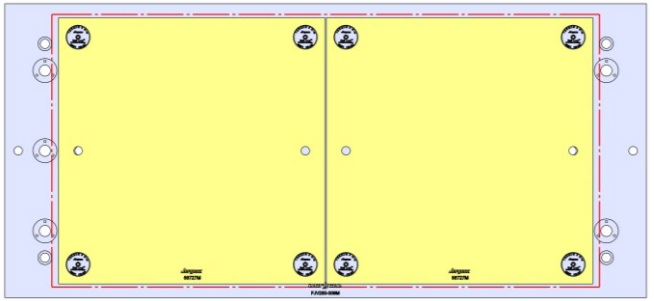

58727 Aluminum

58827 Steel

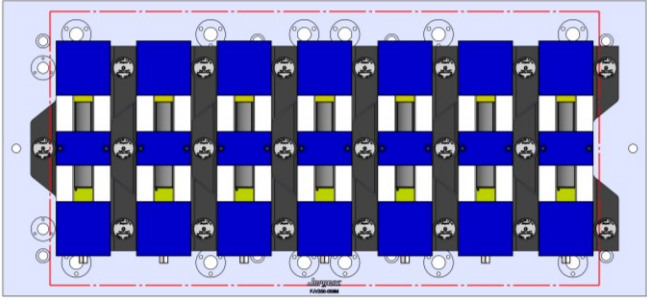

69405 100MM Vise Ball-Lock® Base



		<b>Subplate &amp; Mounting Hardware Components required per Subplate</b>					
SUBPLATE P/N	QTY	T-NUT P/N	QTY	SINE-KEY P/N	QTY	SHCS	QTY
VCN410A-001M		43378	10	39527	2	771694	10
VCN410A-002M		43378	10	39527	2	771694	10
VCN410A-003M		43378	10	39527	2	771694	10
VCN410A-004M		43378	10	39527	2	771694	10
VCN410A-005M		43378	8	39527	2	771694	8
VCN410B-001M		43378	10	39527	2	770182	10
VCN410B-002M		43378	10	39527	2	770182	10
VCN410B-003M		43378	10	39527	2	770182	10
VCN410B-004M		43378	10	39527	2	770182	10
VCN410B-005M		43378	10	39527	2	770182	10
VCN410B-006M		43378	10	39527	2	770182	10
VCN410B-007M		43378	10	39527	2	770182	10
VCN410B-008M		43378	12	39527	2	770182	12
VCN410B-009M		43378	12	39527	2	770182	12
VCN410B-010M		43378	12	39527	2	770182	12
VCN510C-001M		43378	16	39527	2	770182	16
VCN510C-002M		43378	16	39527	2	770182	16
VCN510C-003M		43378	16	39527	2	770182	16
VCN510C-004M		43378	16	39527	2	770182	16
VCN510C-005M		43378	16	39527	2	770182	16
VCN510C-006M		43378	17	39527	2	770182	17
VCN510C-007M		43378	17	39527	2	770182	17
VCN510C-008M		43378	17	39527	2	770182	17
VCN510C-009M		43378	17	39527	2	770182	17
VCN510C-010M		43378	17	39527	2	770182	17
VCN510C-011M		43378	17	39527	2	770182	17
FJV200-001M		43378	8	39527	2	771694	8
FJV200-002M		43378	8	39527	2	771694	8
FJV200-003M		43378	8	39527	2	771694	8
FJV200-004M		43378	8	39527	2	771694	8
FJV200-005M		43378	8	39527	2	771694	8
FJV250-001M		43378	12	39527	2	770182	12
FJV250-002M		43378	12	39527	2	770182	12
FJV250-003M		43378	12	39527	2	770182	12
FJV250-004M		43378	12	39527	2	770182	12
FJV250-005M		43378	12	39527	2	770182	12
FJV250-006M		43378	12	39527	2	770182	12
FJV250-007M		43378	12	39527	2	770182	12
FJV250-008M		43378	12	39527	2	770182	12
FJV250-009M		43378	12	39527	2	770182	12



## FIXTURE PLATES SHANKS AND VISES

FIXTURE PLATE ALUMINUM PART NO	ORDER QTY	FIXTURE PLATE STEEL PART NO	ORDER QTY	BALL-LOCK SHANKS PART NO	QTY OF SHANKS REQUIRED PER FIXTURE PLATE	ORDER QTY
		58801		49652	4	
58706		58806		49651	3	
58711		Steel Available upon request		49651	4	
58713		58813		49651	4	
58715		58815		49651	4	
58719		Steel Available upon request		49651	4	
58727		58827		49662	4	
Aluminum Available upon request		58845		49662	4	

BALL-LOCK BASE VISE 100mm	ORDER QTY	BALL-LOCK BASE VISE 150mm	ORDER QTY	BALL-LOCK SHANKS PART NO	QTY OF SHANKS REQUIRED PER FIXTURE PLATE	ORDER QTY
69405		69406		49651	3	