

NEW!

Standard Duty Detent Pins

Ideal for basic holding and removal applications that don't require a positive locking ball feature.

- ✓ Body (Shank) is CRES 303 Stainless with CRES 316 stainless spring & ball
- ✓ Pins are activated by push or pull motion
- ✓ Includes split ring for attachment of optional general purpose lanyard
- ✓ Optional materials, sizes, and styles available

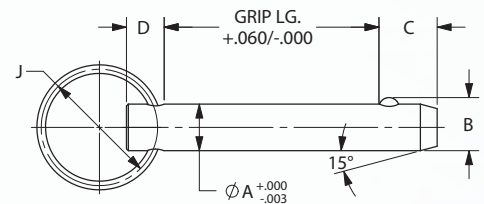

See lanyard diagrams & information on reverse side.

STANDARD DUTY DETENT SPECIFICATIONS - INCH

Nom. Pin Dia.	Dia. +0.000/-0.003					Double Shear Strength (lbs)	Pull Out Force (lbs)	Recommended Hole Diameter	
	A	B	C	D	J			Max.	Min.
3/16	.1875	.204	.200	.187	1.00	2,530	4 - 6	.1930	.1890
1/4	.2500	.286	.312	.220	1.00	4,500	5 - 7	.2555	.2515
5/16	.3125	.358	.375	.250	1.00	7,100	5 - 7	.3180	.3140
3/8	.3750	.426	.500	.250	1.00	10,300	7 - 10	.3805	.3765
1/2	.5000	.486	.625	.250	1.25	18,400	10 - 14	.5065	.5015
5/8	.6250	.710	.750	.375	1.25	28,900	23 - 26	.6315	.6265
3/4	.7500	.856	.937	.375	1.50	41,800	24 - 27	.7585	.7515
1	1.000	1.140	1.250	.500	1.50	74,600	30 - 33	1.0115	1.0015

STANDARD DUTY DETENT PINS - INCH

Pin Dia.	Grip length (inches)										
	0.5	1	1.5	2	2.5	3	3.5	4	4.5	5	6
3/16	804000	804001	804002	804003	804004	804005					
1/4	804011	804012	804013	804014	804015	804016					
5/16	804022	804023	804024	804025	804026	804027	804028	804029	804030		
3/8		804034	804035	804036	804037	804038	804039	804040	804041	804042	
1/2		804045	804046	804047	804048	804049	804050	804051	804052	804053	
5/8		804056	804057	804058	804059	804060	804061	804062	804063	804064	
3/4		804067	804068	804069	804070	804071	804072	804073	804074	804075	804076
1			804080	804081	804082	804083	804084	804085	804086	804087	

Continued other side ▶

General Purpose Lanyard Specifications & Styles

(Available on Standard Duty Detent Pins only)

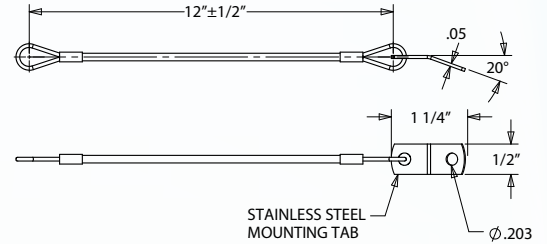

- 300 Series Stainless Steel cable, 1/16" (1.59 mm), with clear nylon jacket, 1/8" (3.18 mm)
- 1/16", 7 x 7 construction, clear nylon jacket, 1/8" light duty
- Other cable diameters, other jacket colors (blue, black, clear) and special configuration styles by special order.

Ordering Lanyards Attached to Pins (Attached to Split Ring)

Standard cone loop with rectangular tab

Part Numbering: Specify the six digit standard detent pin number followed by the 3 digit suffix (i.e. 804014L12 - 1/4" x 2" pin with 12" lanyard attached to ring).

Ordering Lanyards Attached (Specify)

Length	Rect Stainless Steel
6"	XXXXXX - L06
12"	XXXXXX - L12

Note: .203" mounting hole

Ordering Lanyards When Supplied Separately Without Pins

Part Numbering: Specify the six digit number below for the 6" or 12" lanyard.

Ordering Lanyards Separately

Length	Rect Stainless Steel
6"	890340
12"	890341

Note: .203" mounting hole

WORLD HEADQUARTERS

15700 S. Waterloo Road. Cleveland, OH 44110-3898

☎ 800.537.4367 📠 216.481.6193

✉ info@jergensinc.com

🌐 www.jergensinc.com

AD0313

© Copyright Jergens, Inc. 2013